



View the night sky and more on the big dome screen
(27 meters in diameter.)

An astronomy educator explains 'Sky Tonight' and 'Topics of Astronomy.'
In addition 'Full Dome Movies' of varying genre are available
for your viewing pleasure.

Planetarium Schedule

	9:45	11:00	12:45	13:50	14:55	16:00
Open weekdays	Group Programs	Planetarium show	Group Programs	Full Dome Movies	Planetarium show	Full Dome Movies
School holidays			Full Dome Movies	Planetarium show	Full Dome Movies	Planetarium show
Sunday	Full Dome Movies		Full Dome Movies	Planetarium show	Full Dome Movies	Planetarium show

- *Planetarium show: An astronomy educator explains "Sky Tonight" and "Topics of Astronomy."
- *Full dome Movies: 'Full Dome Movies' of varying genre are available for your viewing pleasure.
- *Group Programs: Program is reserved by group.
(General public will be admitted if seats are available)
- *Each show is about 45 minutes long.
- *Once the show begins people are not allowed to enter or exit.
- *Time table may be changed if a special event is held.

Entrance Hall Features



- *A big hot-air balloon, Foucault's pendulum, and huge fossils
- *Participate in a science experiment where you can get some simple hands on experience **
- *An exhibition room where special exhibits are held**
- *Cafe and Museum shop **
- **The times and dates are limited.

Visitor Information

Opening Hours

9:30am-5:00pm. Admission ends at 4:30pm.

Closed

- *Tuesdays (Tuesdays that fall on holidays will be open)
- *The day following a national holiday (except Sat., Sun. and holidays)
- *December 27 to January 3

*Scheduled maintenance ; please refer to our homepage

Admission

	Exhibition hall	Planetarium
Adults	600yen	600yen
Students from 1st to 12th grade	210yen	210yen

- *Free for children before Elementary school
(This policy does not apply to children in groups)
- *20% off for parties of 20 visitors or more
- *"Donguri card" holders are admitted to the museum exhibition hall free of charge.

Directions:

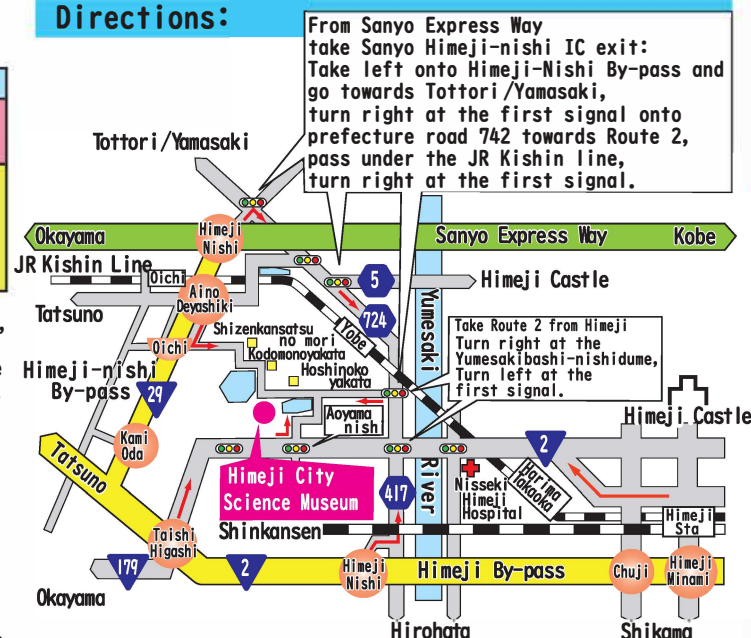

- by car: About 10 minutes from Himeji By-pass Himeji-nishi exit or Sanyo Express Way Himeji-nishi IC exit. Free parking is available.
- by bus: From the bus terminal at the north exit of JR Himeji station, take Shinkai-bus #37 for Oichi to "Hoshinokoyakata-mae". Takes about 20 minutes.



1470-15 Aoyama, Himeji, Hyogo Prefecture
671-2222, Japan
Tel: 079-2 67-301 fax: 079-267-3959

<https://www.city.himeji.lg.jp/atom/>



Science Exhibitions and Planetarium
Himeji City Science Museum

Himeji City Science Museum

4F Floor of Space

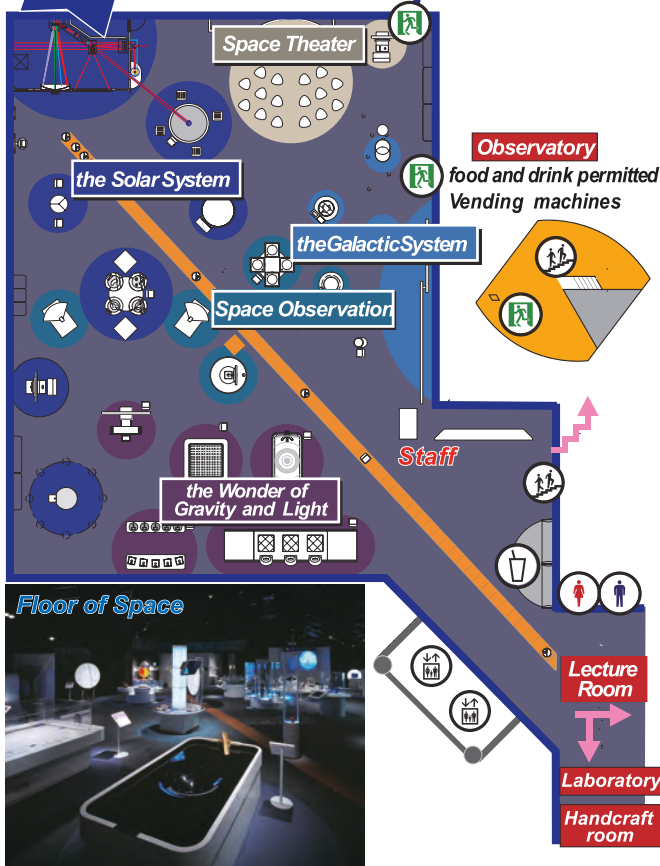

Introduction of the shape and principles of the universe through CG or experiment system. Learn about the latest universe and stars discoveries.



Light Table

On a sunny day, observe the shape of the sun through our 50cm caliber solar telescope. Perform light experiments and guide light on the light table.



Space and Stars lectures

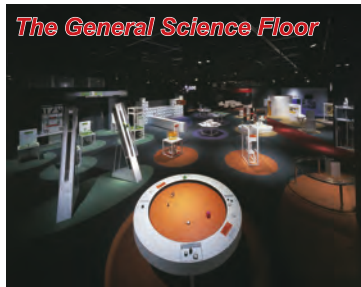

The General Science Floor

Introduction and exploration of natural phenomena using display systems. For example, experience how a little energy can carry a heavy object, or be surprised by how strong wind can be. In the 'Discovery Corner' parents and children can discover the wonders of science as well as watch a Science show (11:10am, 3:15pm daily)

3F General Science



Let's make a tornado

Participate in the redirection of wind currents in an attempt to make a big tornado



Discovery Corner

A ball lifted by wind, mirror blocks



Science Show

2F Earth and Nature

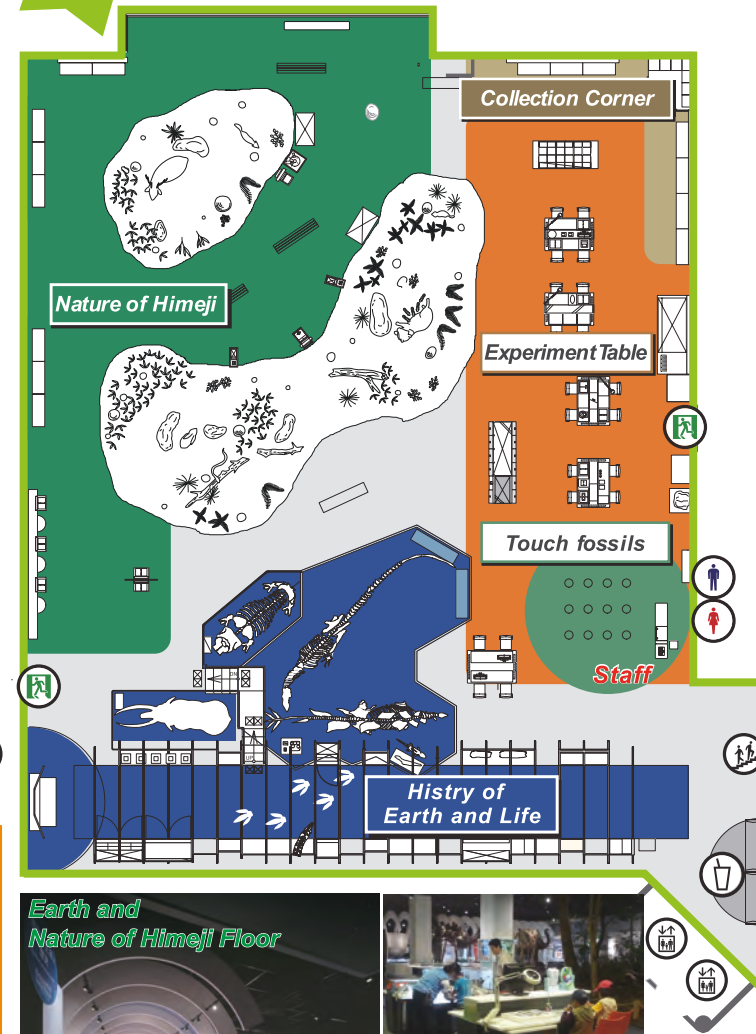

Earth and Nature of Himeji Floor

Trace Earth's History.

The exhibit begins by introducing local flora and fauna, then expands to the history and development of the Earth using specimens and a diorama. Time Tunnel: Trace Earth's History. Collection Corner: Museum's private Natural History Collection. (Exhibits are continuously rotated.)



Experiment Table

Observe fossils, minerals and live specimen



Touch fossils

The times and dates are limited.