

H9-004号

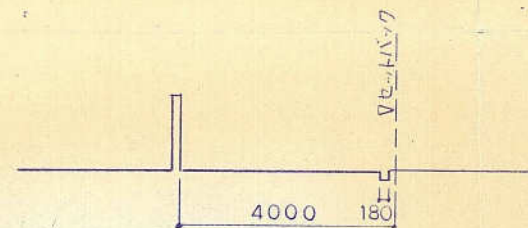
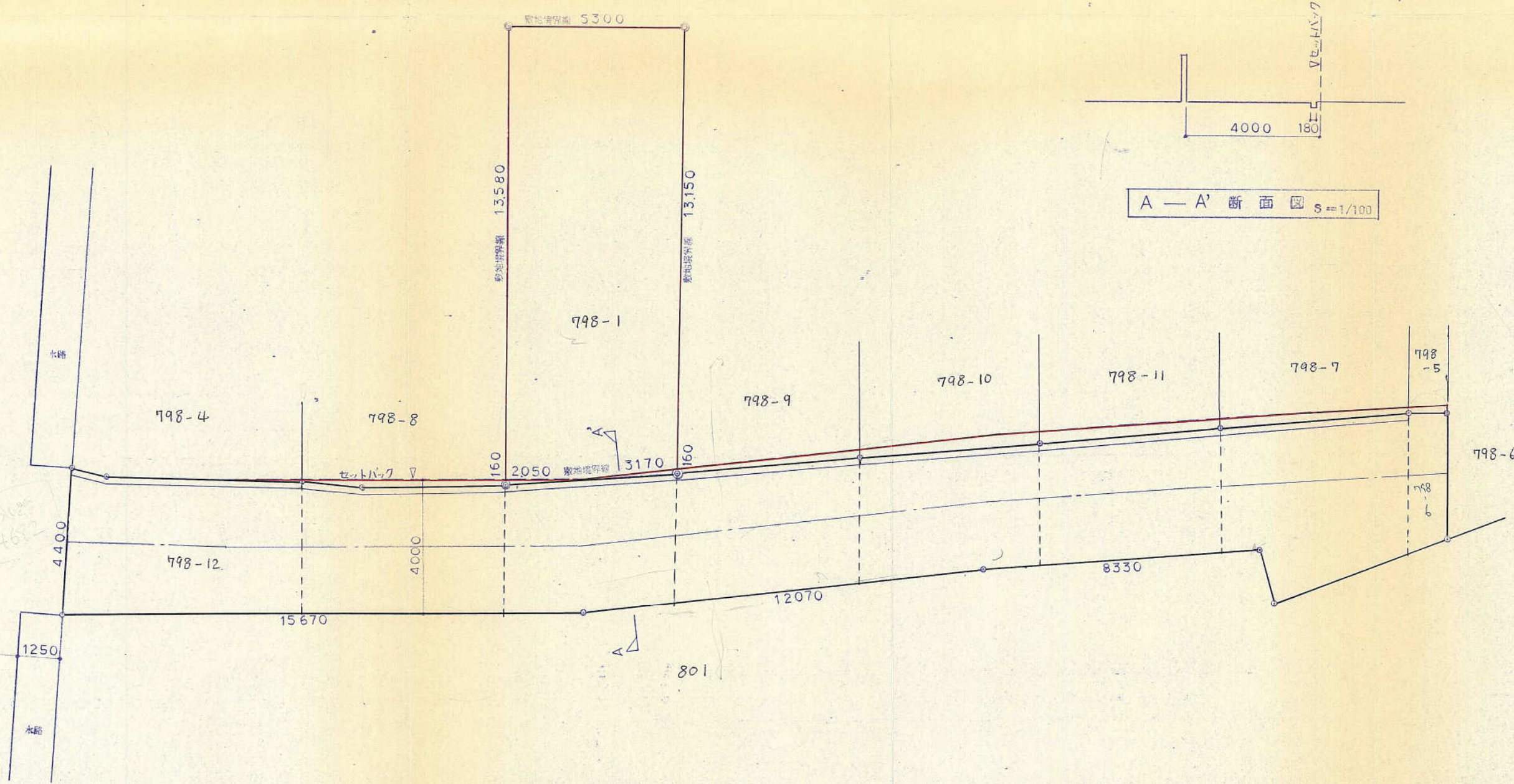

A — A' 断面 ④ s=1/100

4672

801

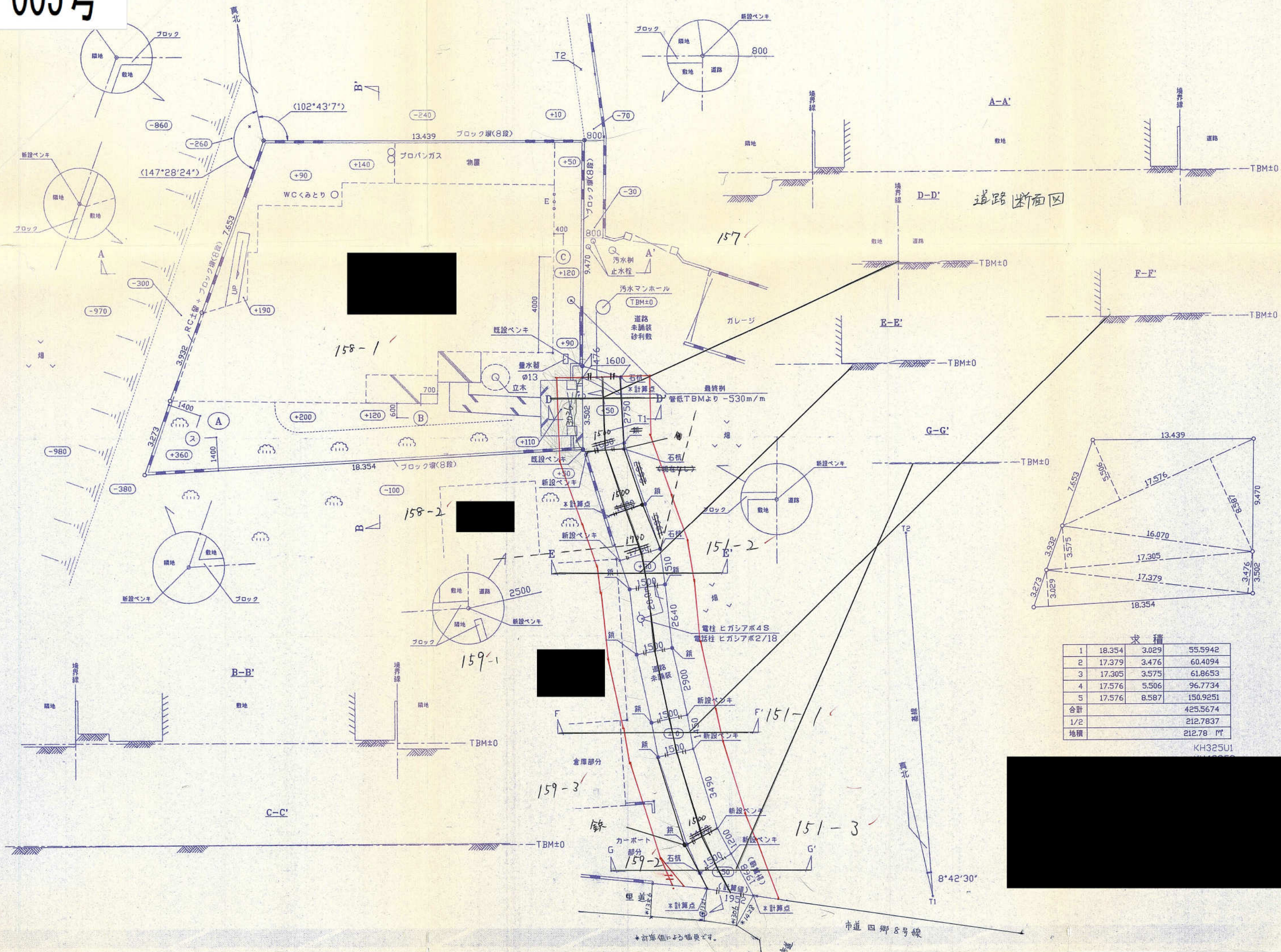

求積

1	18.354	3.029	55.5942
2	17.379	3.476	60.4094
3	17.305	3.575	61.8653
4	17.576	5.506	96.7734
5	17.576	8.587	150.9251
合計			425.5674
1/2			212.7837
地積			212.78 m ²

KH325U1

*計算値による幅員です。

未積友

146-4

右辺 高さ

$$9.15 \times (3.49 + 3.62) \times \frac{1}{2} = 32.52 \text{ m}^2$$

(A)

145-2

左辺 高さ

$$22.03 \times (3.92 + 3.96) \times \frac{1}{2} = 86.79 \text{ m}^2$$

(B)

143-1の部

143-3の部

$$15.07 \times 1.98 = 29.83 \text{ m}^2$$

(C)(D)

$$(A) + (B) + (C) + (D) = 178.7 \text{ m}^2$$

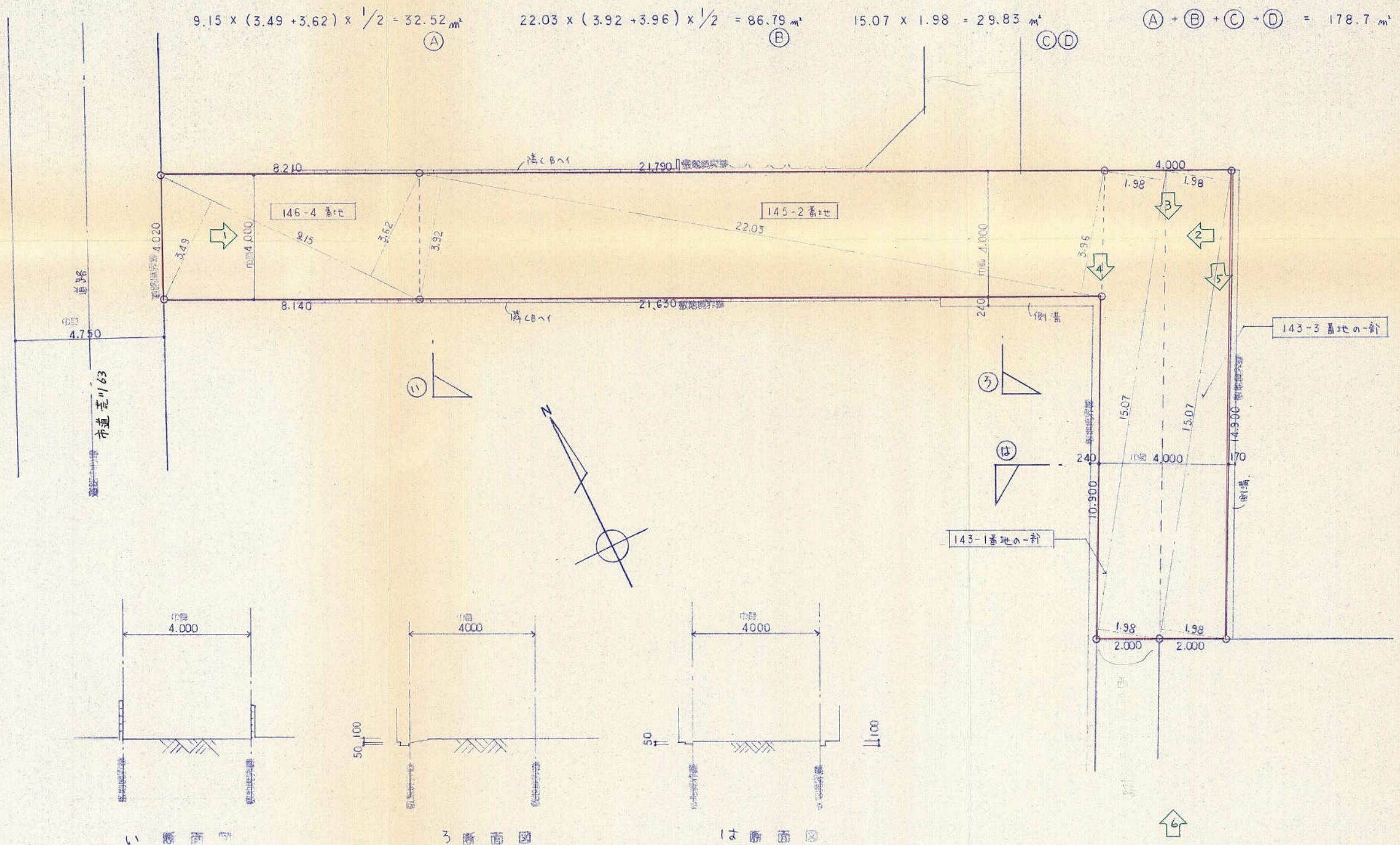

※印内の数字は写真番号を示す
 ※赤線は協定後の境界線とする

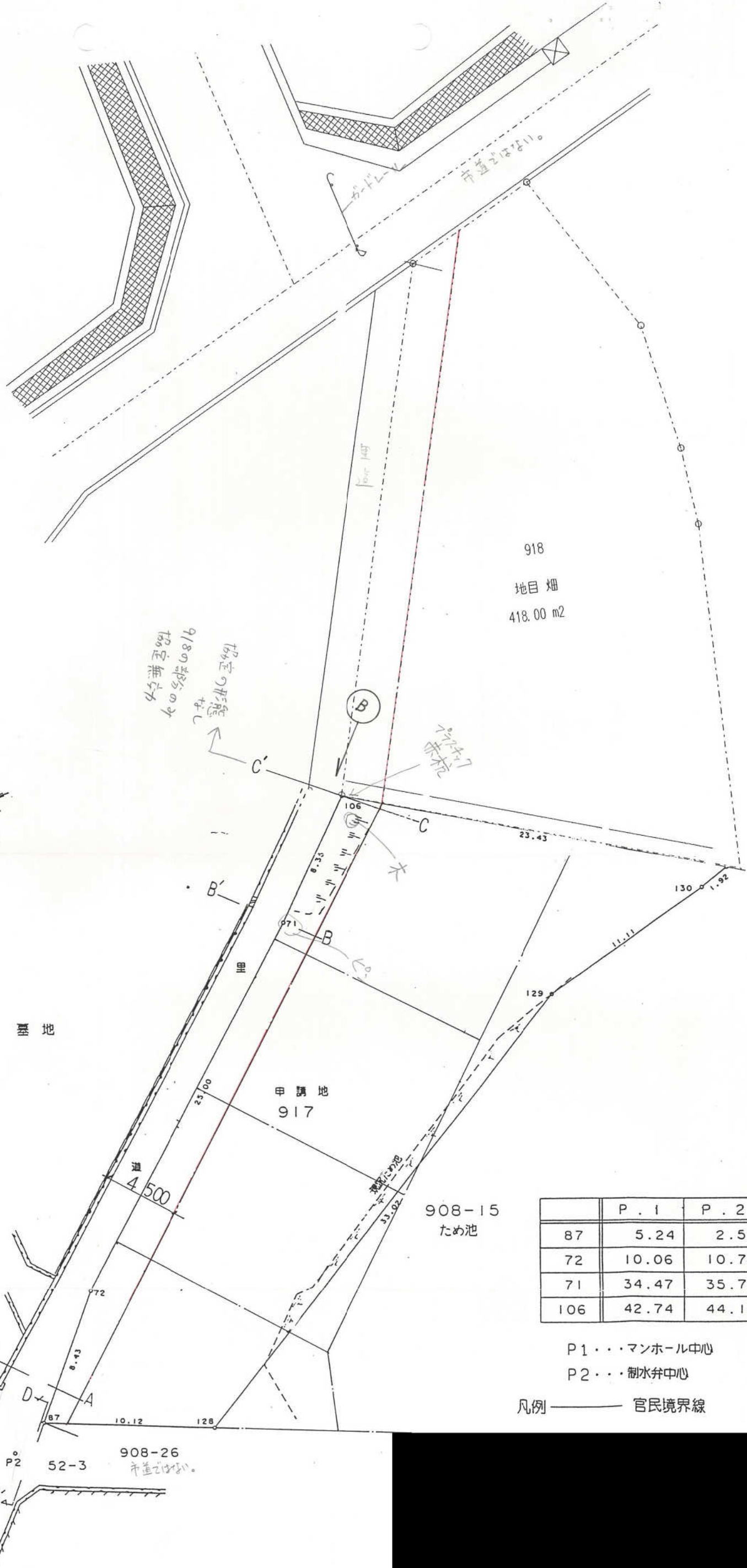

	P. 1	P. 2
87	5.24	2.52
72	10.06	10.79
71	34.47	35.78
106	42.74	44.13

P1・・・マンホール中心

P2・・・制水弁中心

凡例 ——— 官民境界線

平面図 (S: 1/250)

横断面図 (S:1/50)

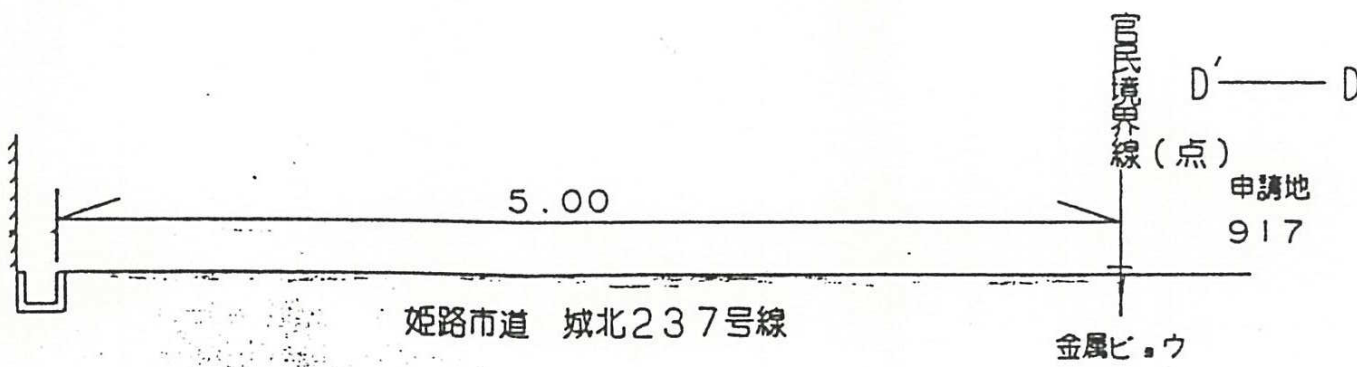
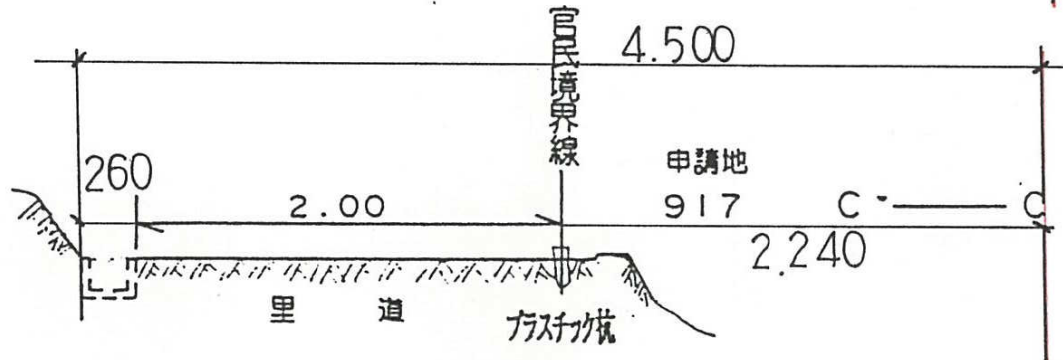
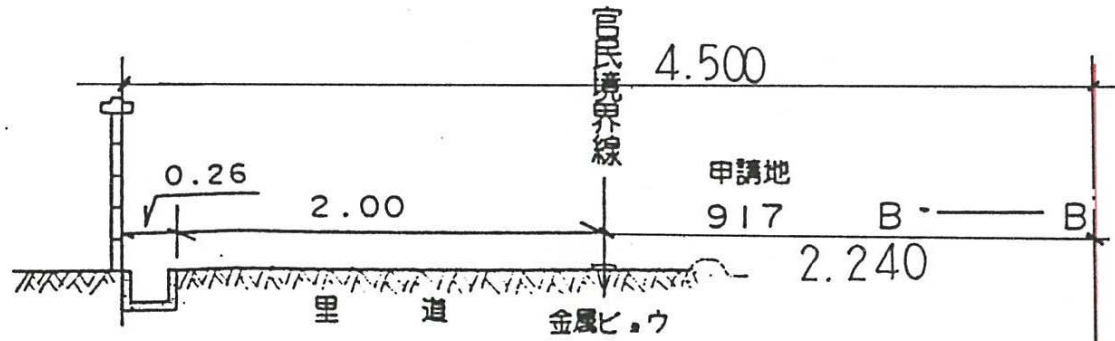
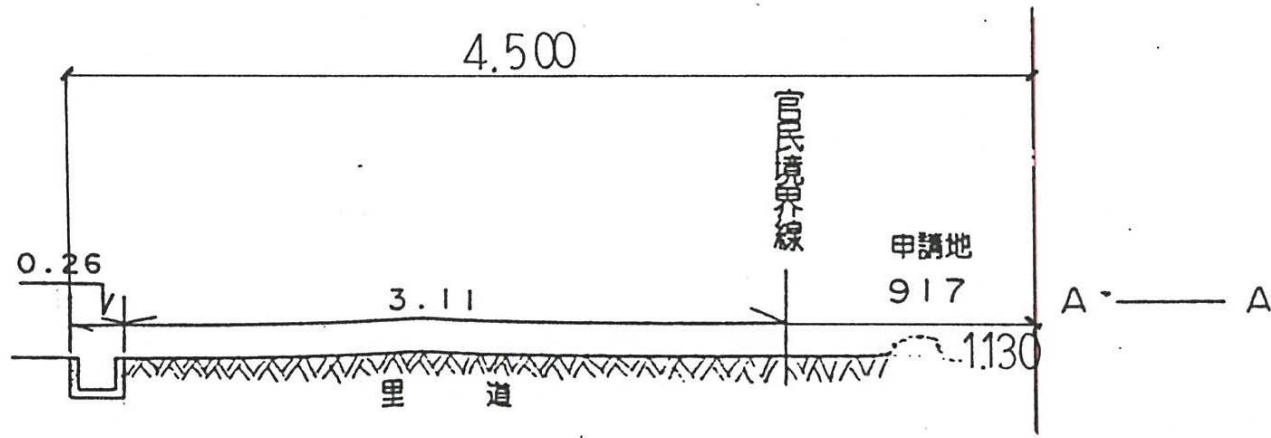

1

平面図 S=1/200

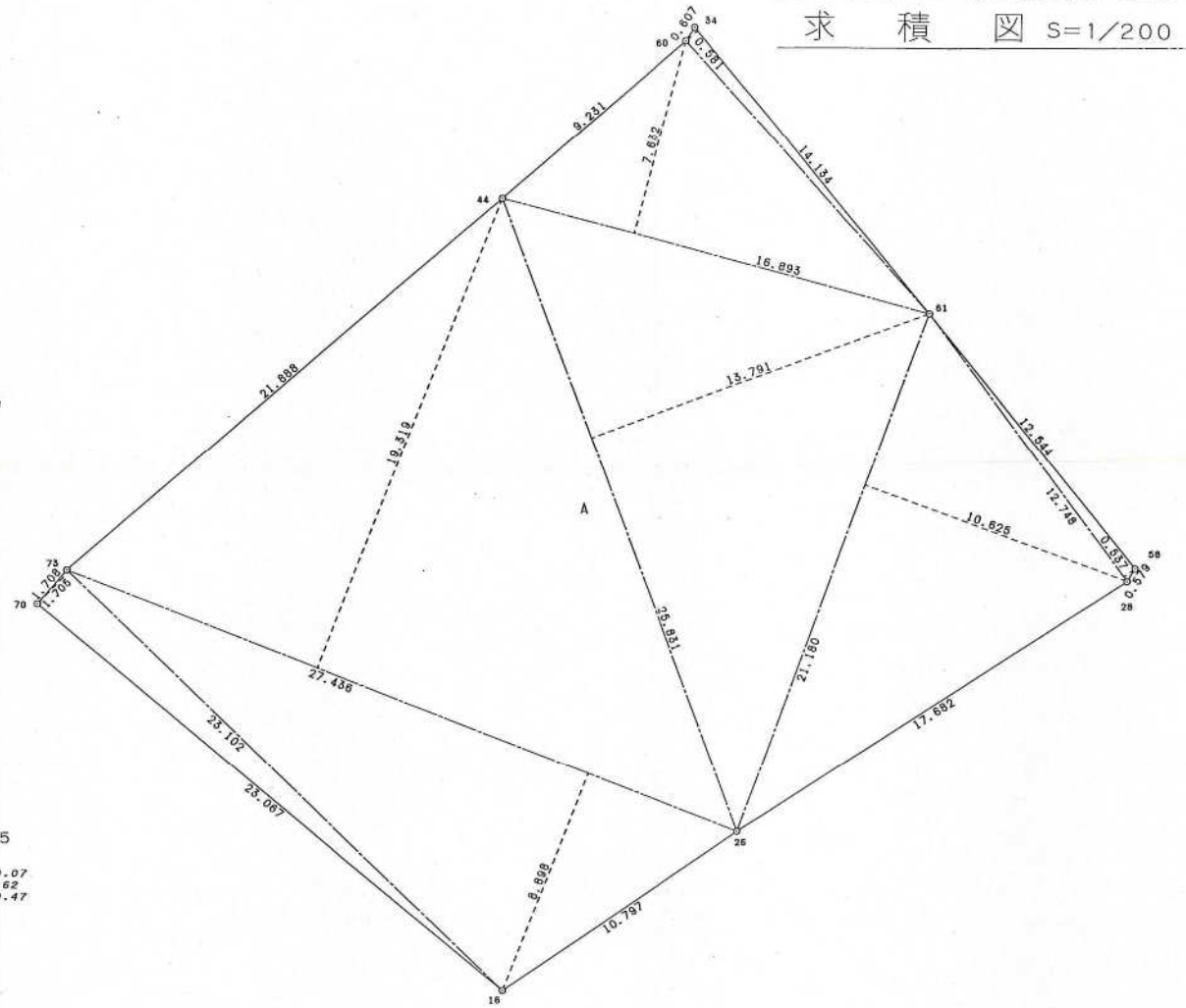
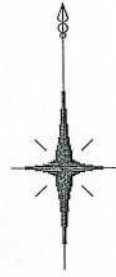

地番 A			
番号	底辺	高さ	倍面積
1	25.102 X	1.705 =	39.388910
2	27.436 X	8.898 =	244.125528
3	27.436 X	19.319 =	530.036084
4	25.831 X	13.791 =	356.235321
5	21.180 X	10.625 =	225.037500
6	12.748 X	0.537 =	6.845676
7	16.893 X	7.632 =	128.927376
8	14.134 X	0.581 =	8.211854
合計			1538.808249
面積			769.4041245
地積			769.40 m ²

横断 S=1/100

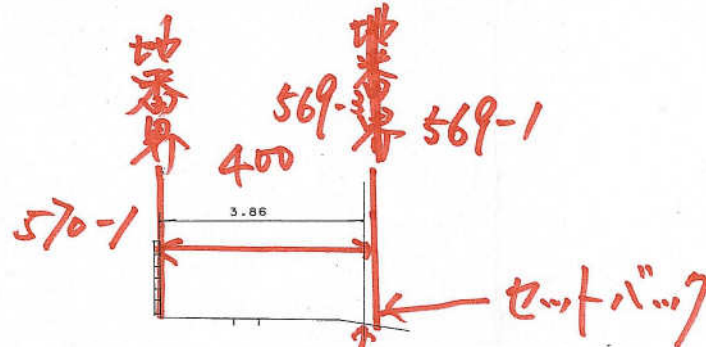
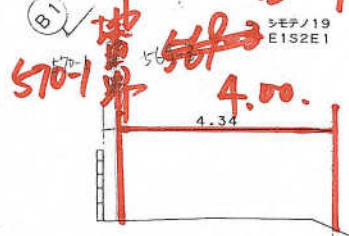
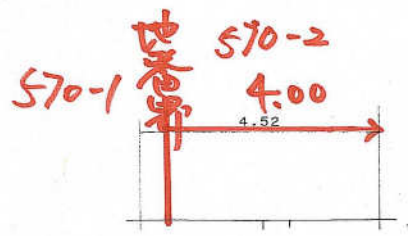

A1—A2

B1—B2

C1—C2

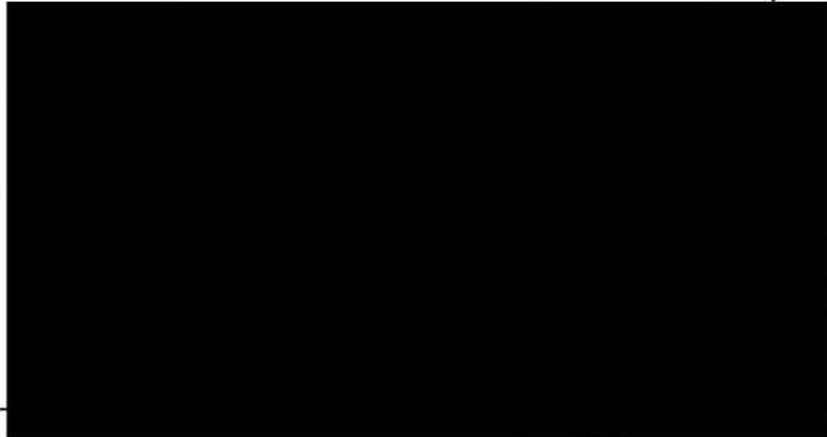

H9-032号

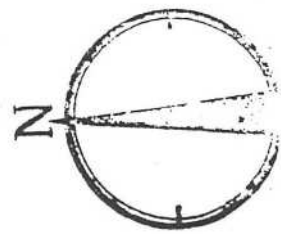
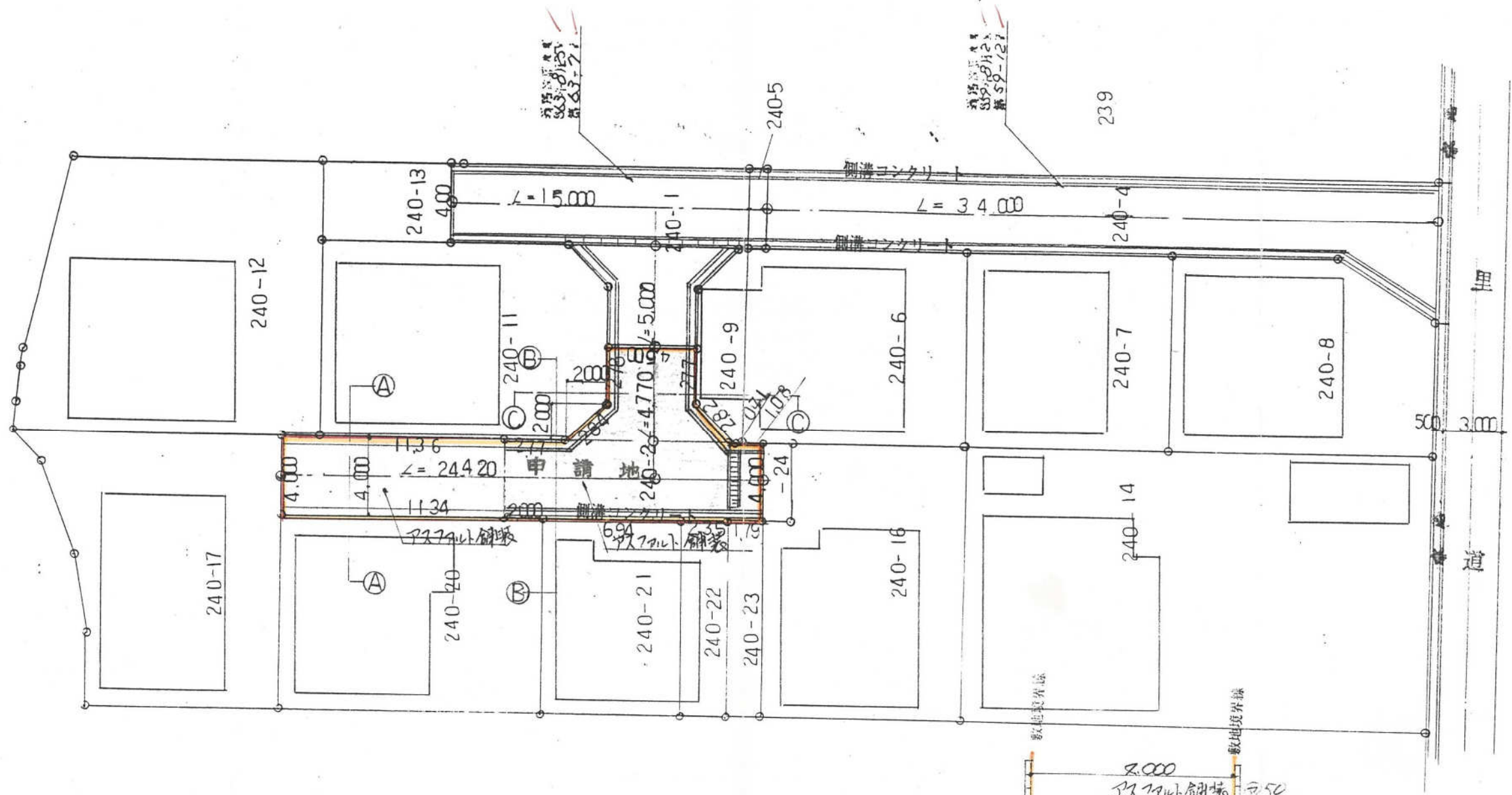

平面図 S=1:250

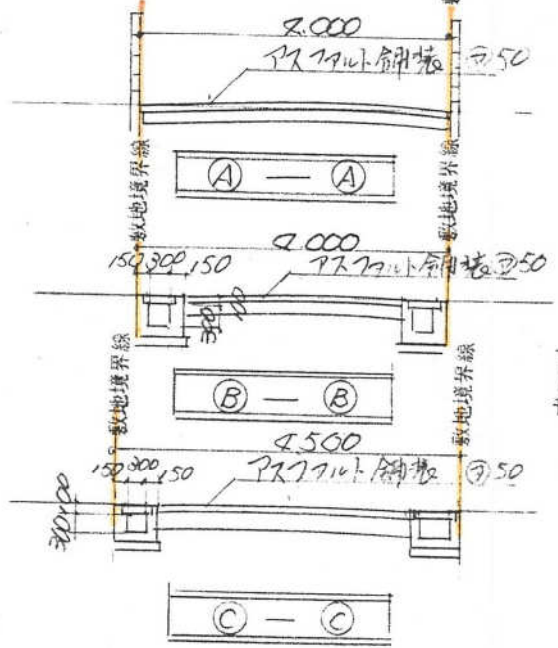

断面図 S=1:100



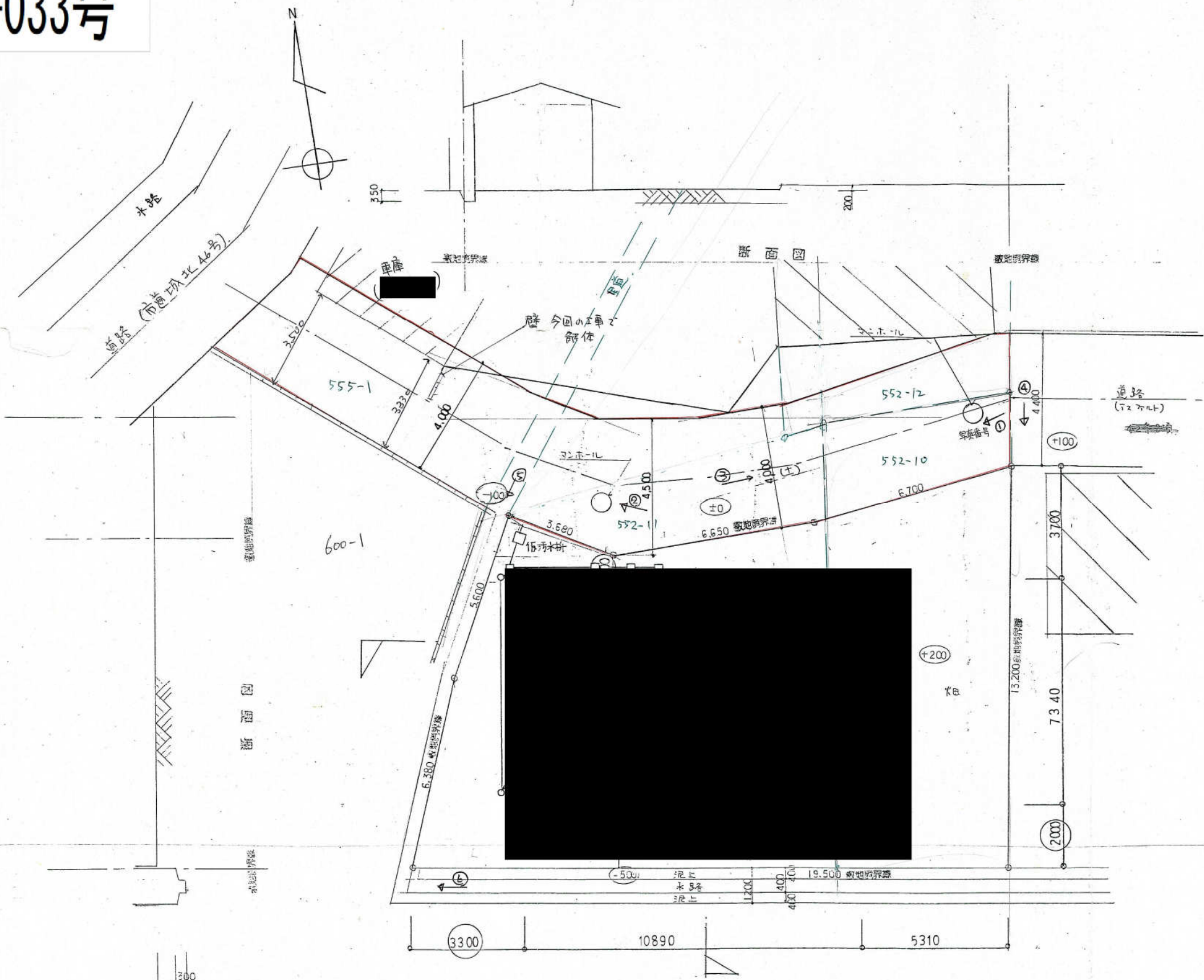

求積表

No	底辺	高さ	面積
1.	12.9	6.5	= 83.85
2.	16.4	4.9	= 80.36
3.	19.9	1.	= 19.9
4.	19.9	5.3	= 105.47
5.	19.5	6.2	= 120.9

合計	410.48
1/2 (地積)	205.24 m ²
	62.1 坪

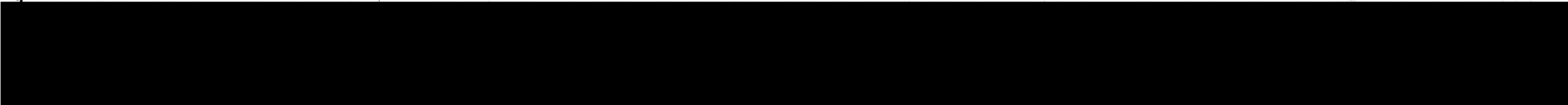
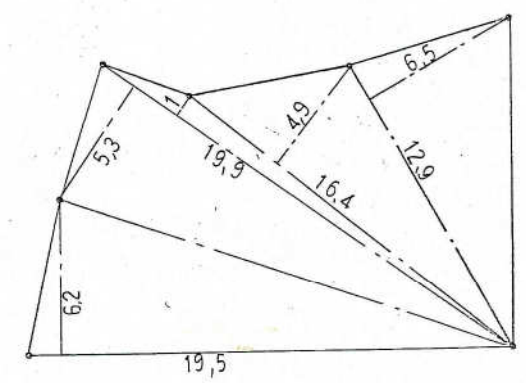

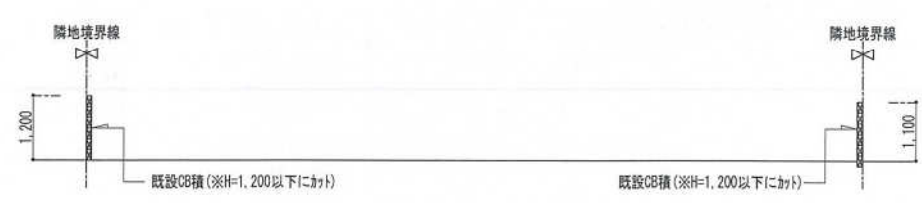
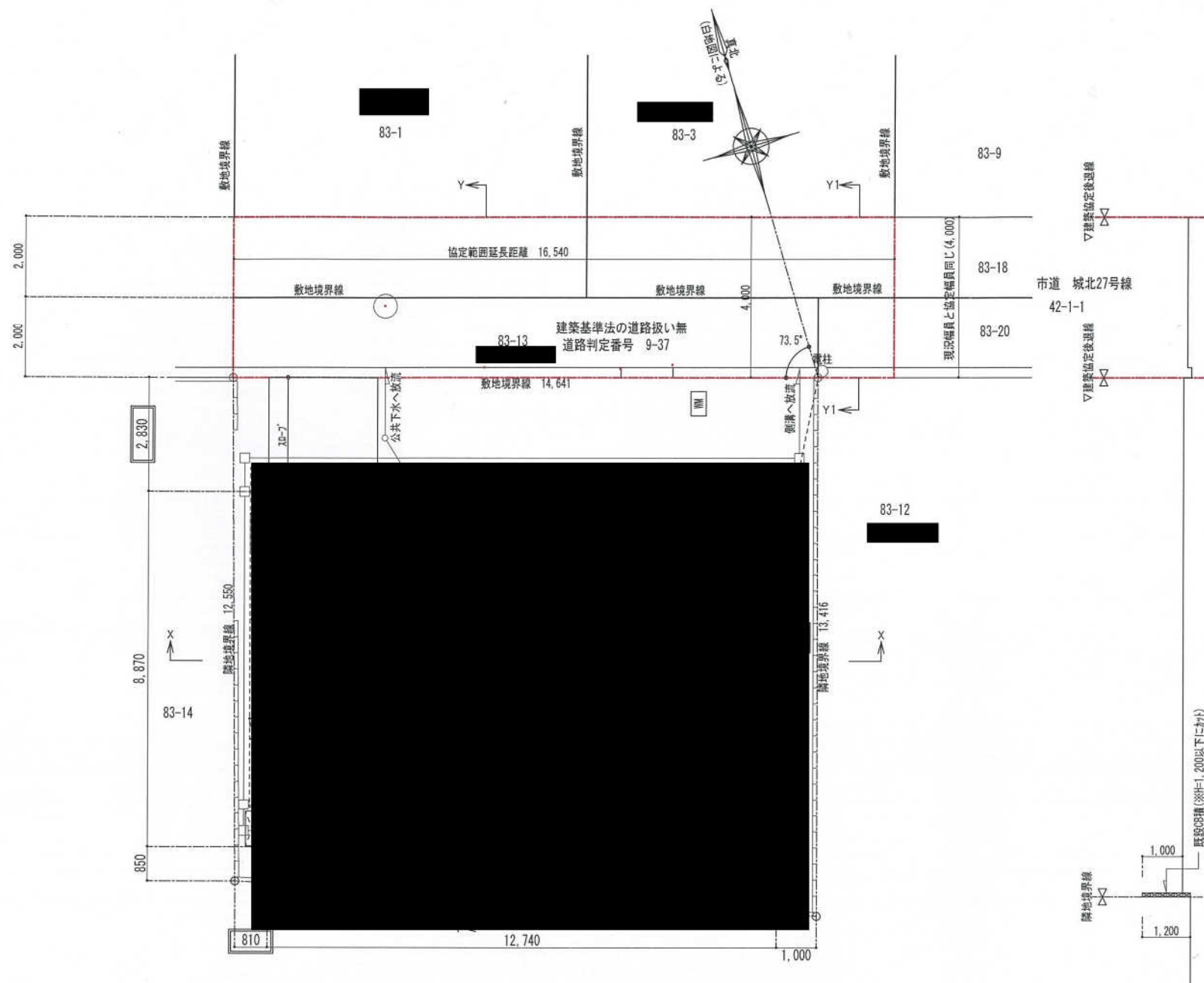

X-X 断面図 1/100



Y-Y 断面図 1/100

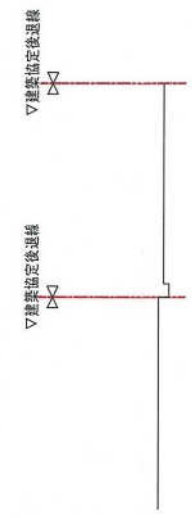

Y1-Y1 断面図 1/100

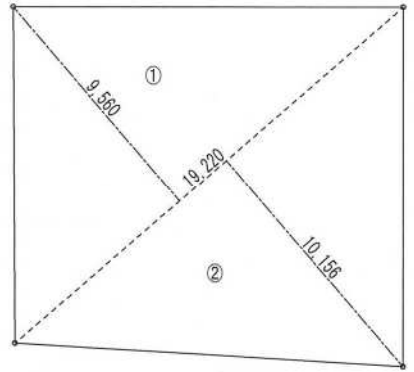



平面図 S=1/200

【A-A' 断面図】



【B-B' 断面図】



断面図 S=1/100

※協定ラインと敷地との境に緑石等を設置すること。

測量図

山陽電鉄本線

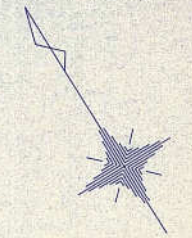

姫路市飾磨区中島字北町九参五番六 ほか

至飾磨駅

踏切 至妻鹿駅

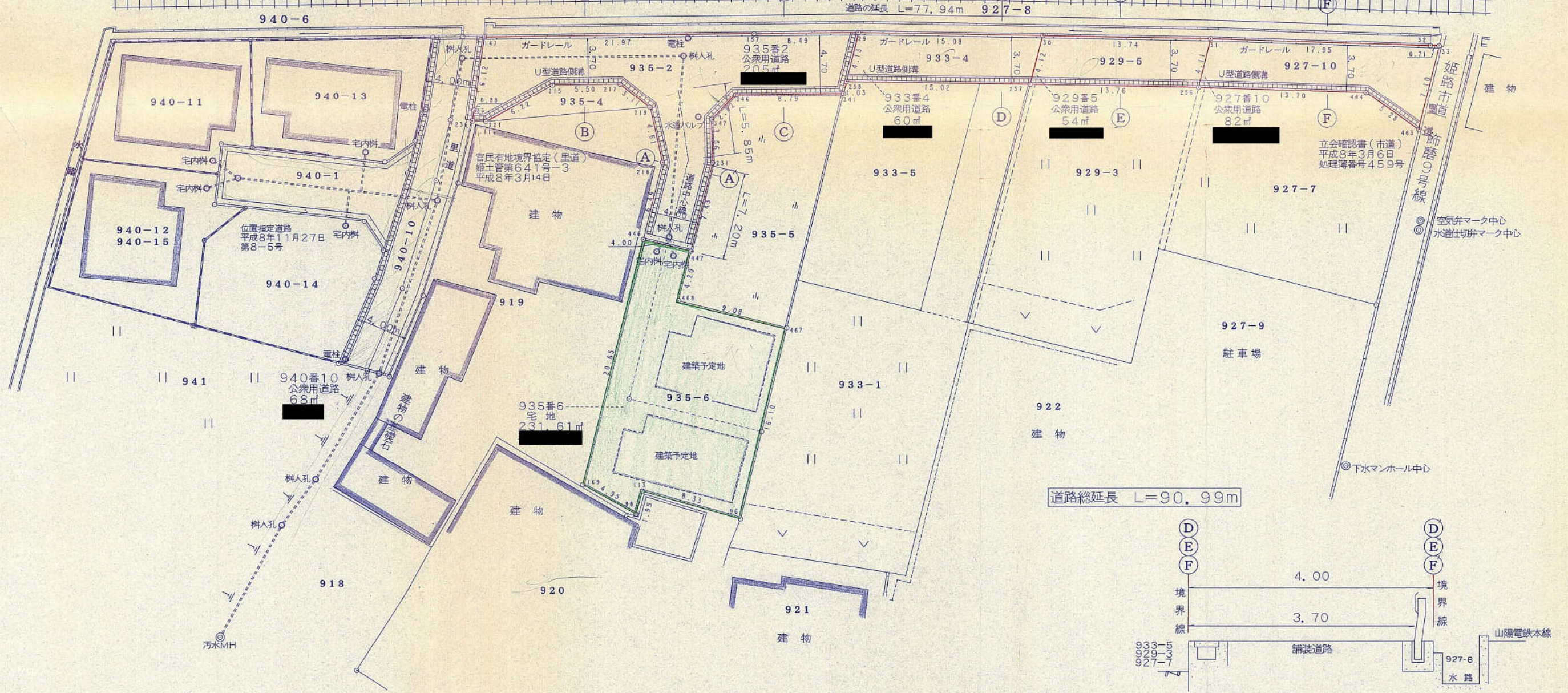

断面図 1:50

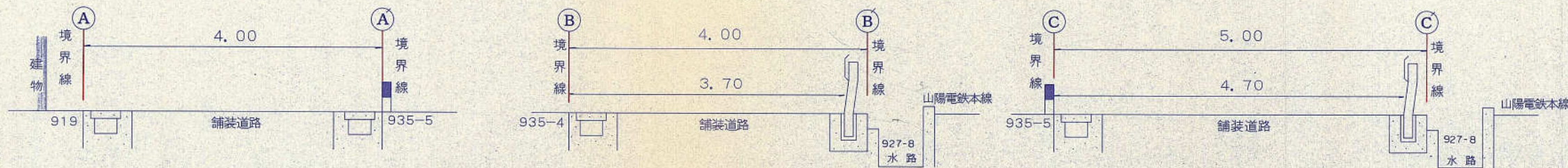

通路平面図 姫路市大津区平松字水尾 縮尺 1:100

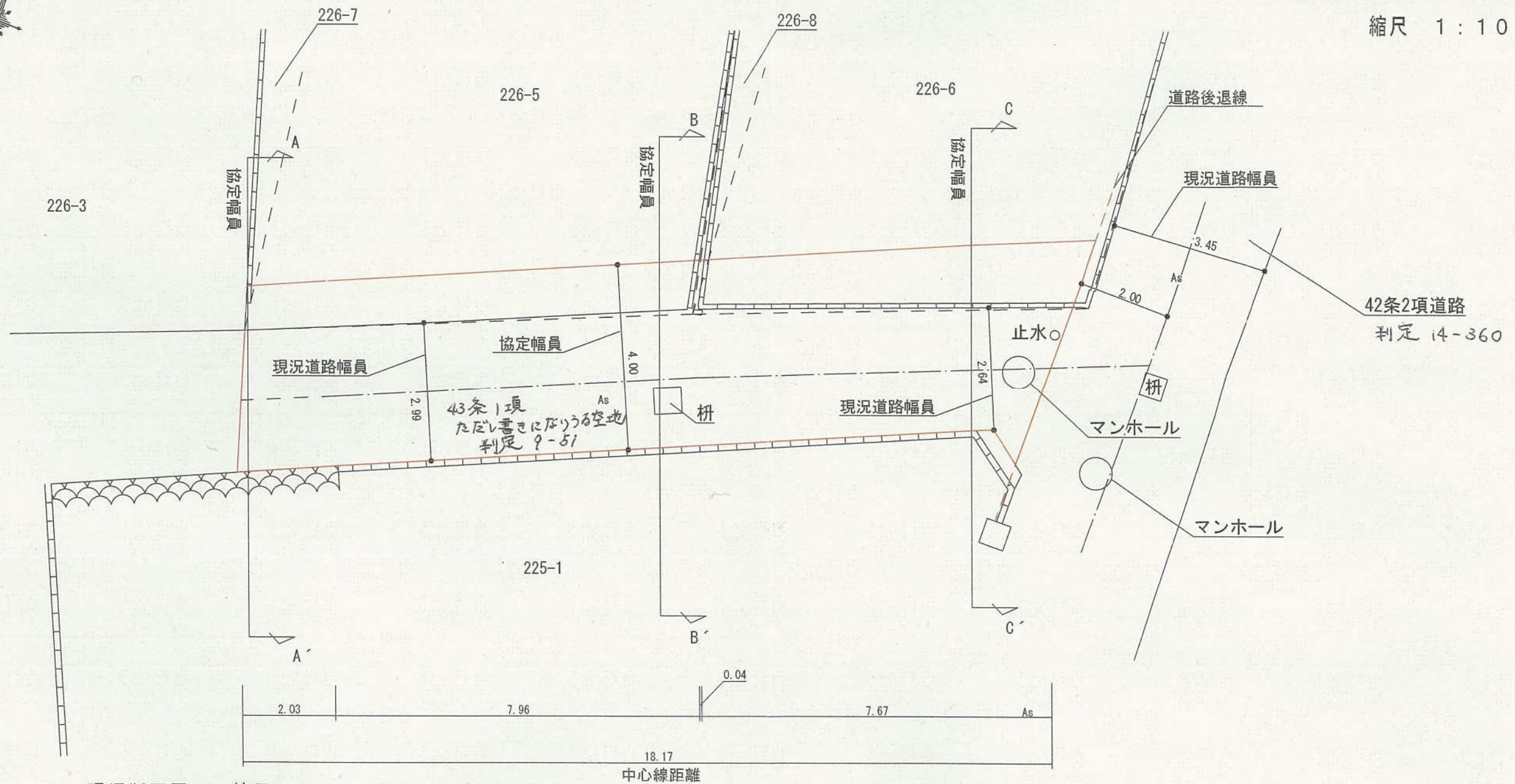

現況断面図 縮尺 1:100

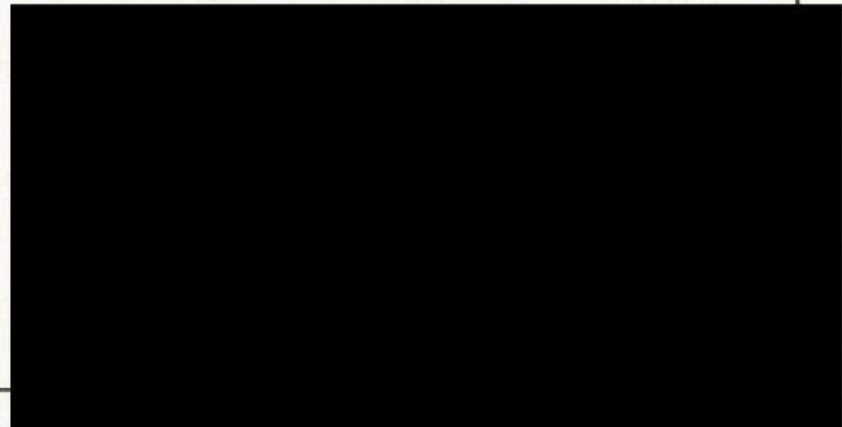
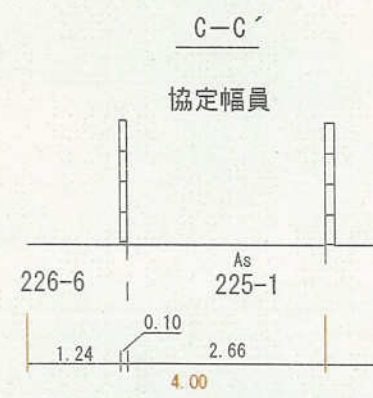
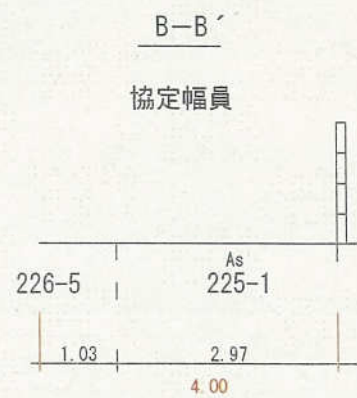
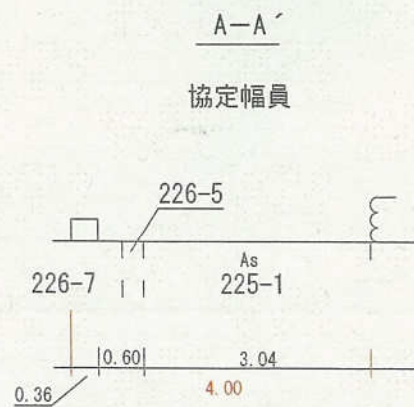

H9-052号

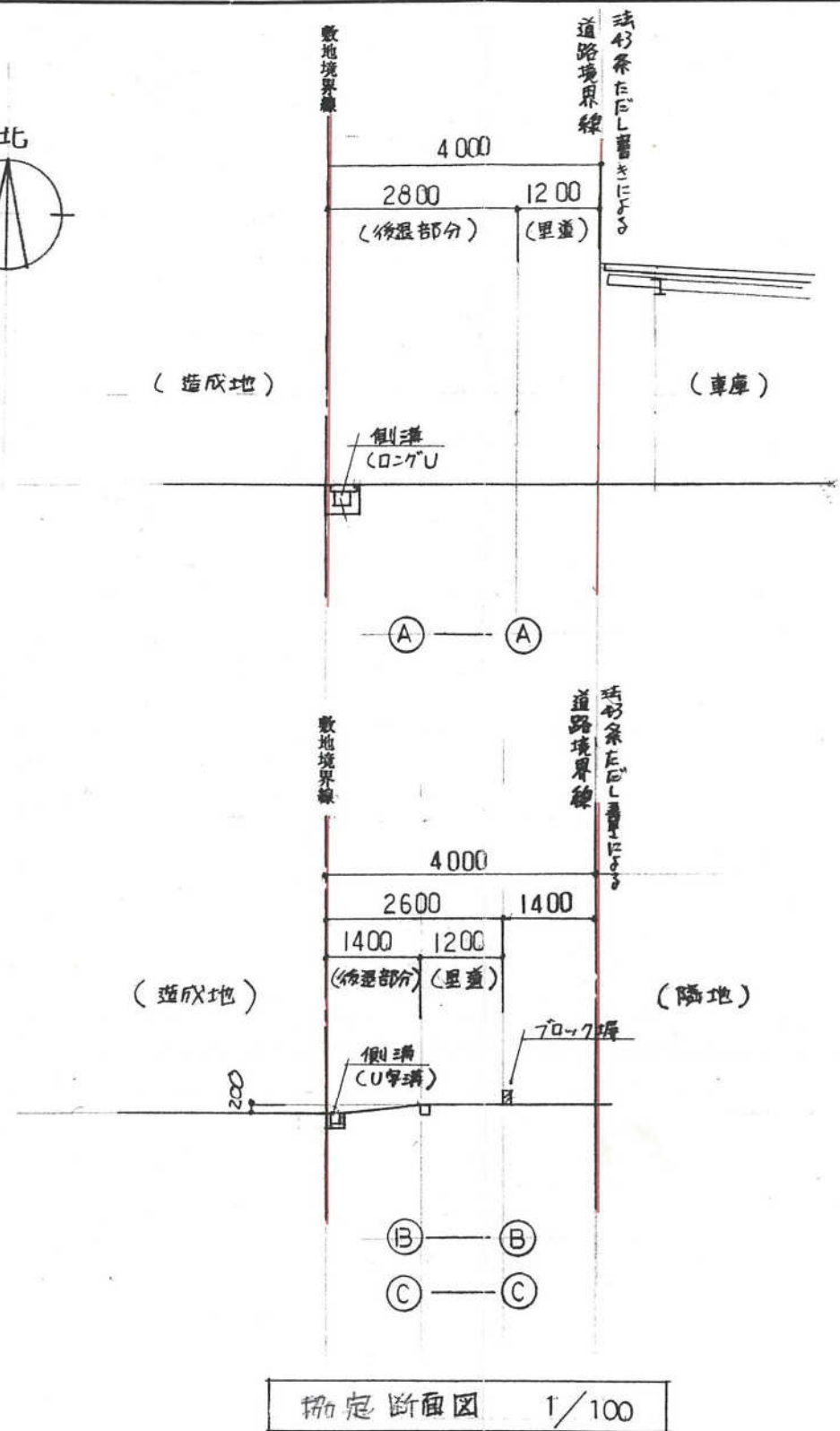
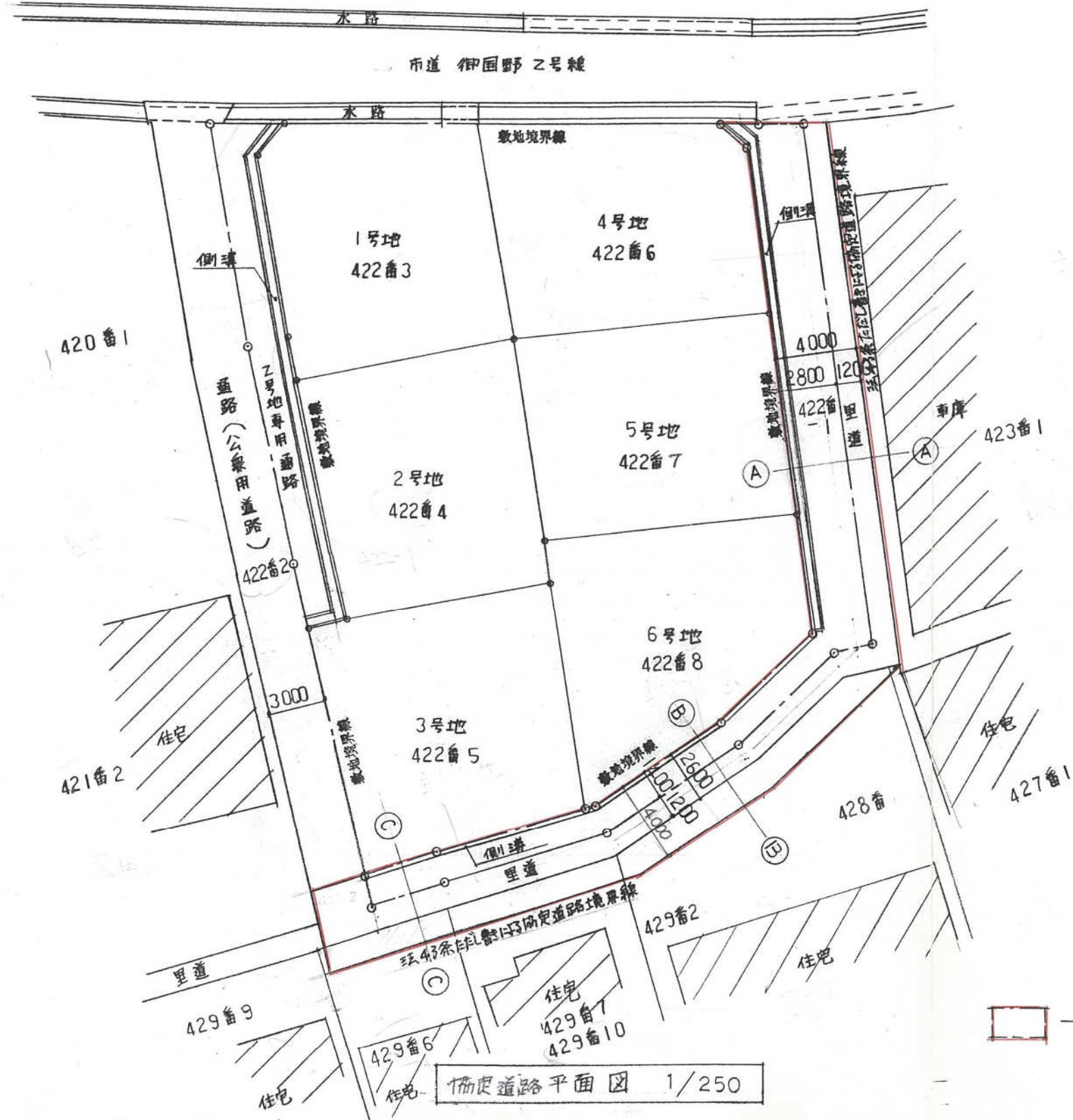
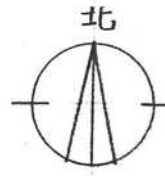

法43条F/E/Sによる法定道路
 巾員4.0m 延長 55.5m

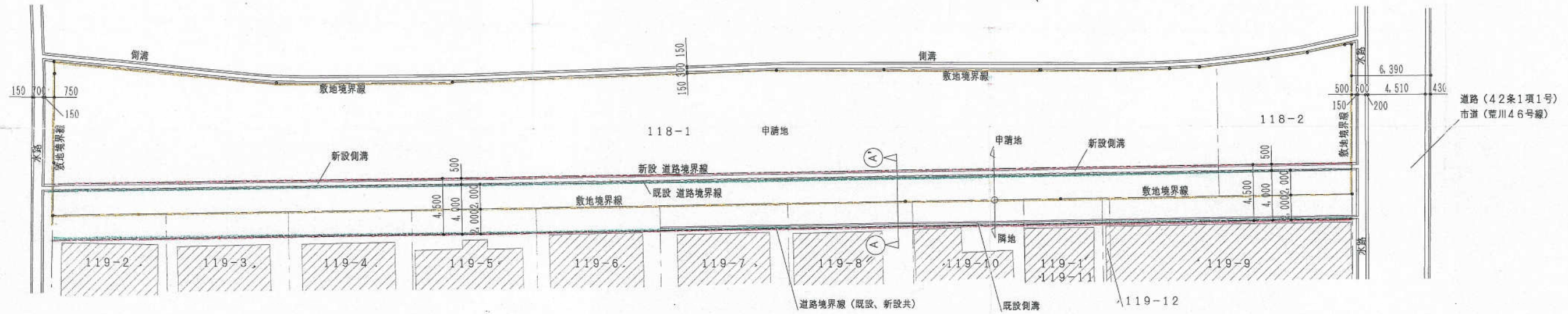
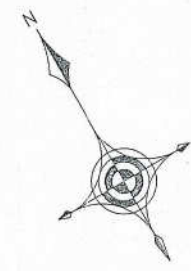

道路配置図 S=1:250

凡例	
	敷地境界線
	新設道路境界線
	既設道路境界線

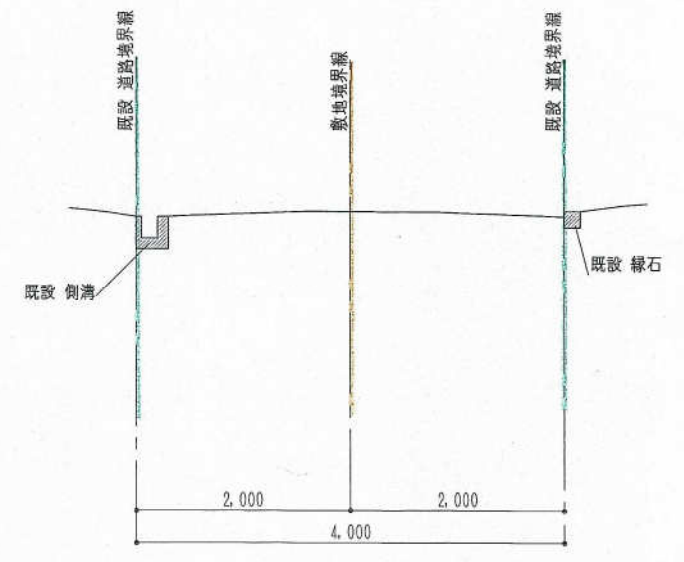

A~A' 断面図 (既設) S=1:50

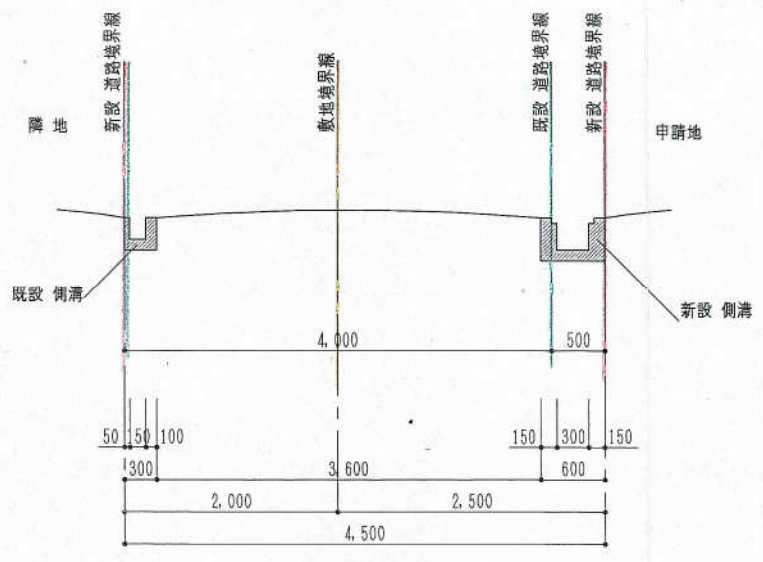

A~A' 断面図 (新設) S=1:50

H9-065号

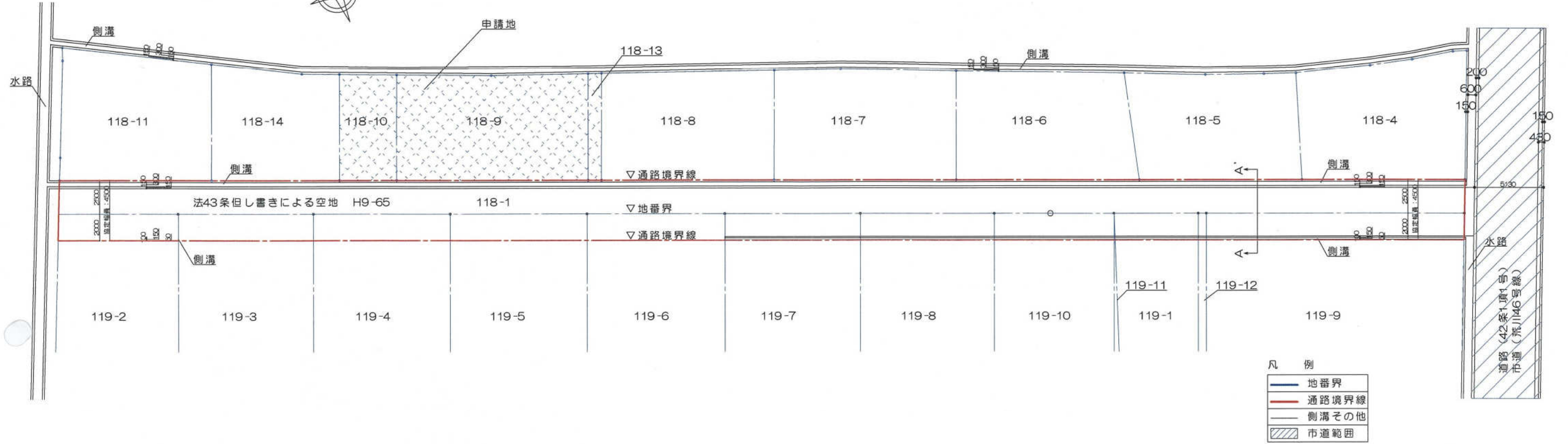

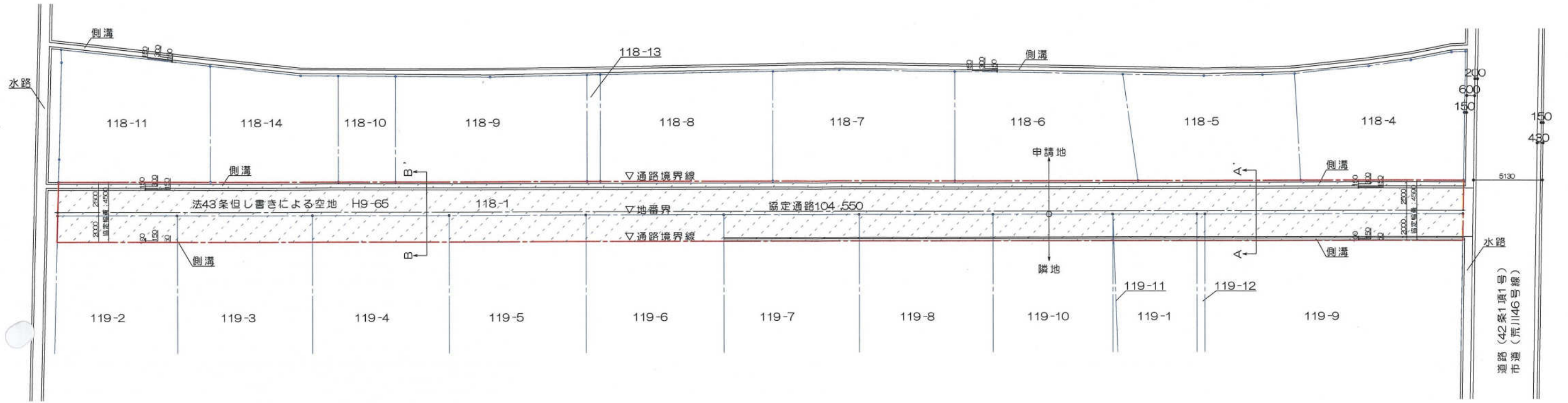

通路平面図 S=1/300

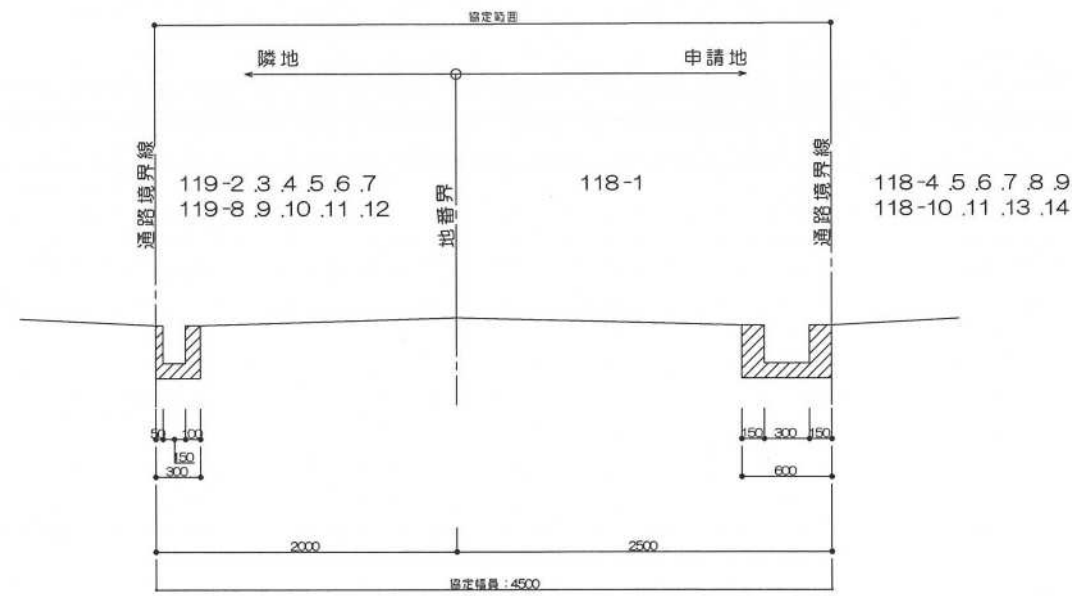

A-A' 断面図 S=1/50

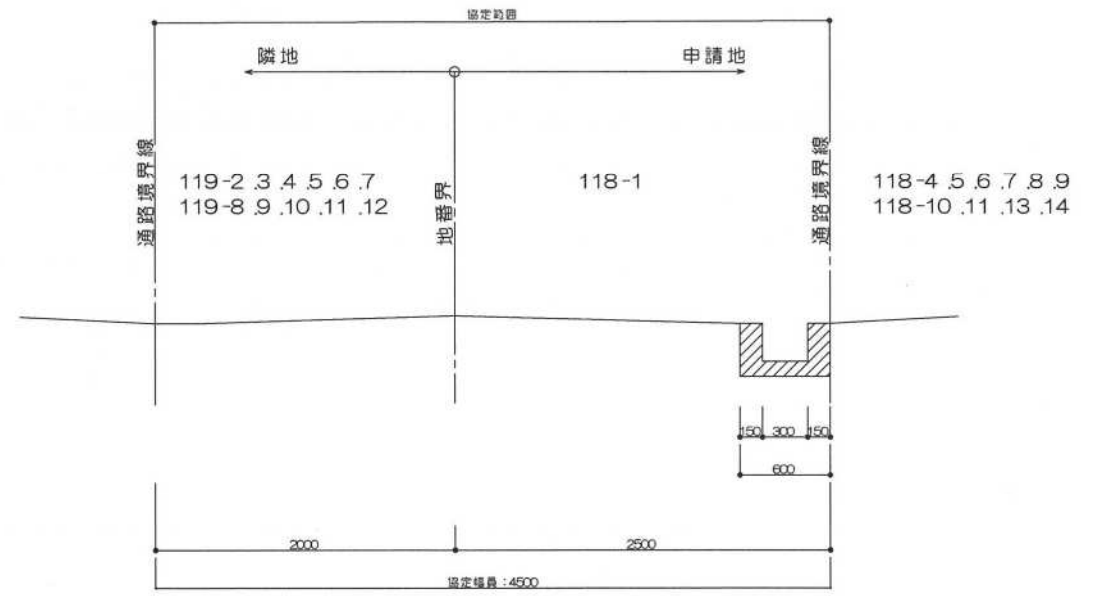

B-B' 断面図 S=1/50

- 凡例
- 地番界
 - 通路境界線
 - 側溝その他
 - ▨ 協定範囲

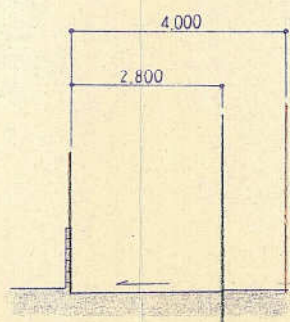
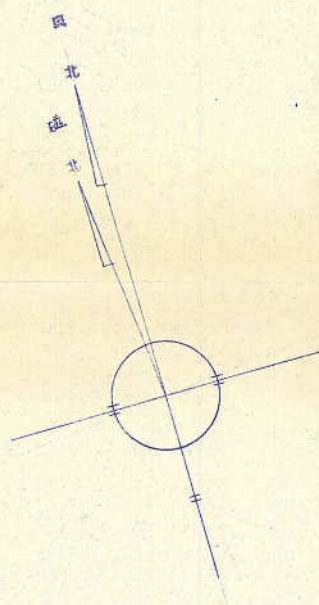

A - A 断面 S=1:100

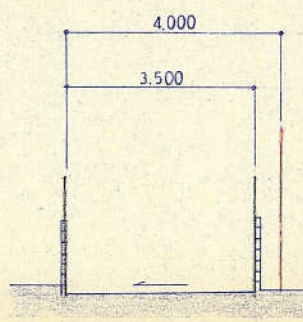

B - B 断面 S=1:100

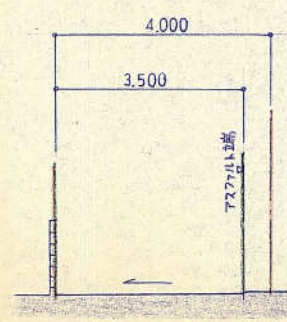

C - C 断面 S=1:100

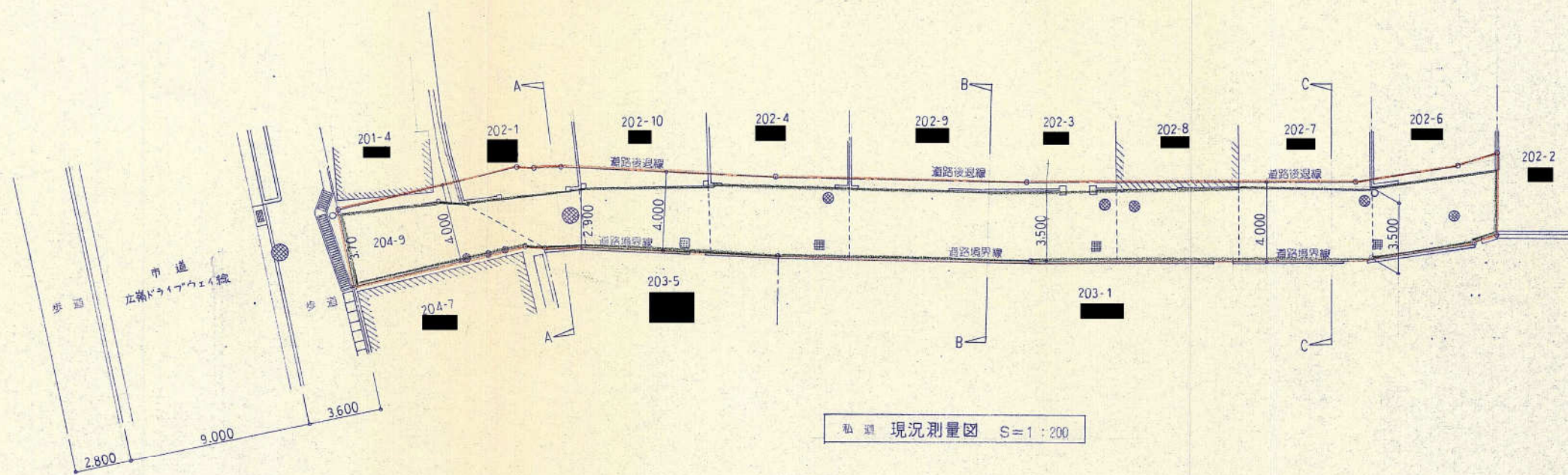

凡 例

- 通路現況ラインをしめす。
- 通路協定後ラインをしめす。

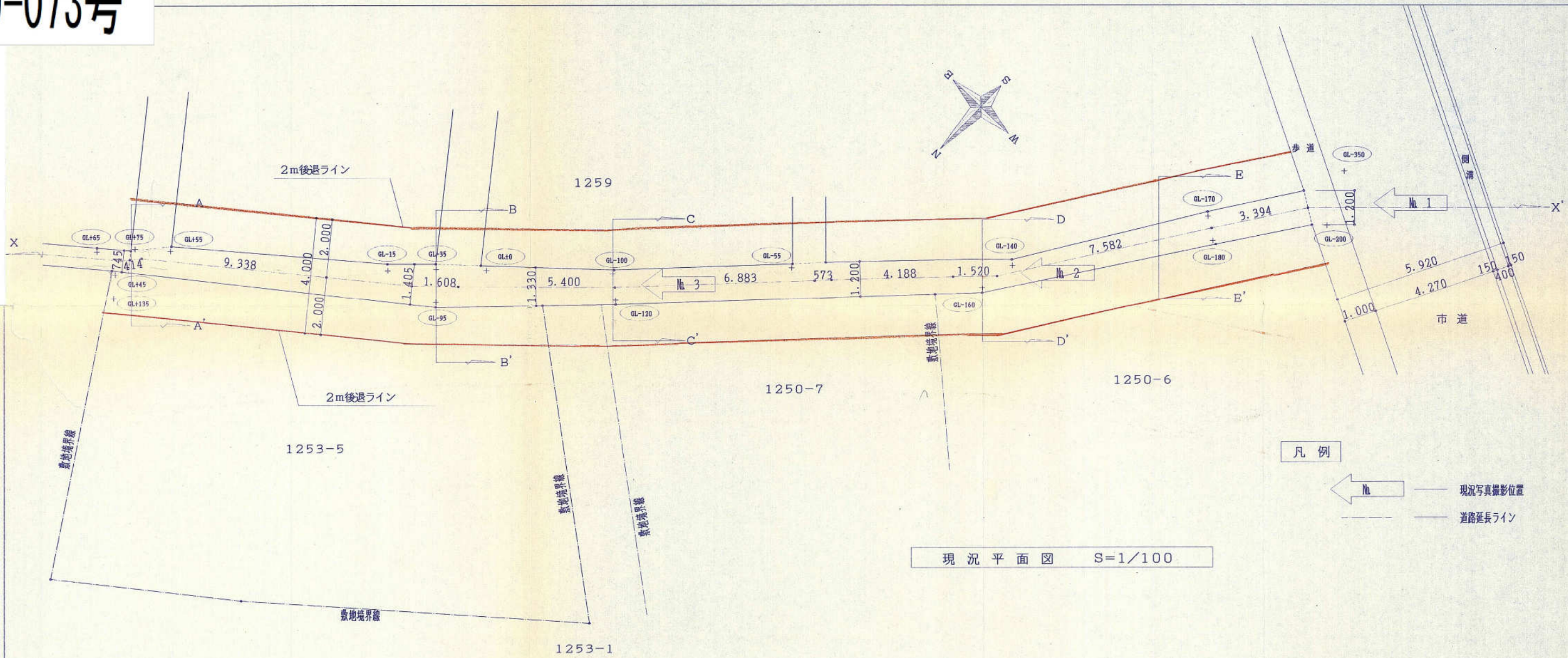

凡例

現況写真撮影位置
 道路延長ライン

現況平面図 S=1/100

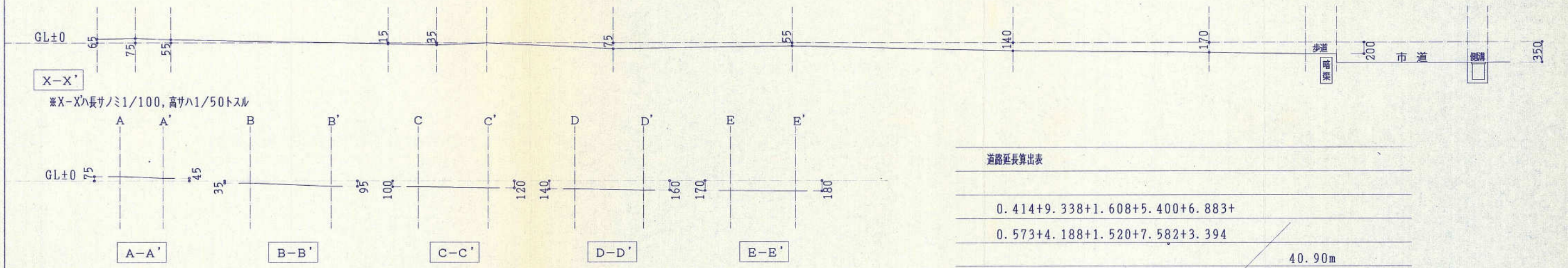

現況断面図 S=1/50

道路延長算出表

0.414+9.338+1.608+5.400+6.883+
0.573+4.188+1.520+7.582+3.394
40.90m

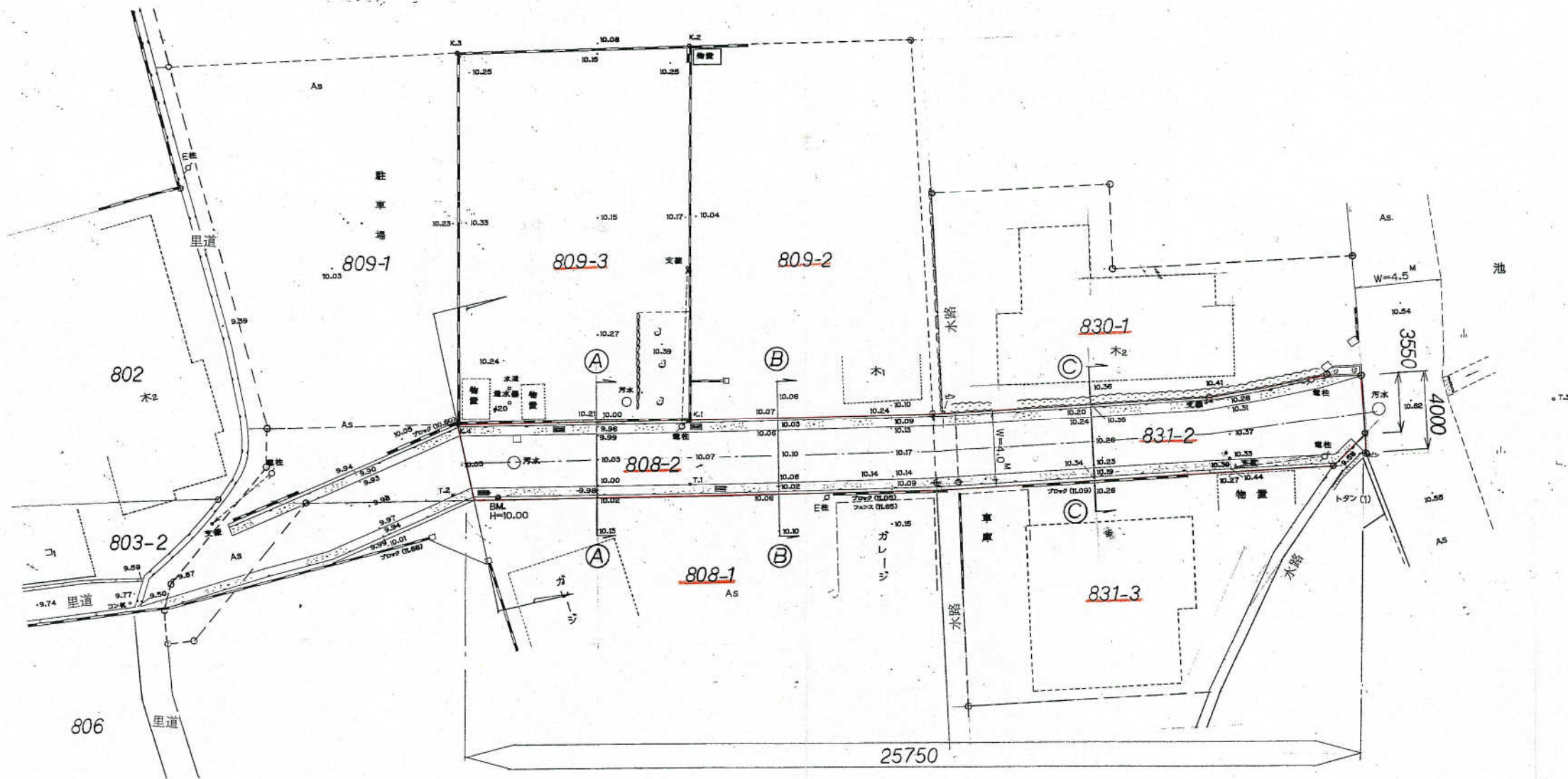
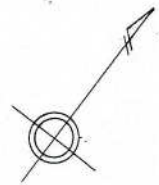

道路断面及び、協定後道路斜線図 S=1:100

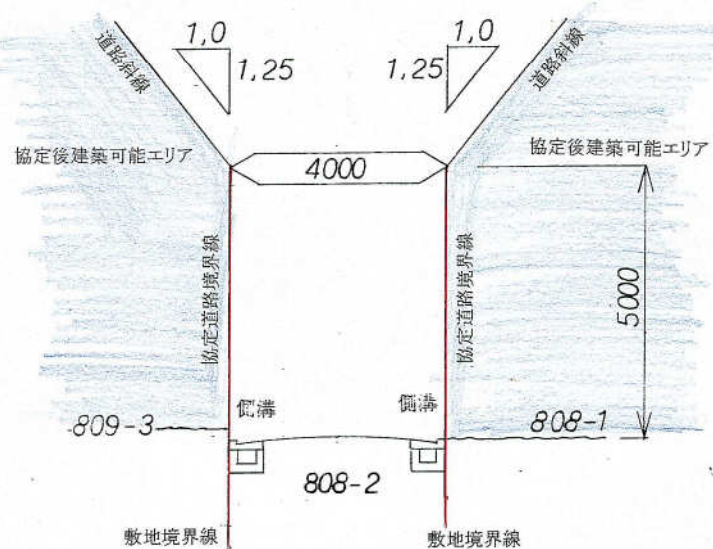

(A) 断面図 S=1:100

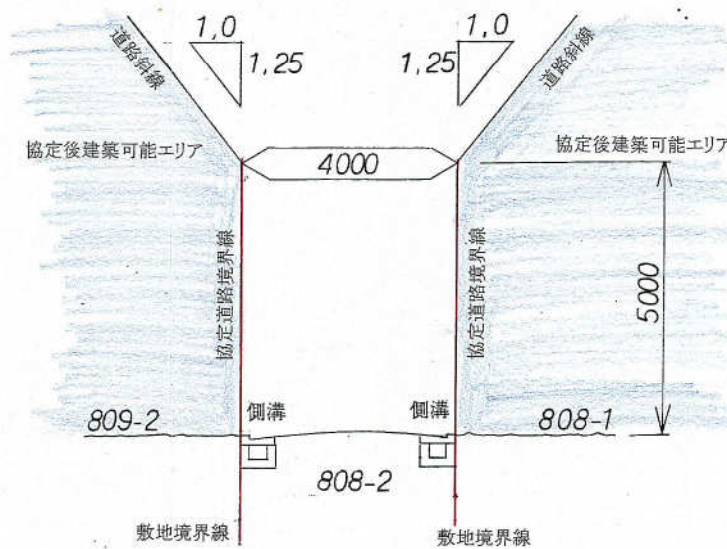

(B) 断面図 S=1:100

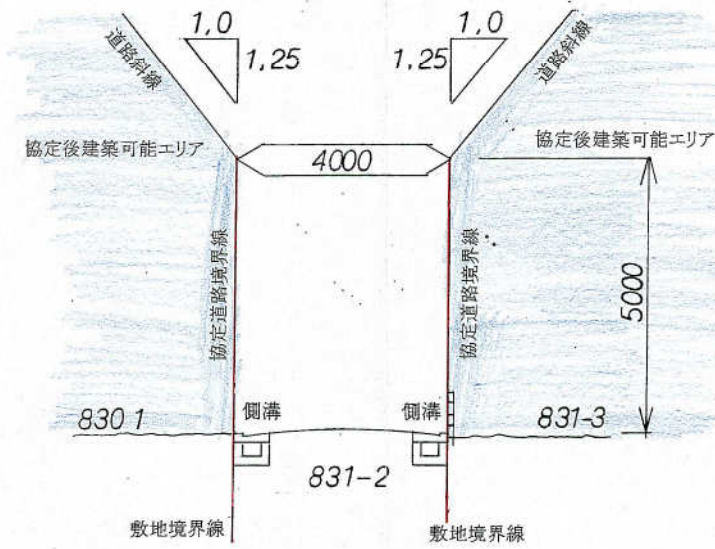

(C) 断面図 S=1:100

H9-084号

別所町北宿 1028-3 (地目 公衆道路)
11.200 * (4.220+3.610) * 1/2 = 43.84㎡

別所町北宿 1029-7 (地目 宅地)
5.790 * (3.220+2.220) * 1/2 = 15.74㎡

所有者 [REDACTED]

所有者 [REDACTED]

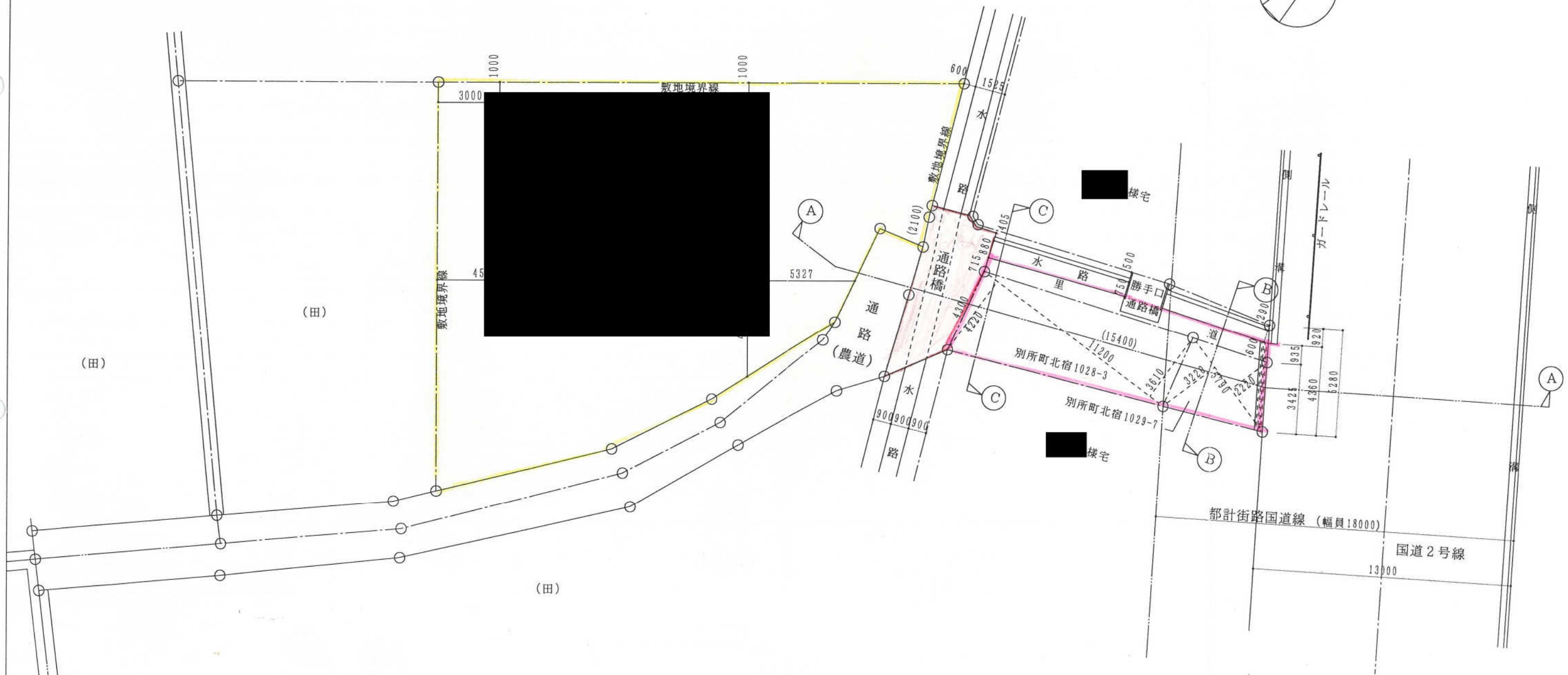
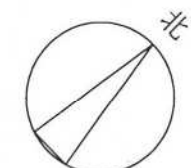

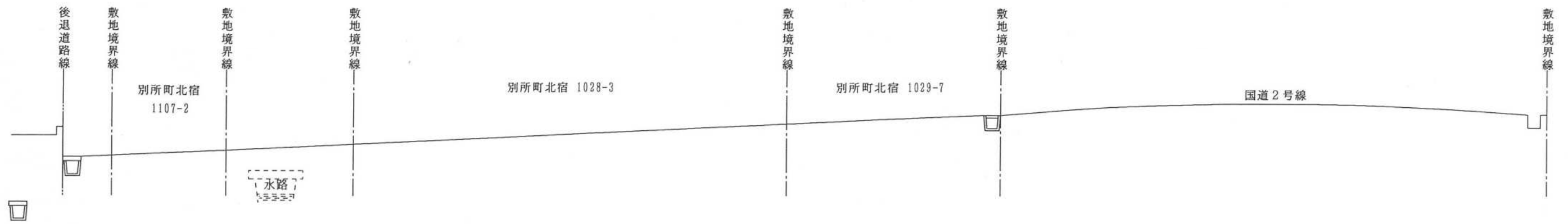

(A) ~ (A)

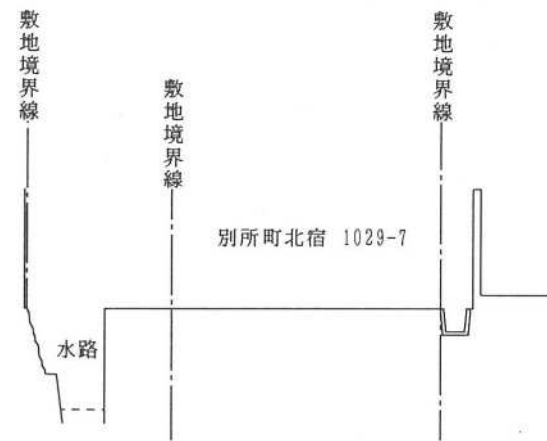

(B) ~ (B)

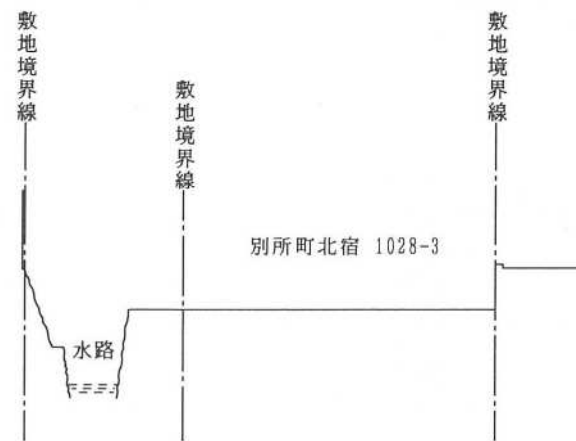

(C) ~ (C)

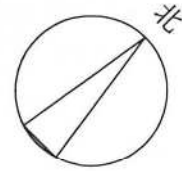

求積表

$2.020 \times 0.570 = 1.151$
$2.790 \times 1.055 = 2.943$
$2.790 \times 0.670 = 1.869$
$3.715 \times 0.470 = 1.746$
$3.715 \times 1.770 = 6.575$
$3.945 \times 2.060 = 8.126$
$7.195 \times 1.925 = 13.850$
$7.195 \times 1.350 = 9.713$
計 45.973
1/2 22.986㎡

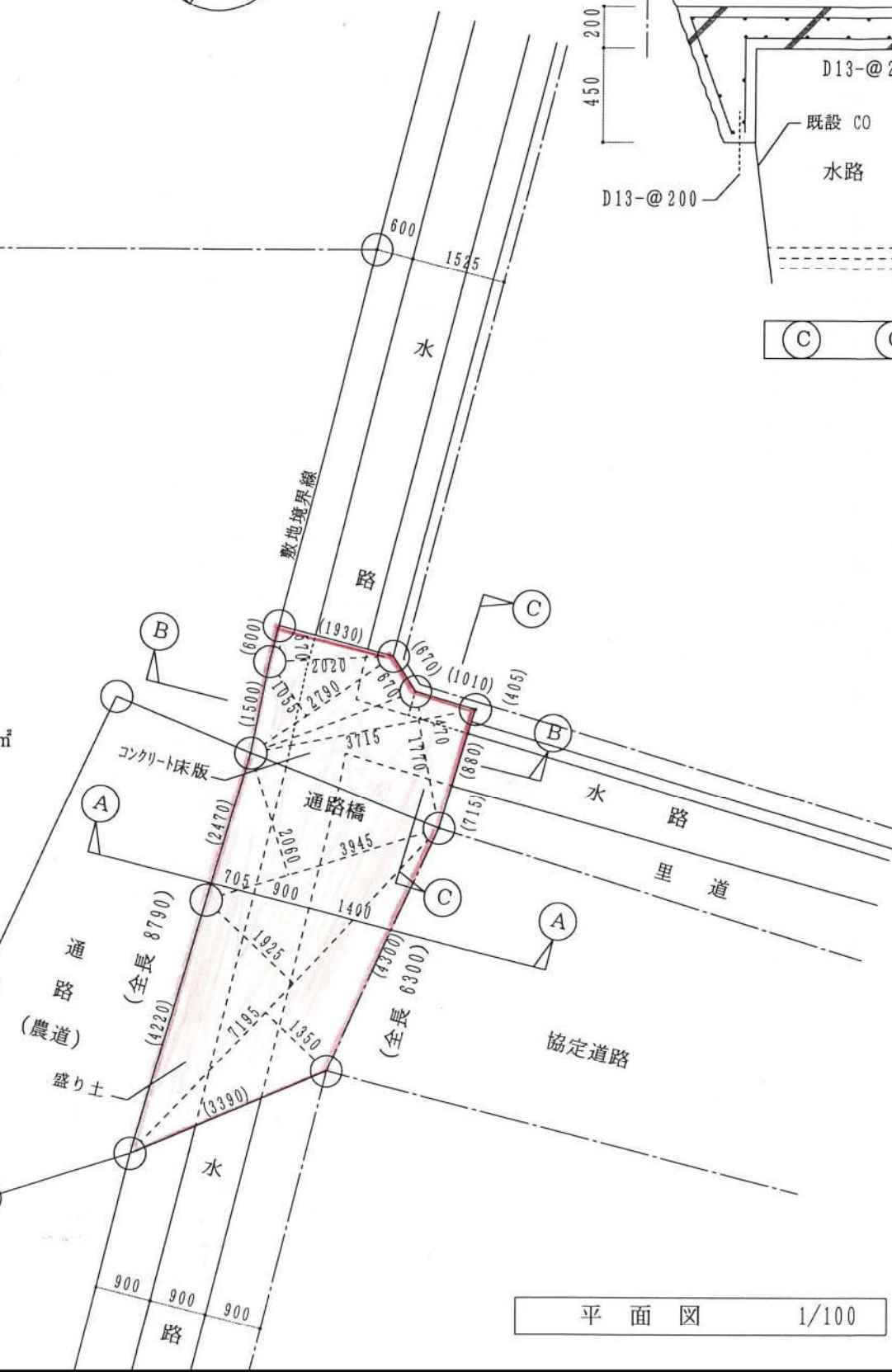

平面図 1/100

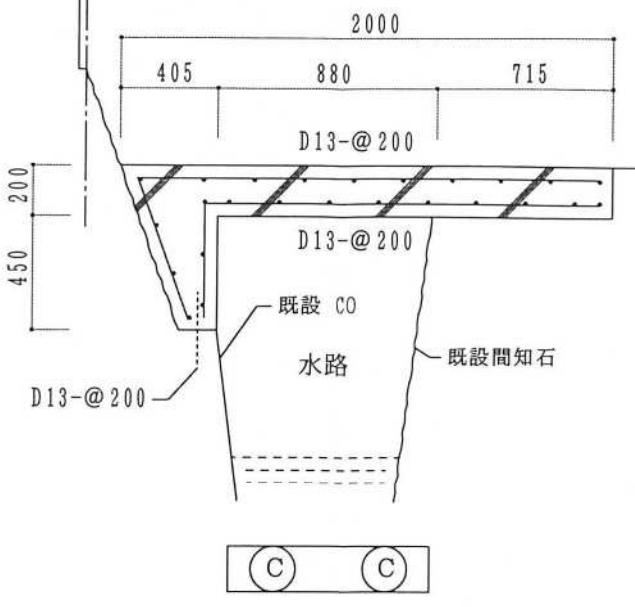

(C) (C)

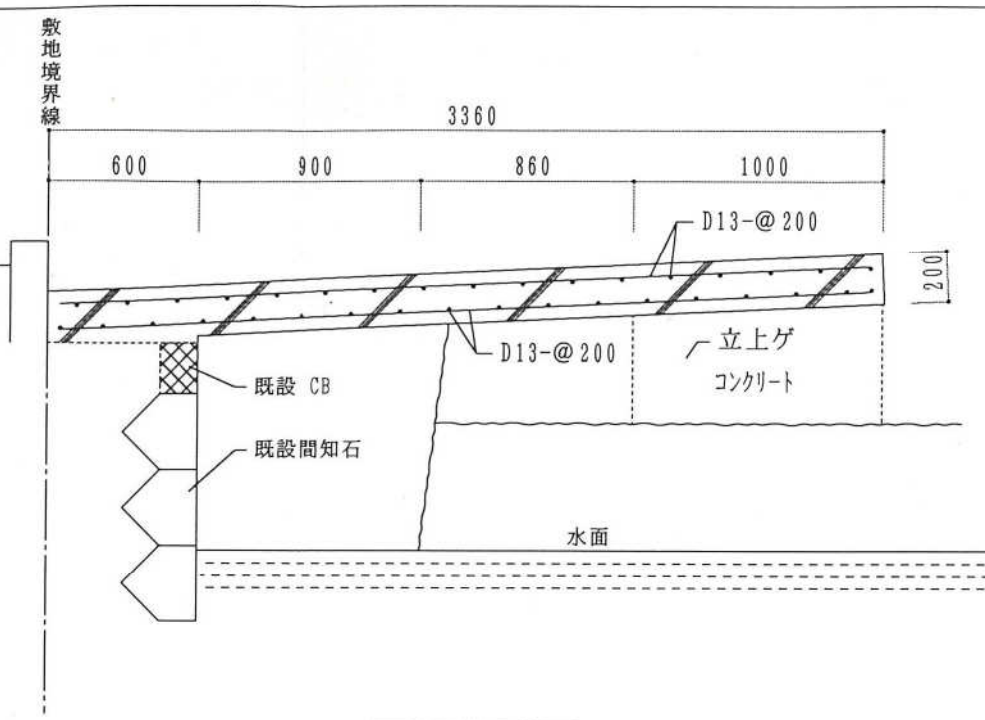

(B) (B)

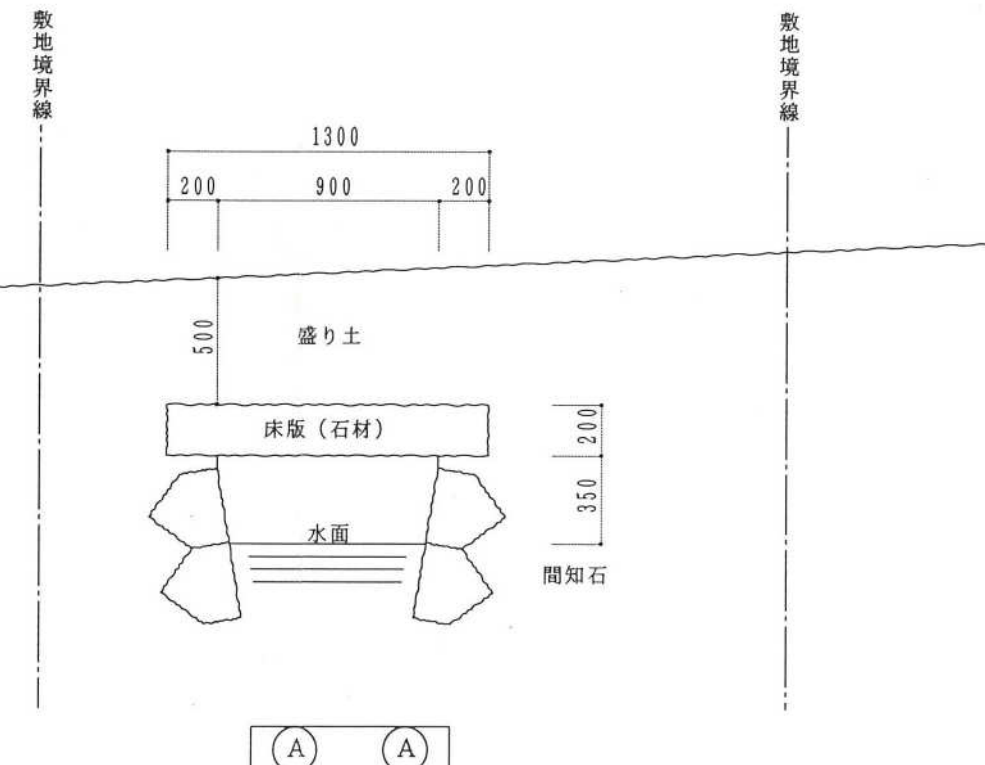

(A) (A)

断面詳細図 1/30