

通路協定図 1/100

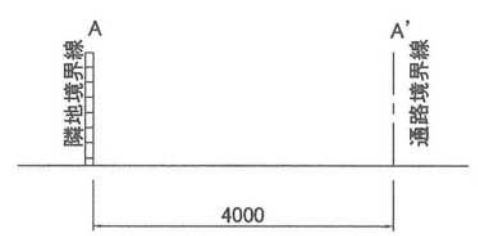

A-A'断面図 1/100

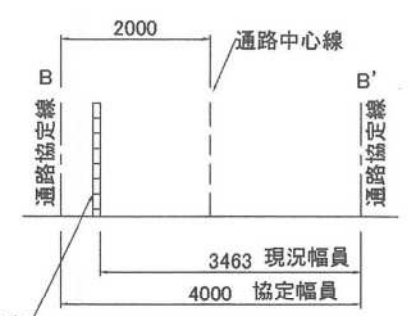

B-B'断面図 1/100



通路協定図

縮尺 1:150

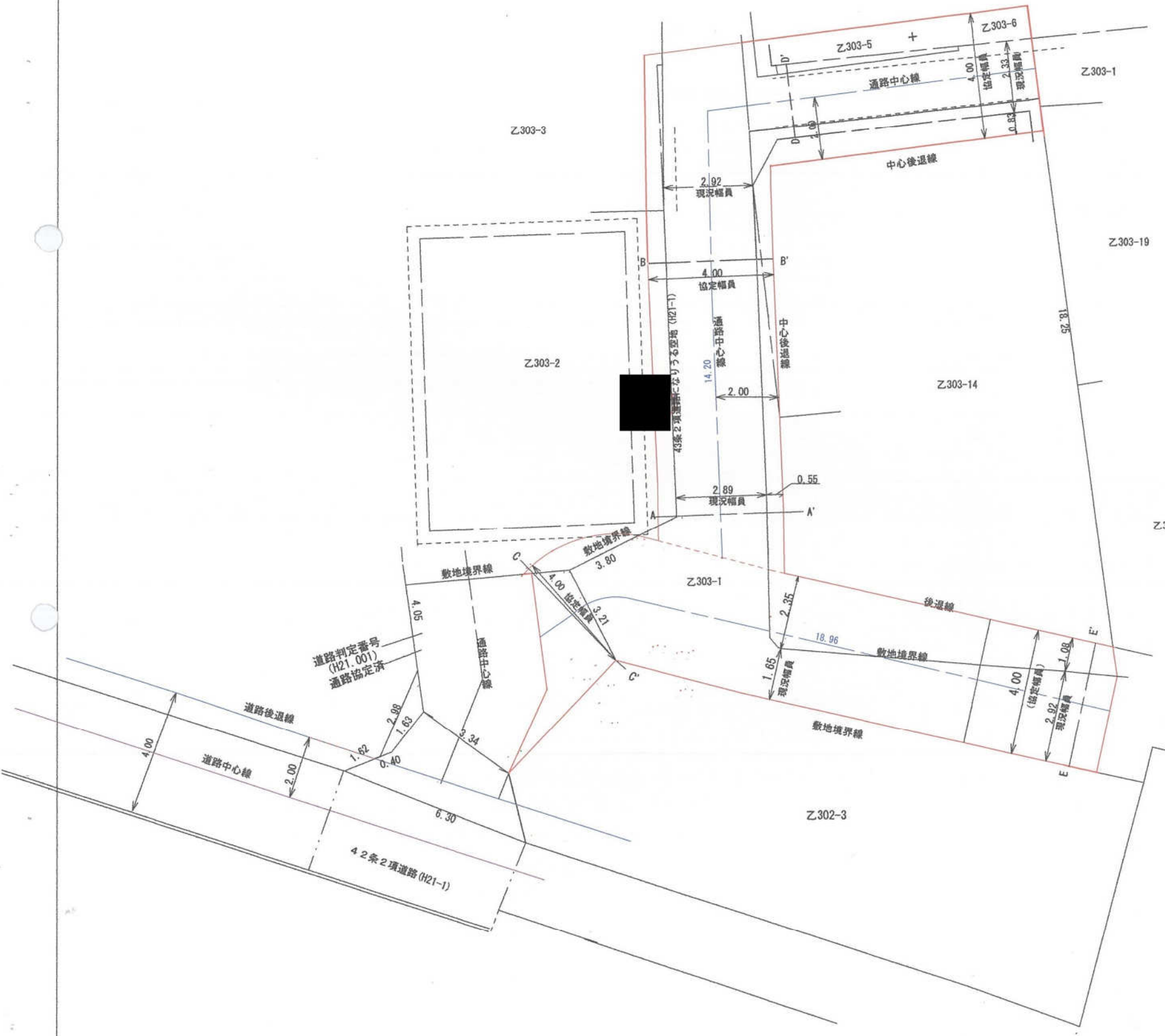

断面図

縮尺 1:100

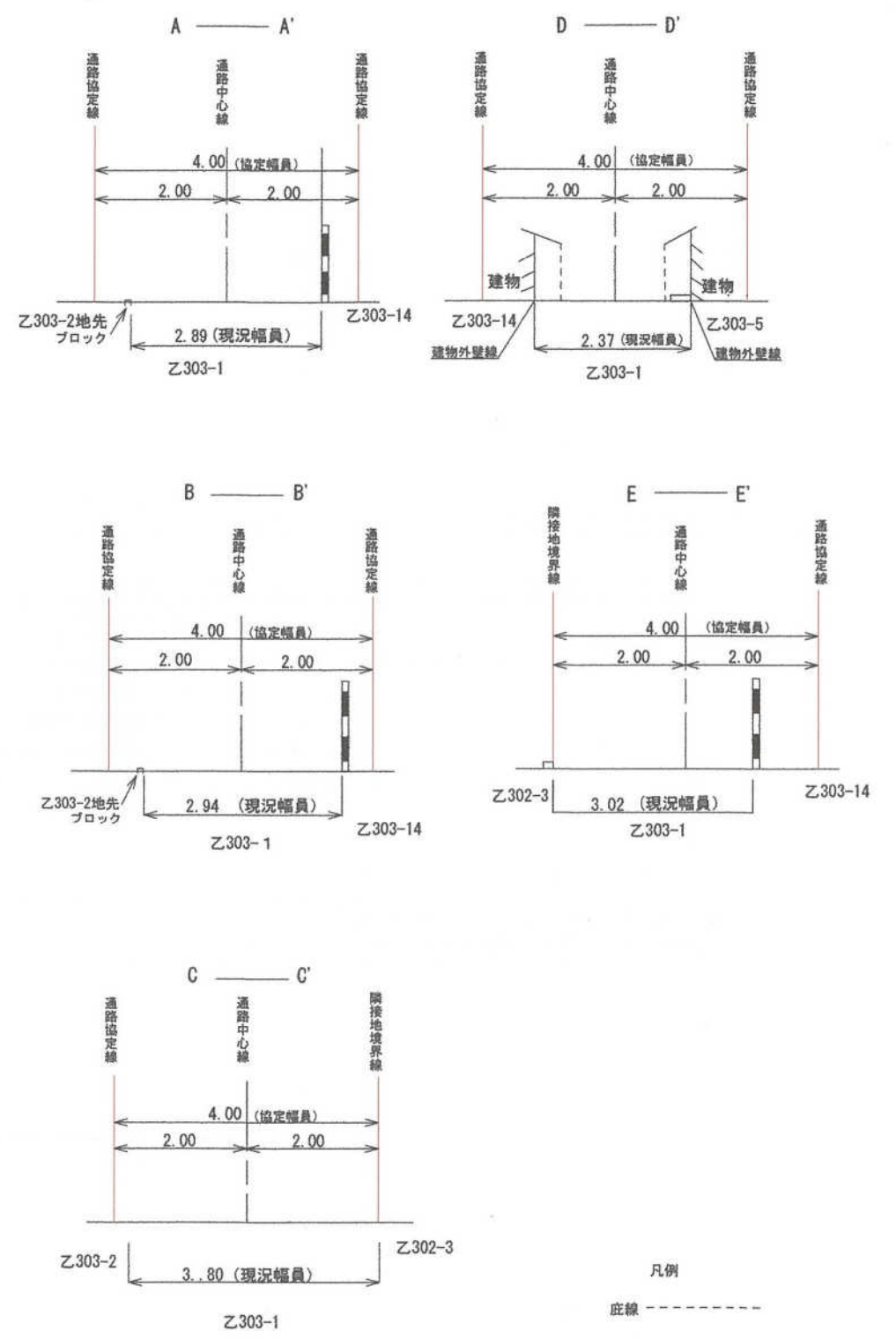

通路平面図 S=1/200

所在：姫路市飾東町庄字尾ノ下18番5他

道路判定番号：21-13

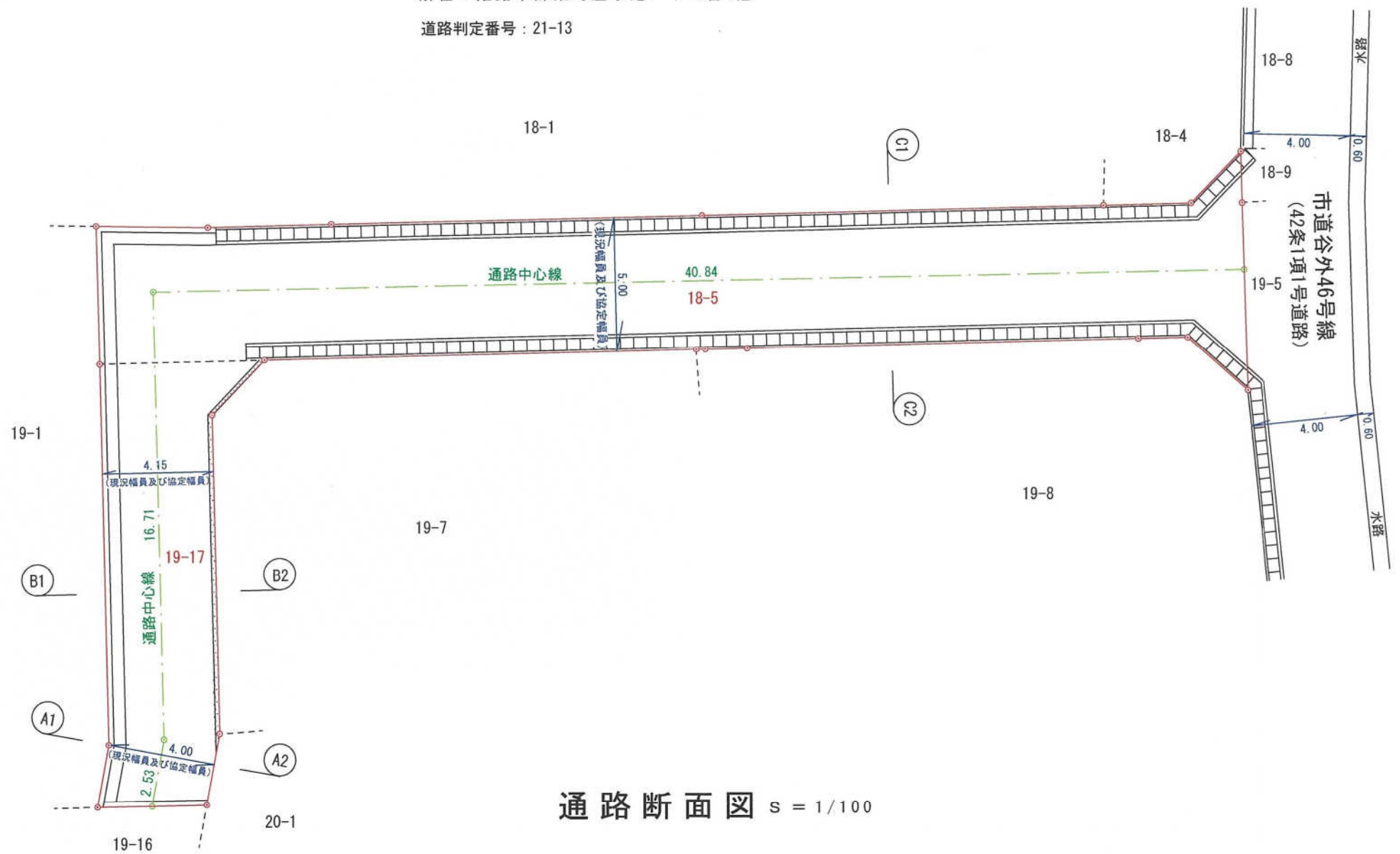

通路断面図 S = 1/100

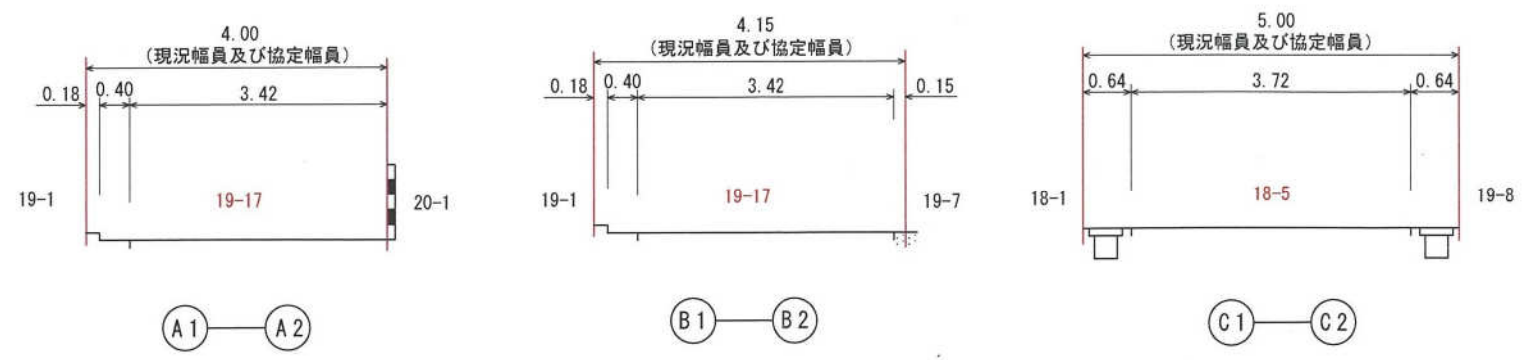

H21-014号

所在：姫路市の形町の形字鍋島

配置図

S=1:200

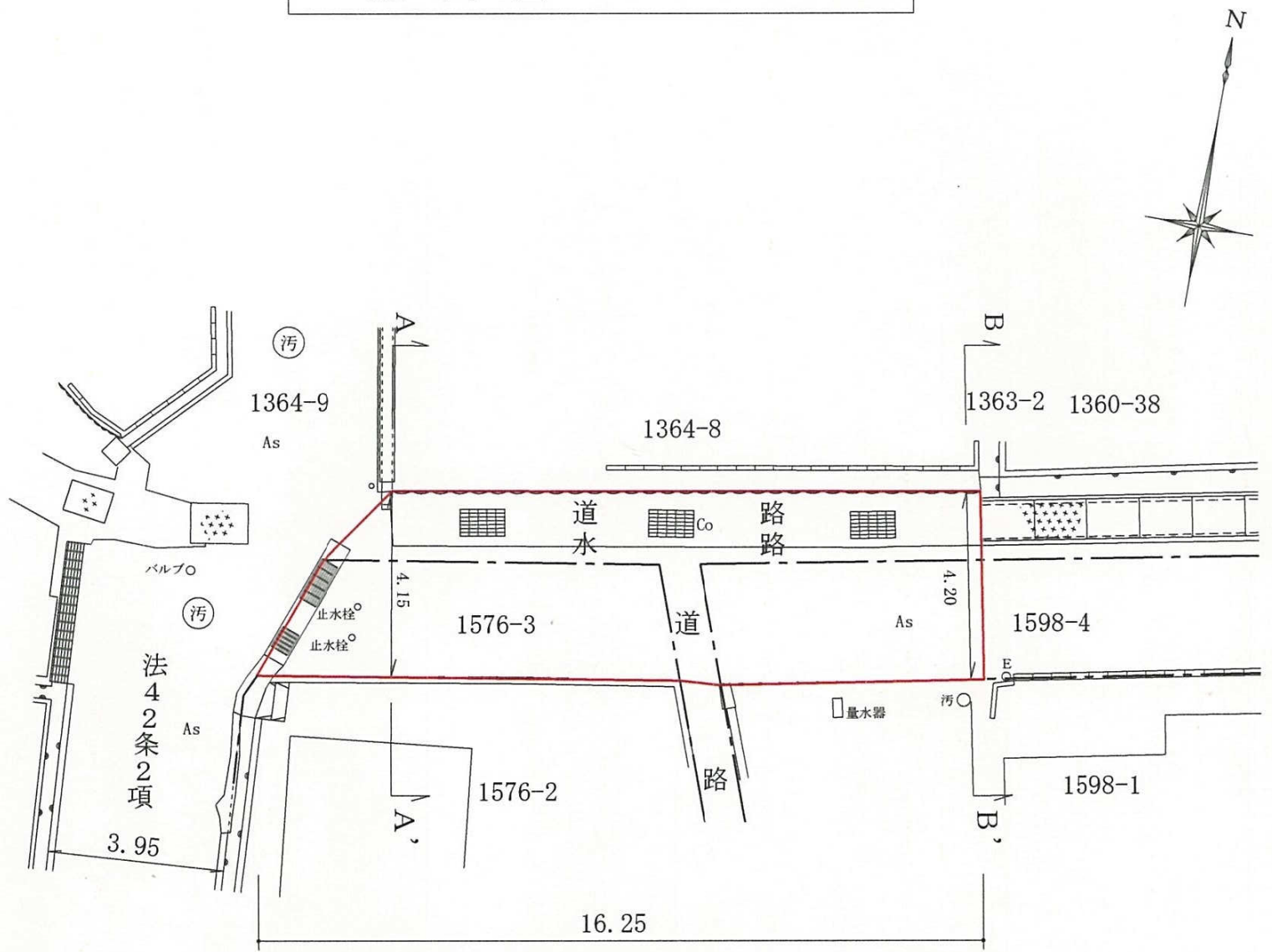

A-A' 断面図

S=1:100

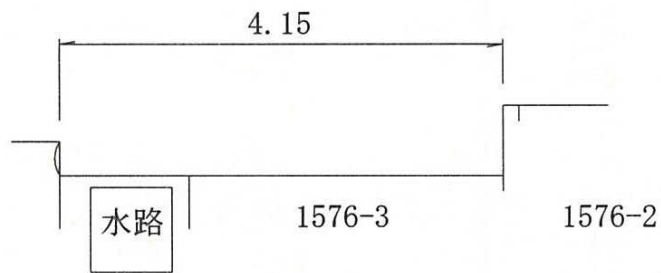

B-B' 断面図

S=1:100

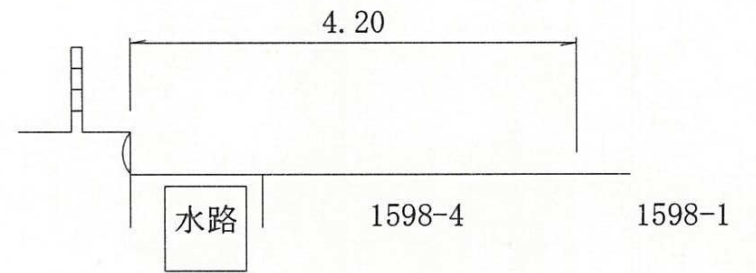

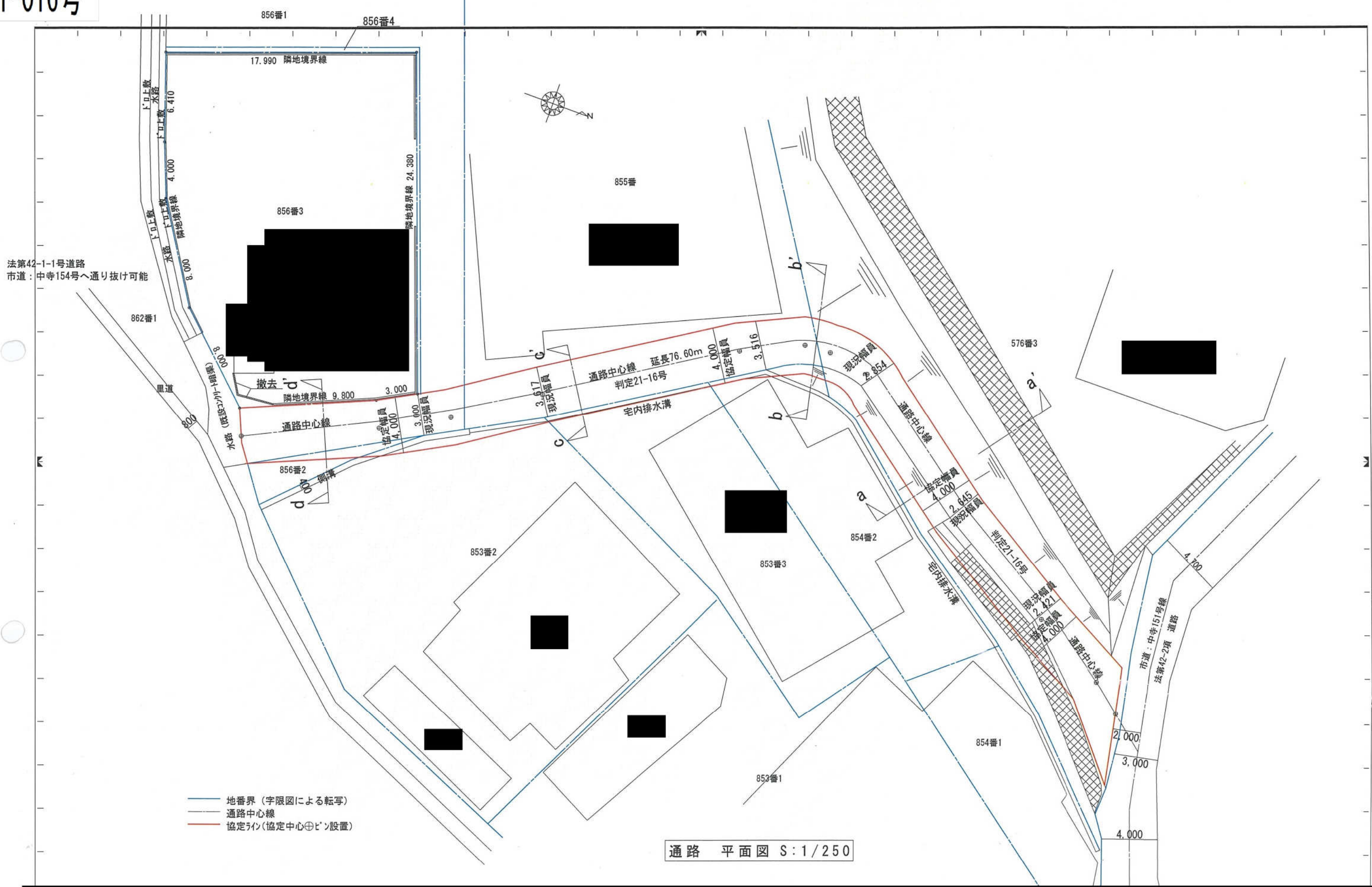

法第42-1-1号道路
市道：中寺154号へ通り抜け可能

- 地番界 (字限図による転写)
- 通路中心線
- 協定ライン (協定中心⊕ピン設置)

通路 平面図 S:1/250



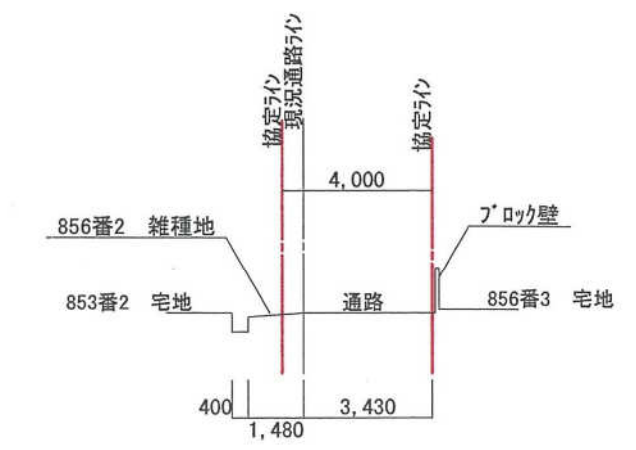
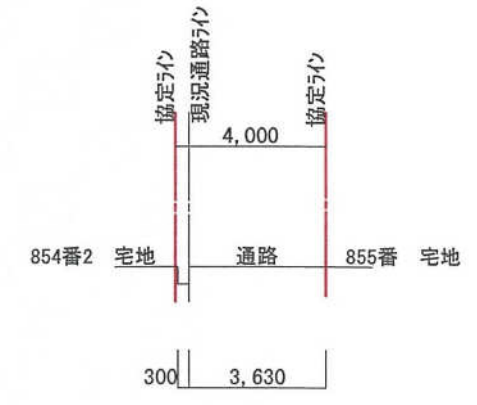
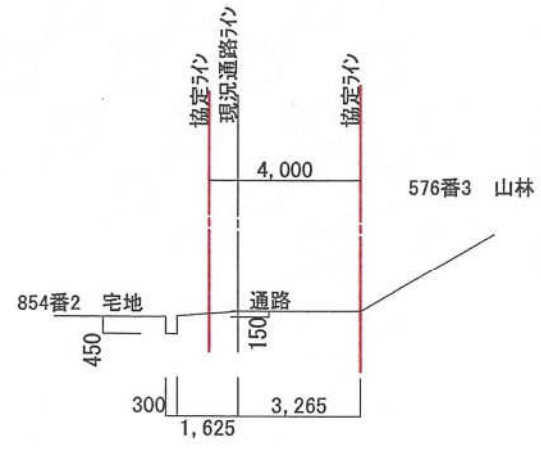
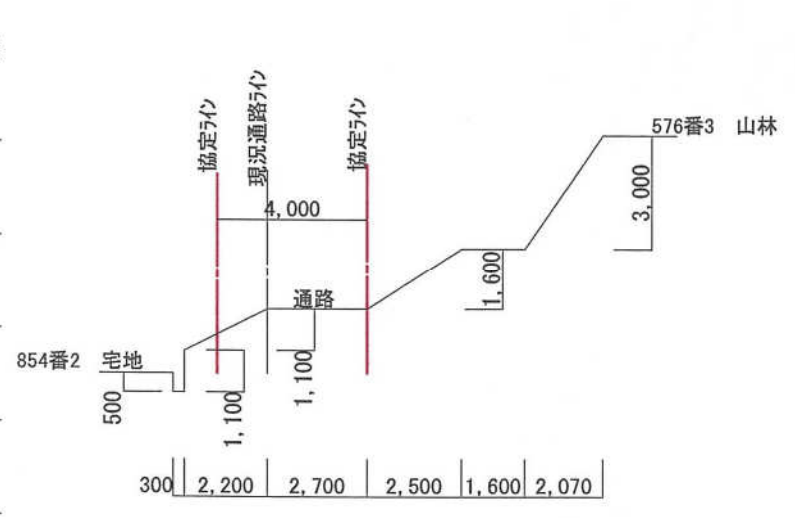
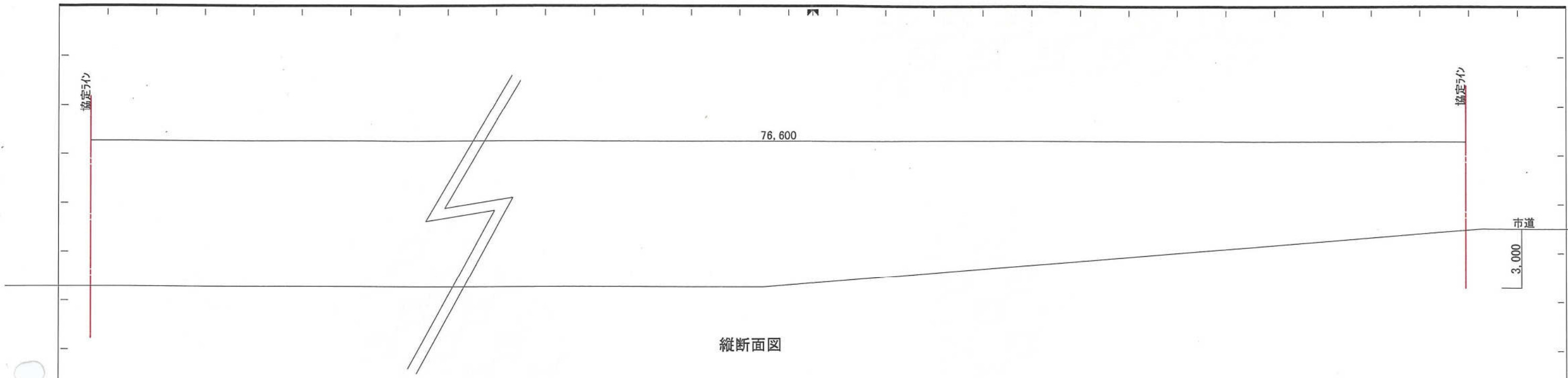

通路 断面図 S:1/200

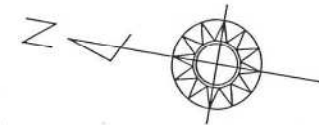

通路協定 平面図

S=1:100

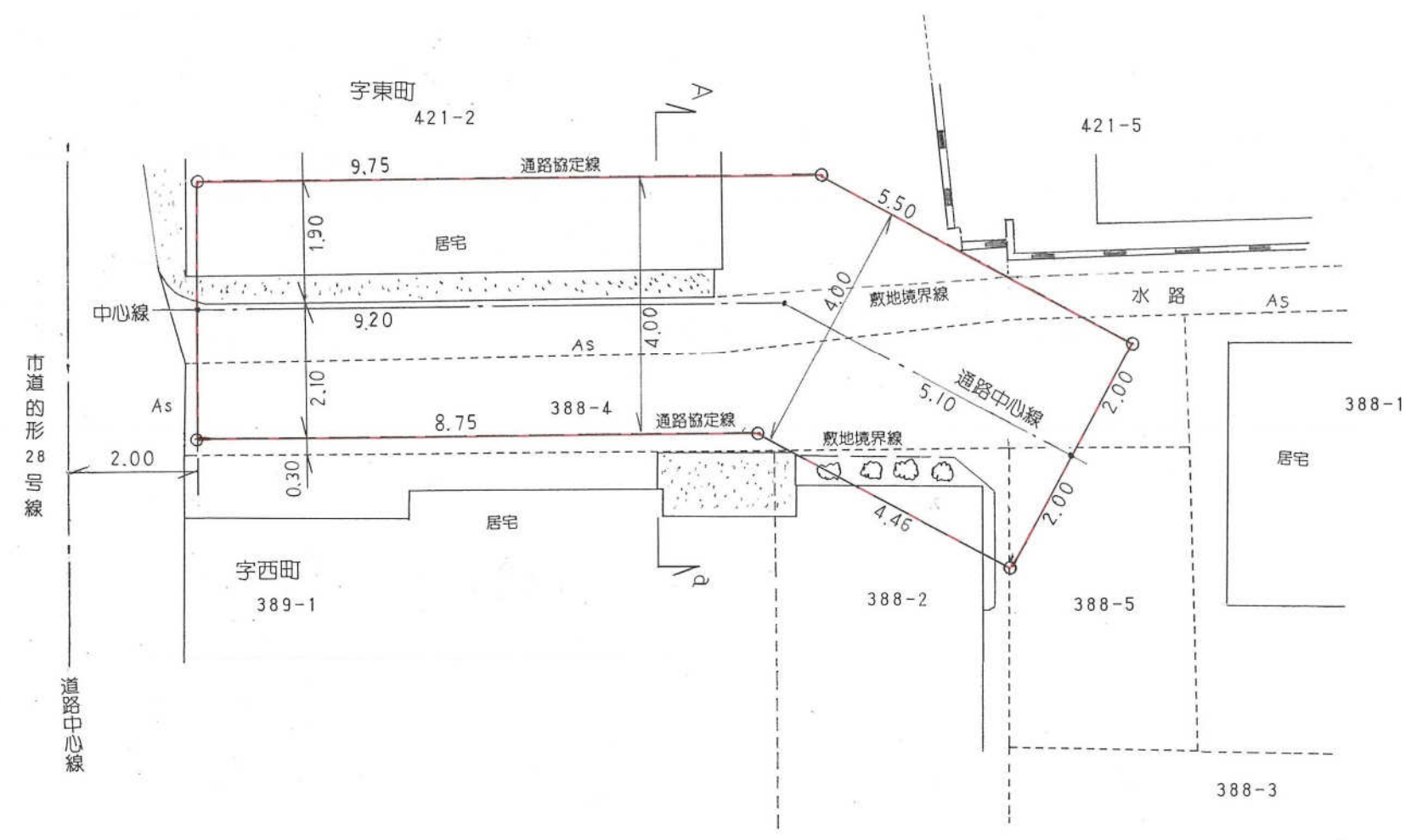

A-a 断面 S=1:100

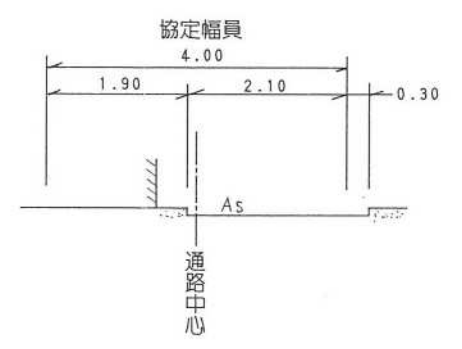



配置図 1 : 200

42条 1 項 5 号
位置指定道路
指定番号 3-7

566-1

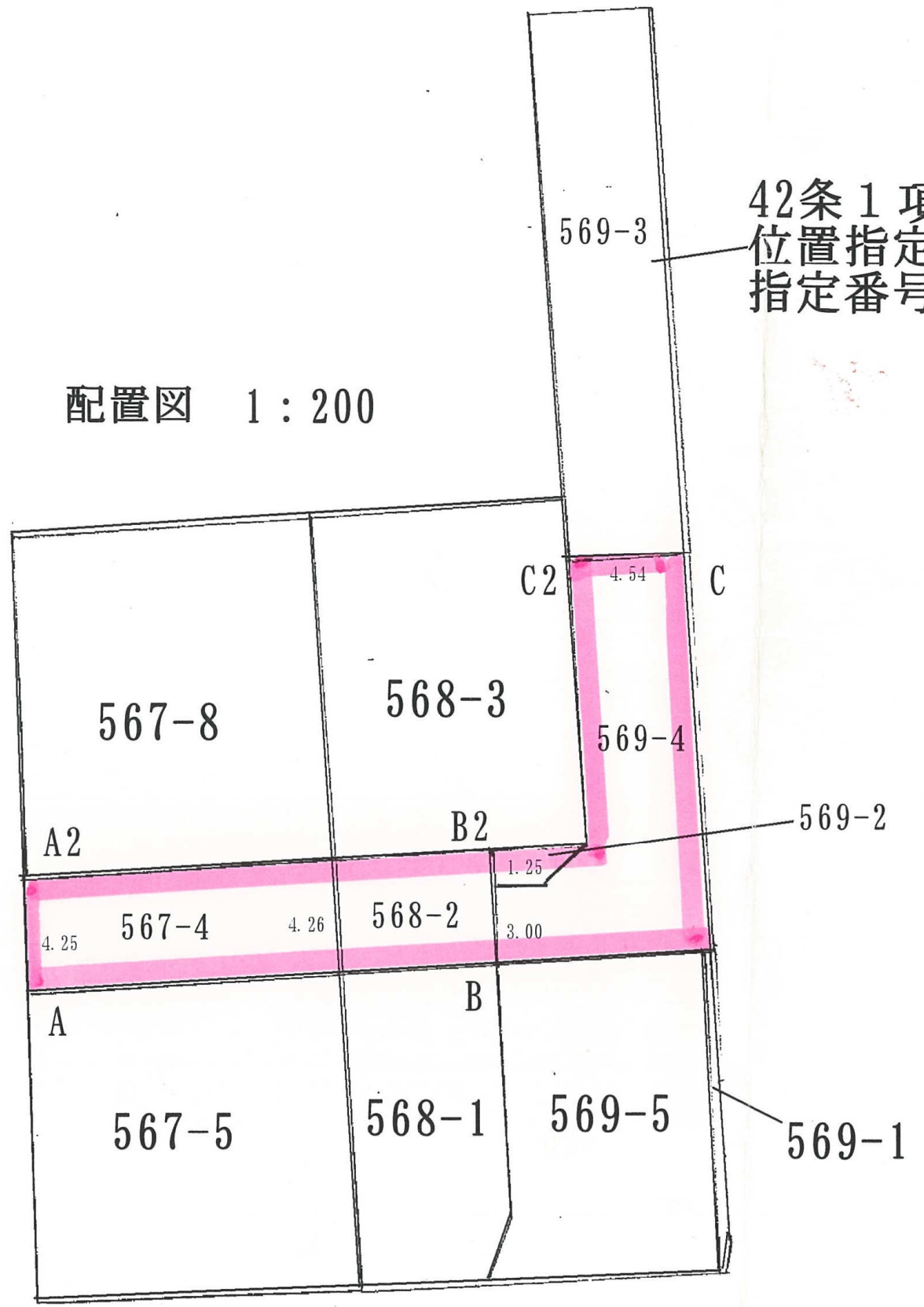

道路断面图

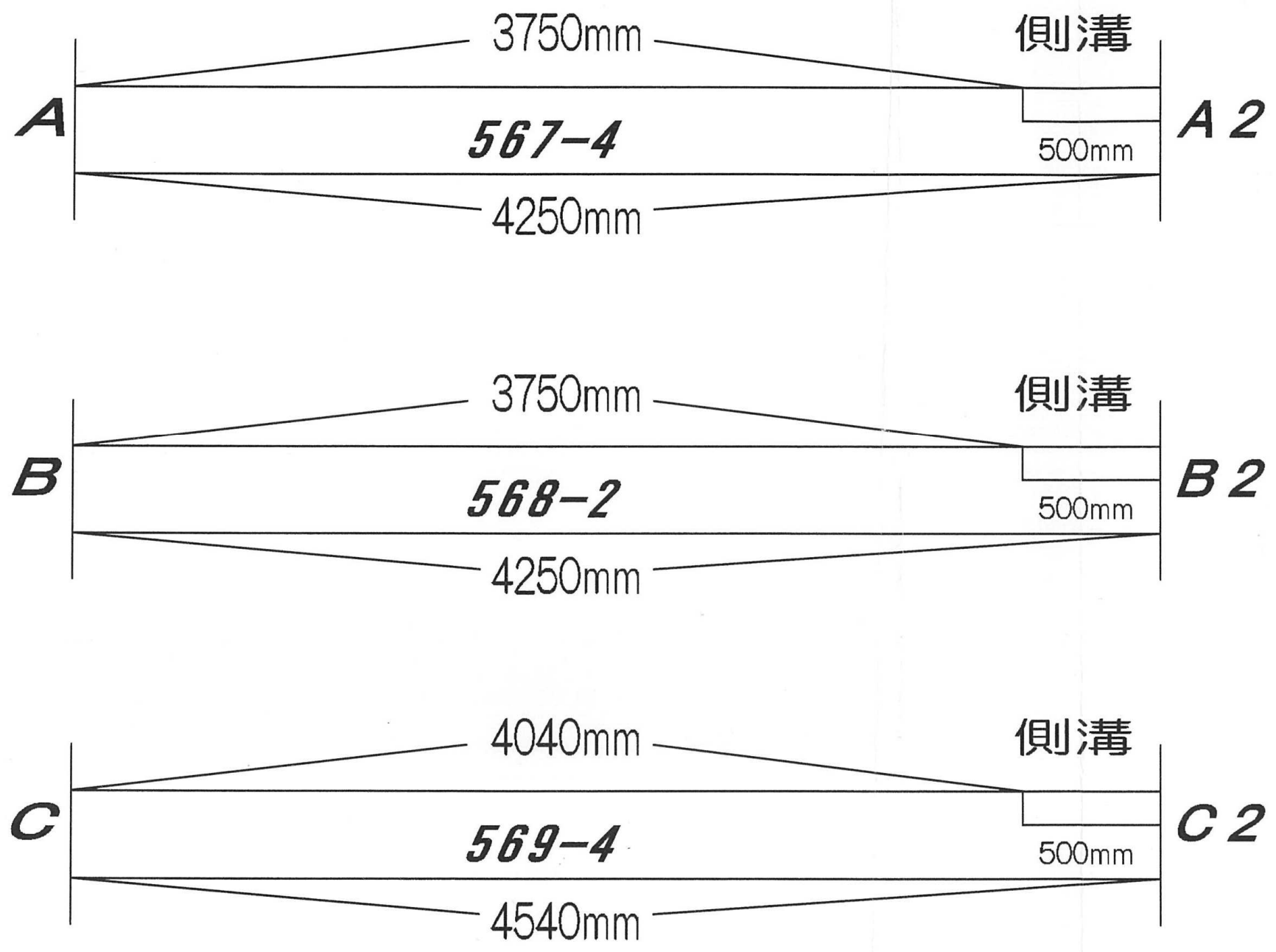

道路図 縮尺=1/200

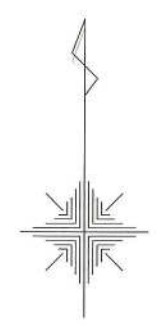

断面図

縮尺=1/100

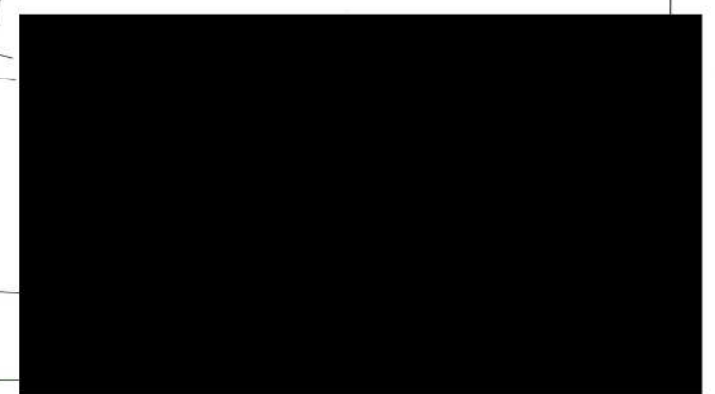
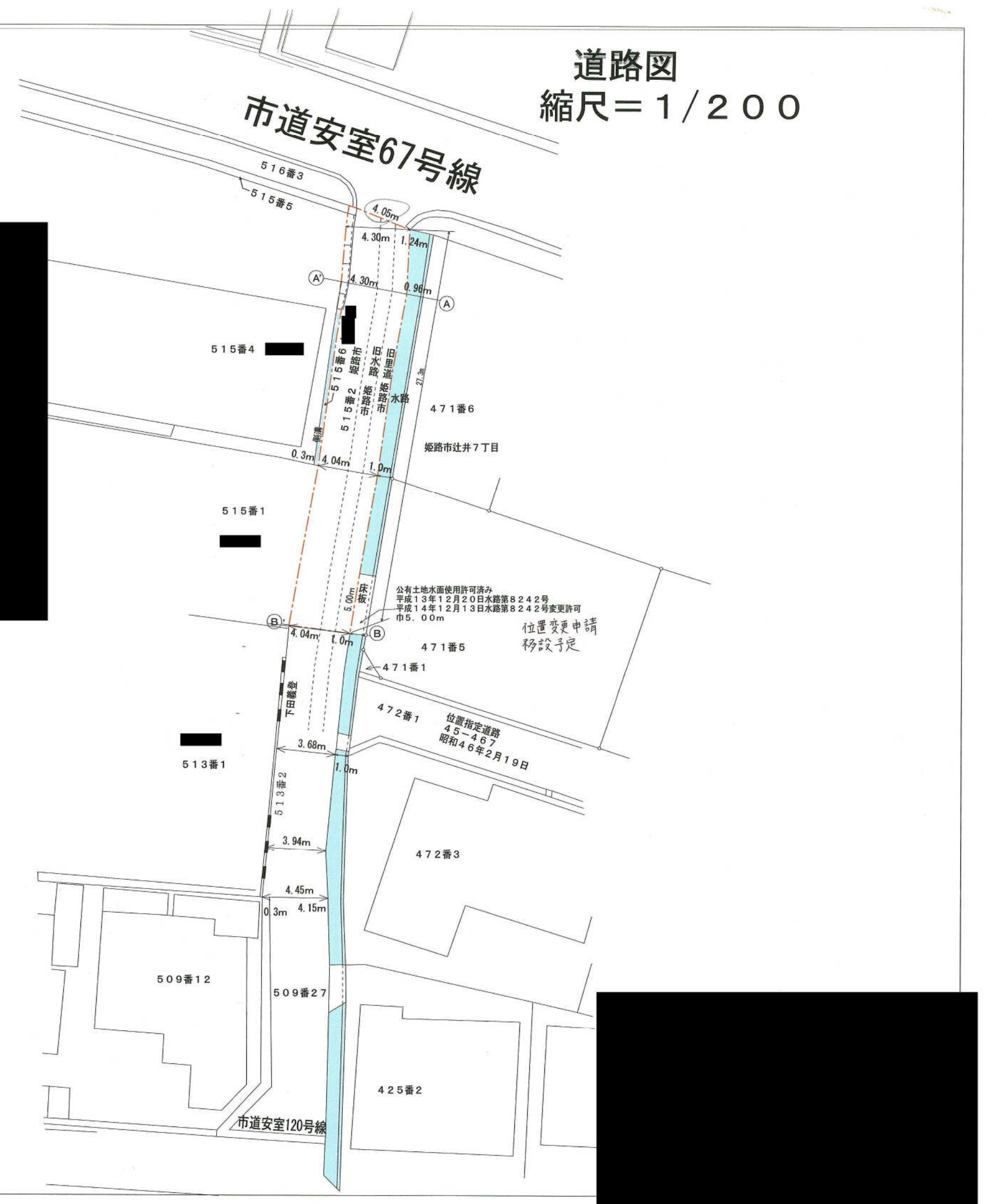
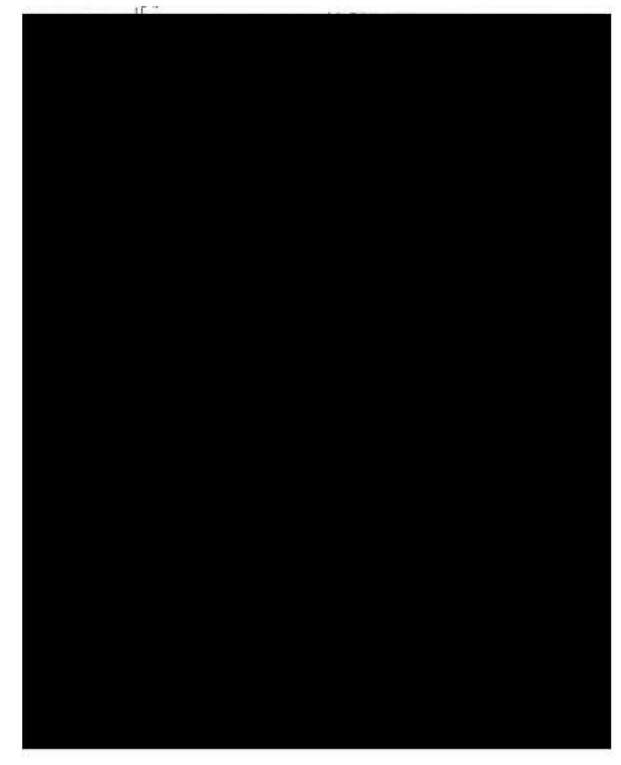
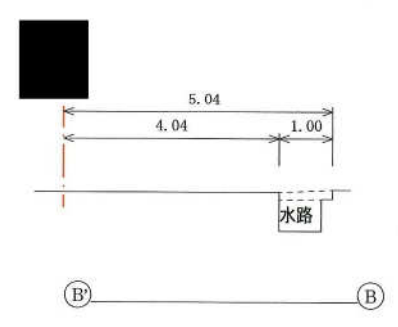
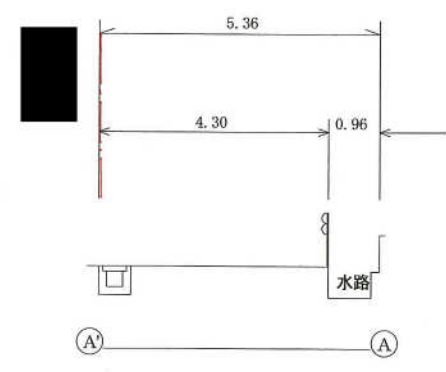

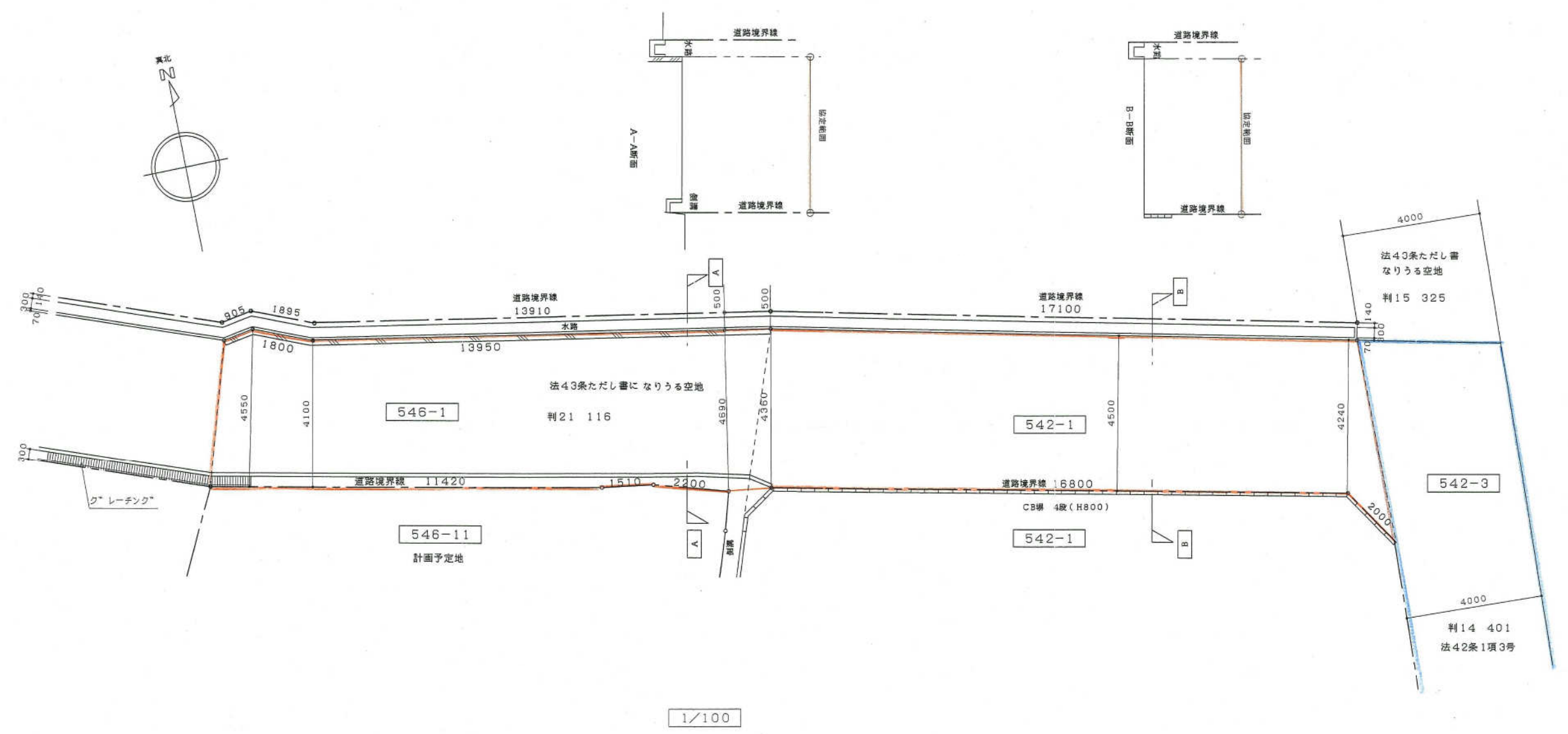

道路協定図

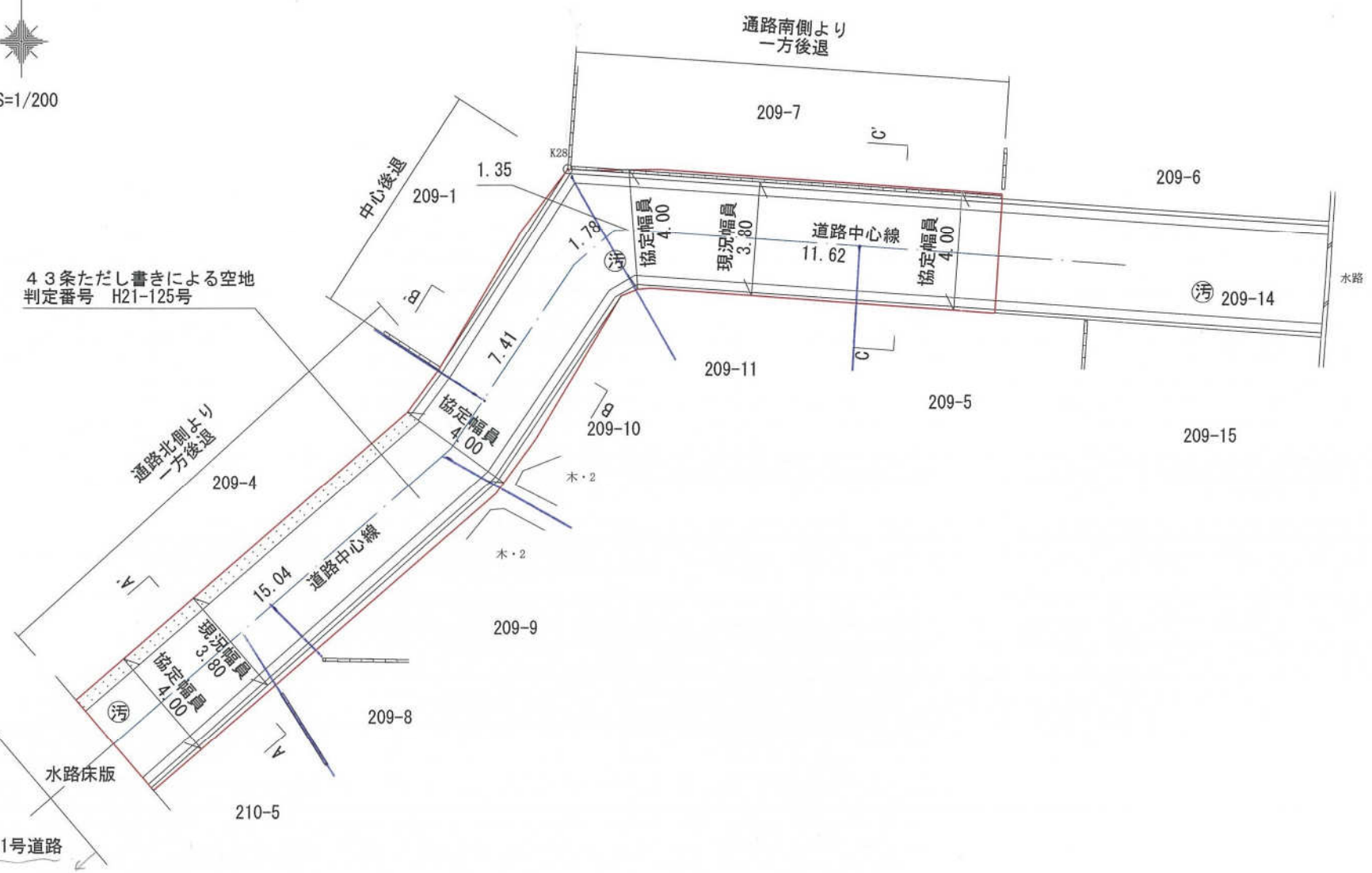

断面図

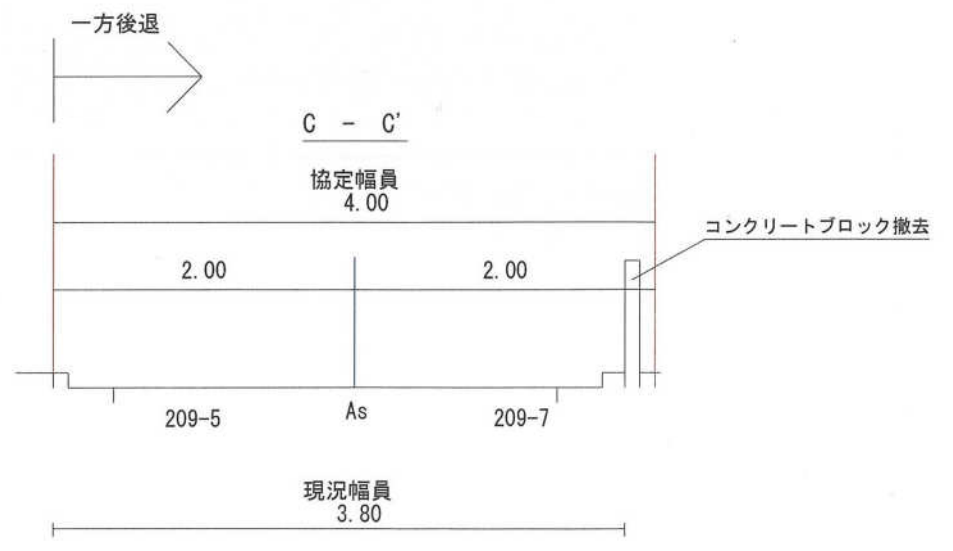
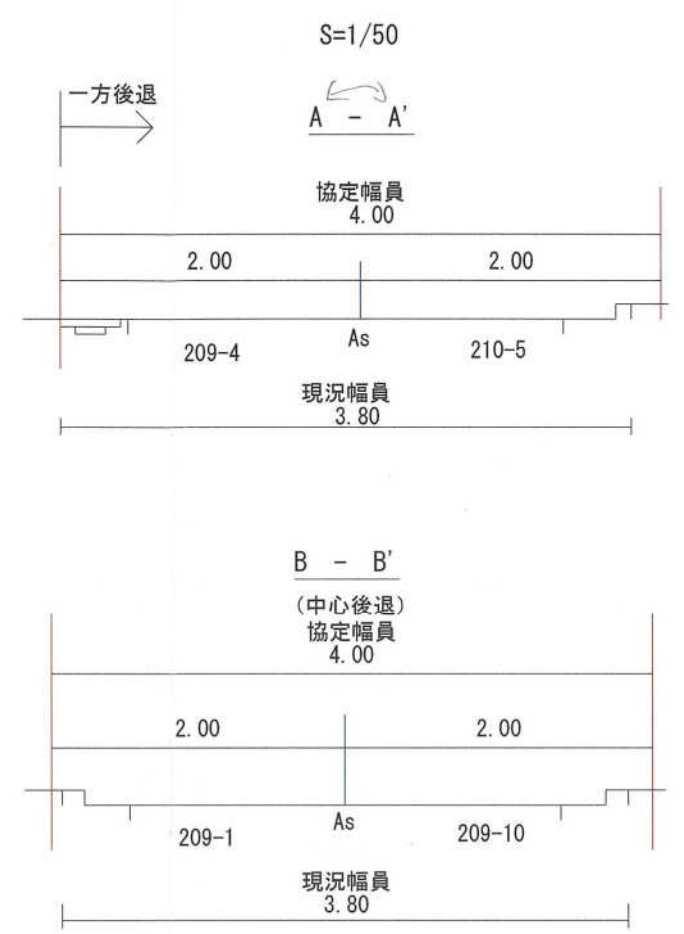

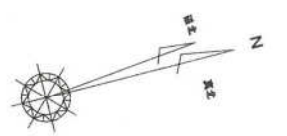

43条但し書き許可申請範囲
約42.20m
判定番号 H21-138号

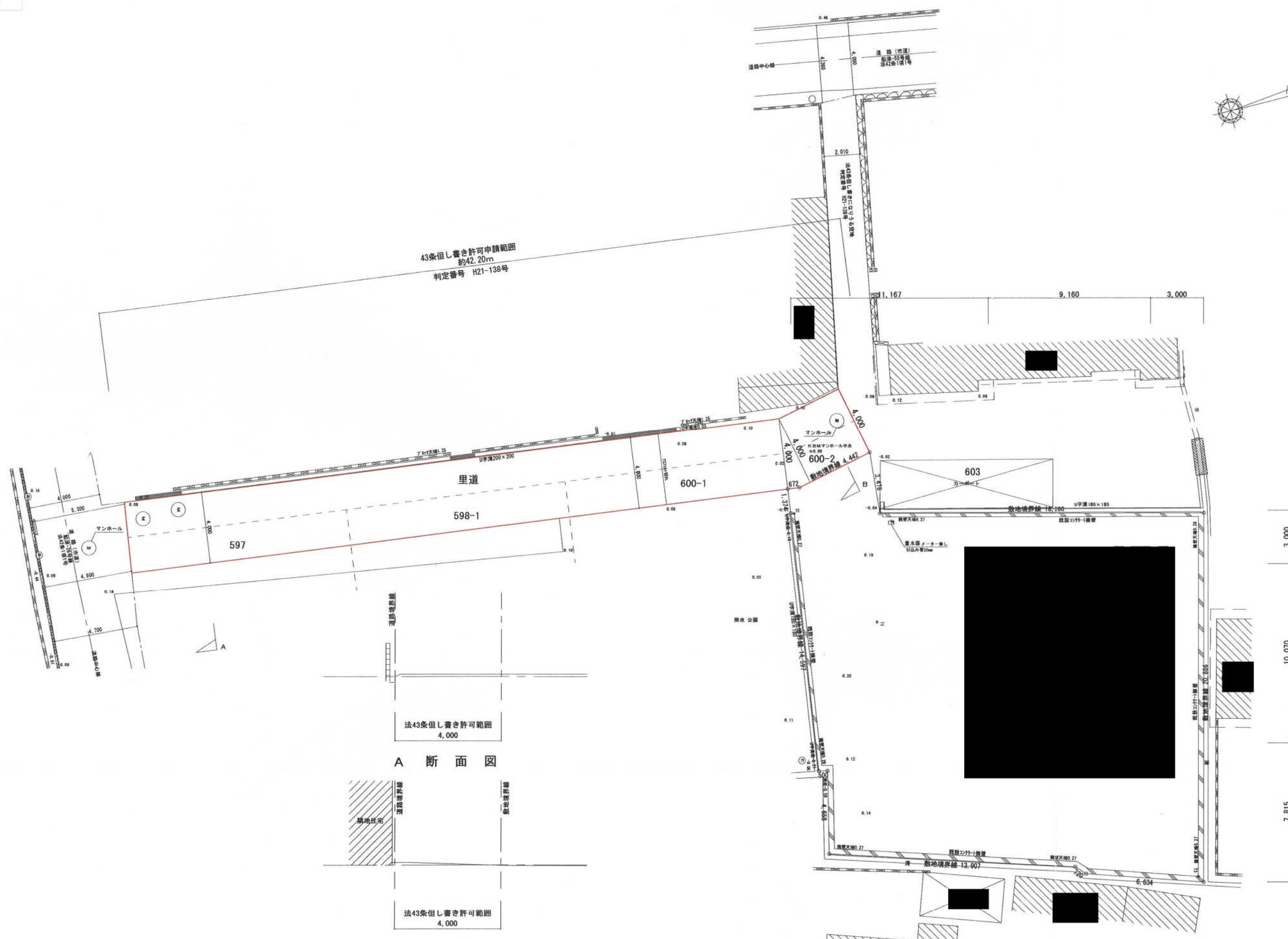

A

法43条但し書き許可範囲
4,000

A 断面図

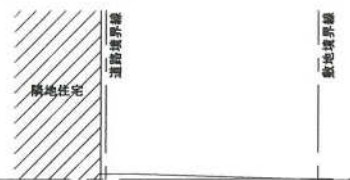

法43条但し書き許可範囲
4,000

B 断面図

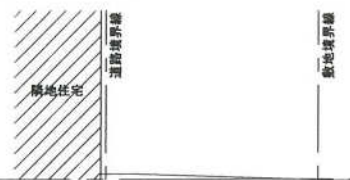

3,000
10,070
7,815

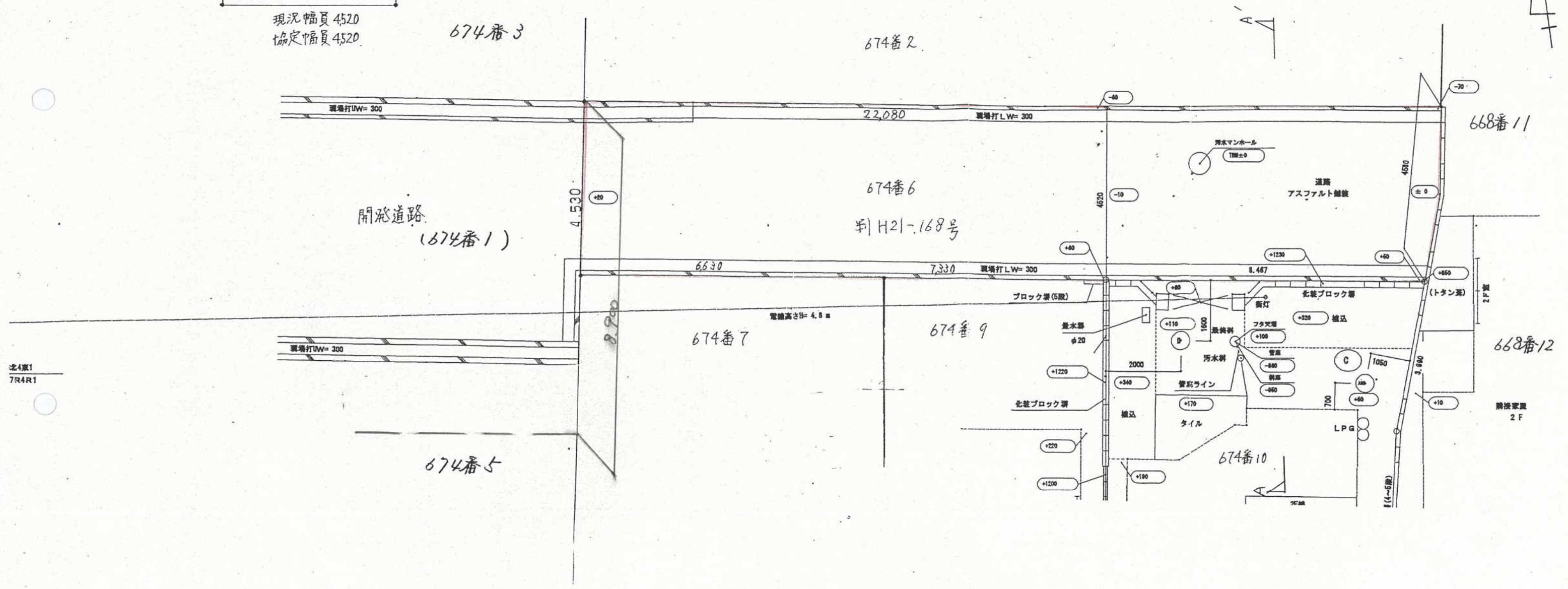

国道312号線
法4.2条1項1号

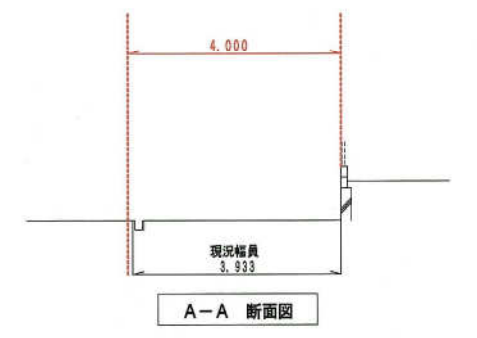
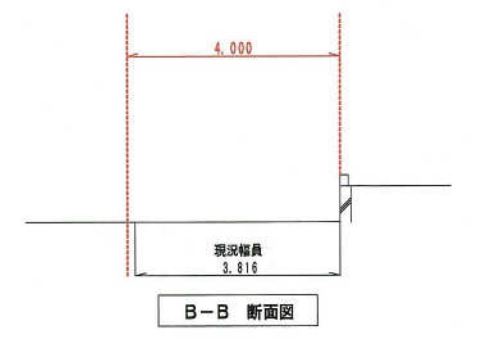
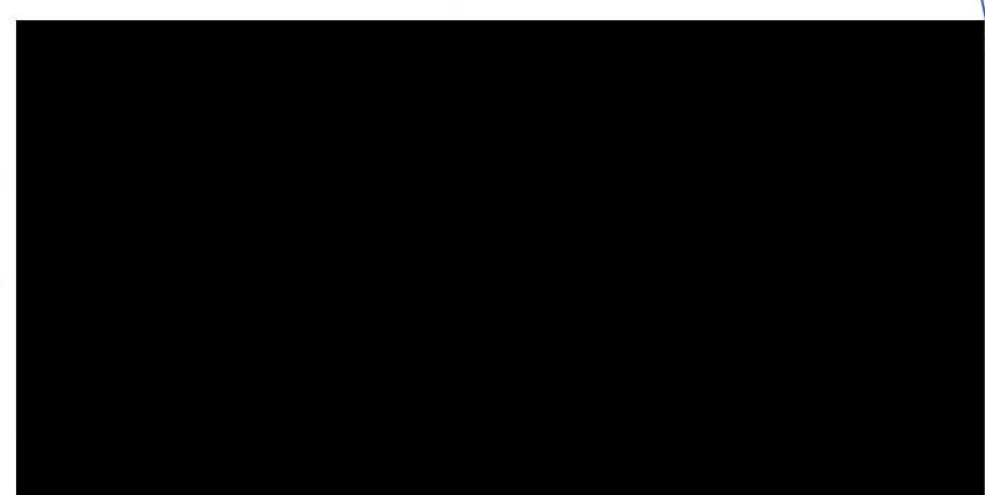
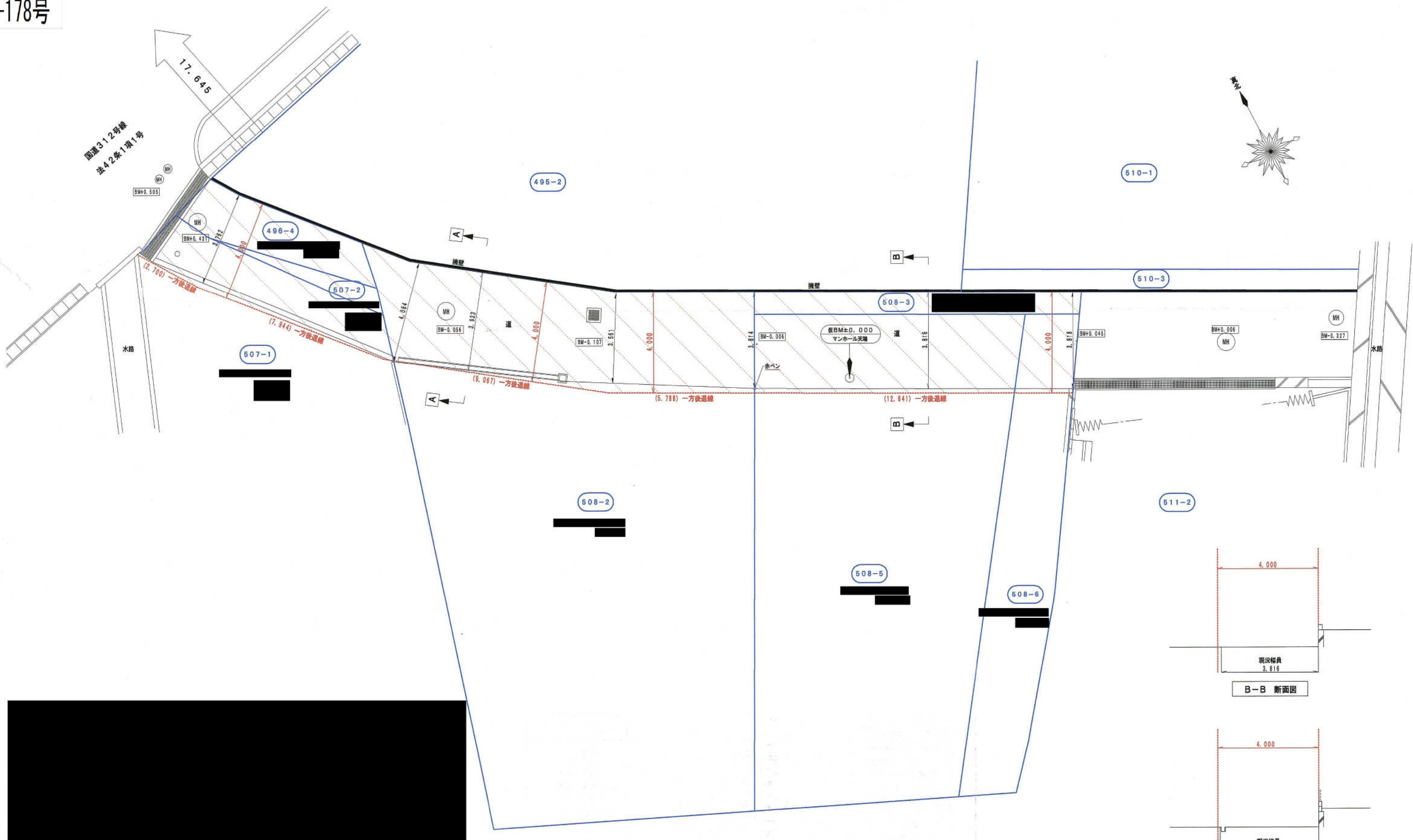

断面図

S=1/100M

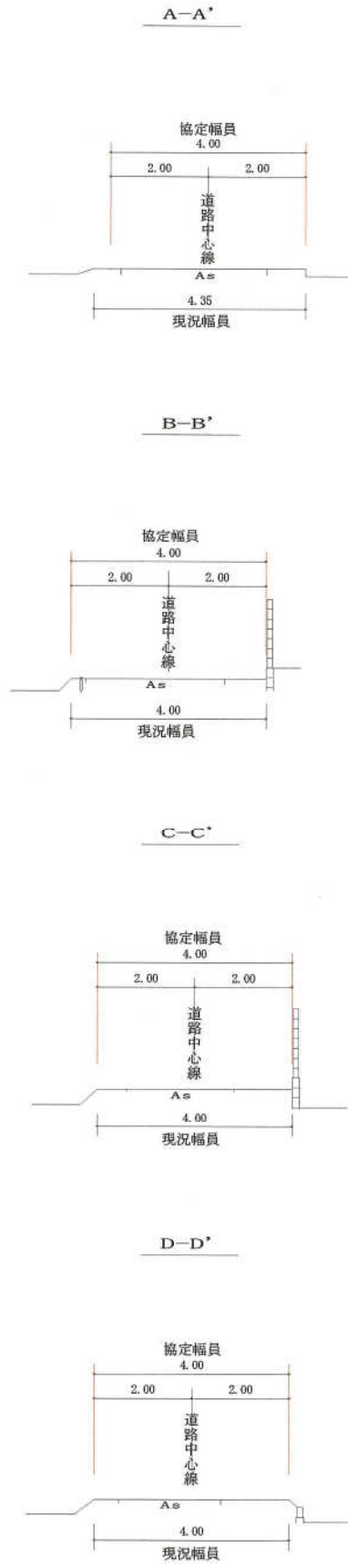

平面図

S=1/200M

