

通路平面图

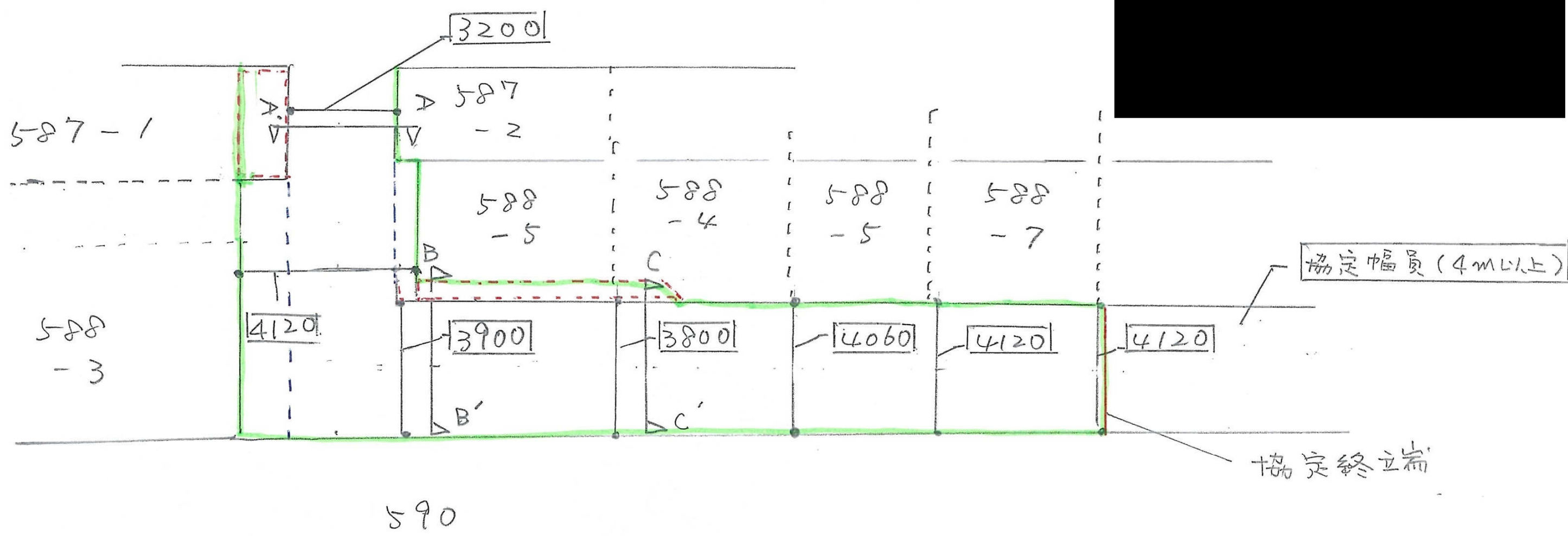

[A-A' 断面圖]

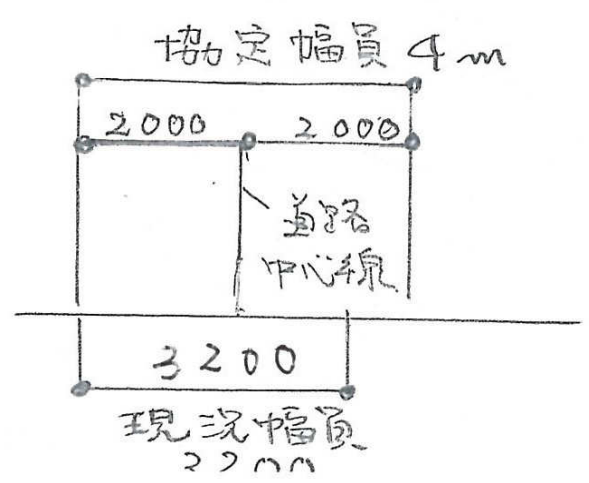

[B-B' 断面圖]

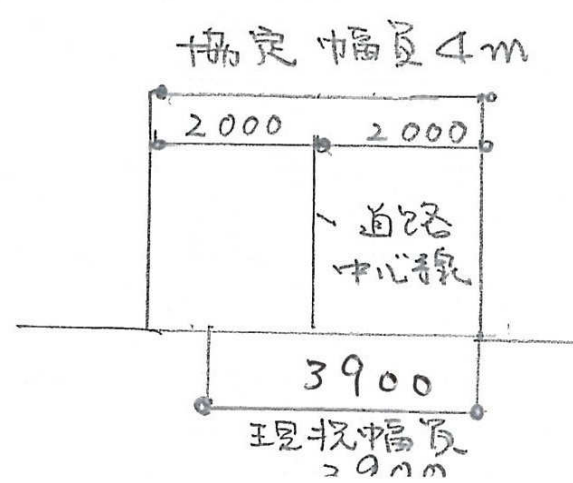

[C-C' 断面圖]

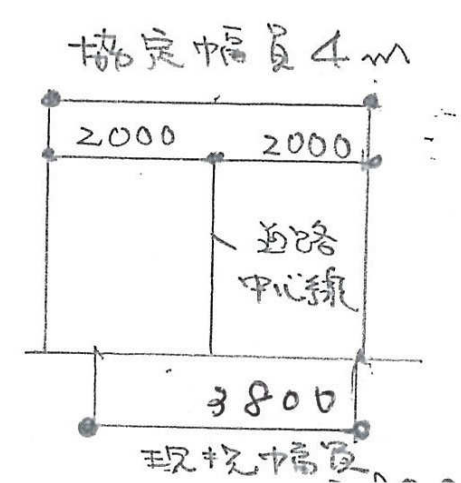

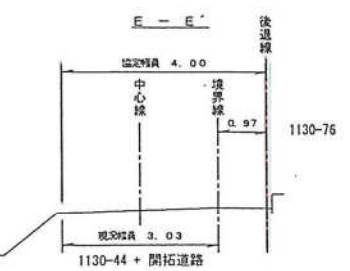
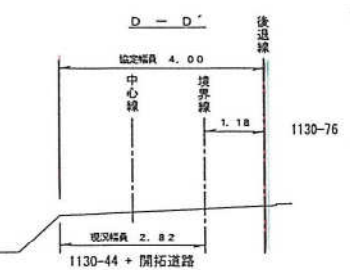
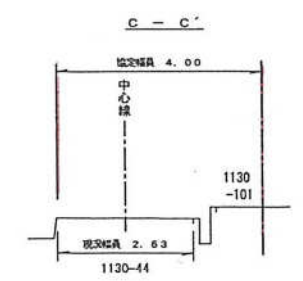
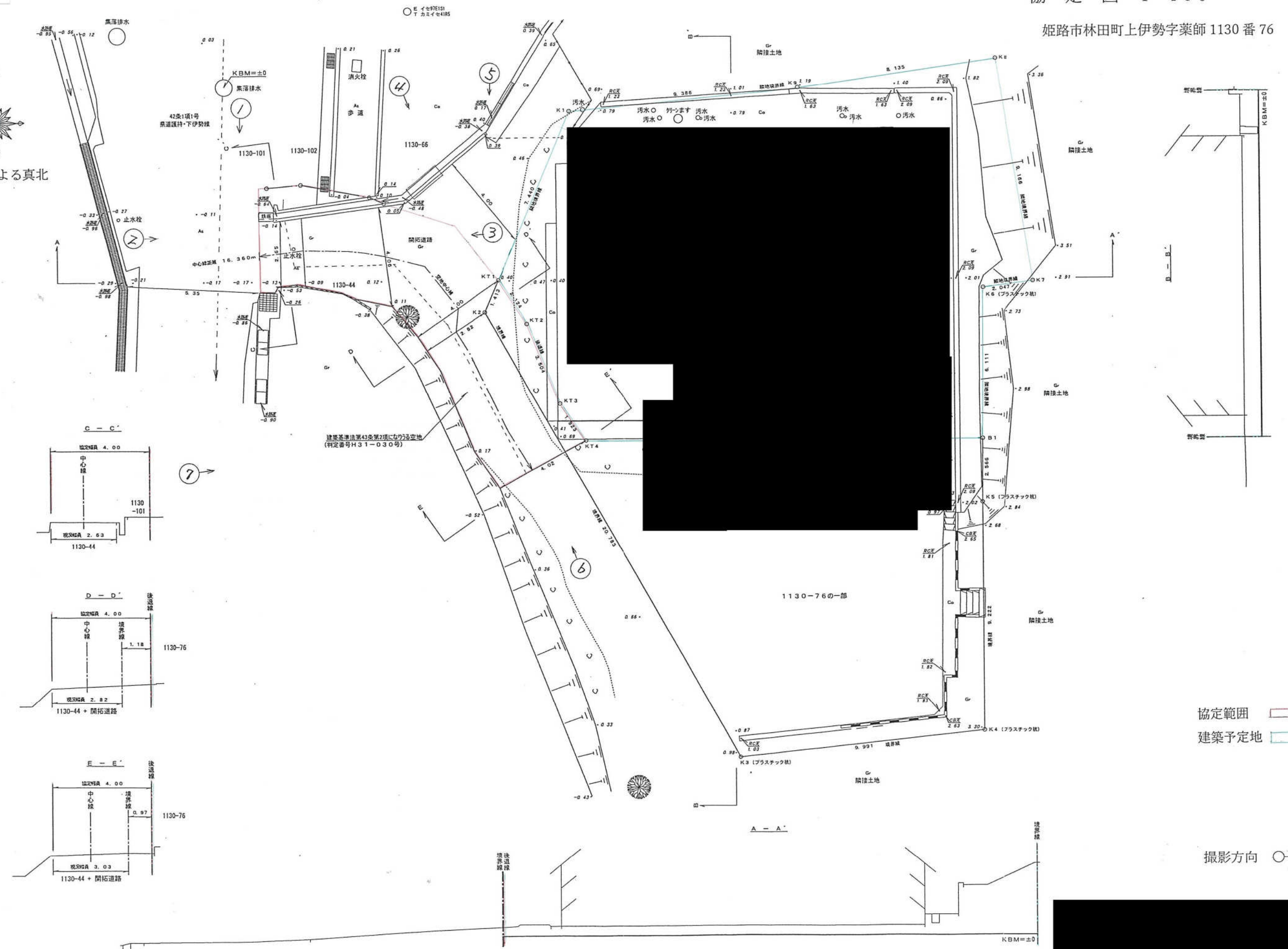

協定範囲 [Red outline]
建築予定地 [Blue outline]

撮影方向 [Arrow pointing right]

建築基準法第43条第2項に於ける空地
(判定番号H31-030号)

1130-76の一部

KBM=±0

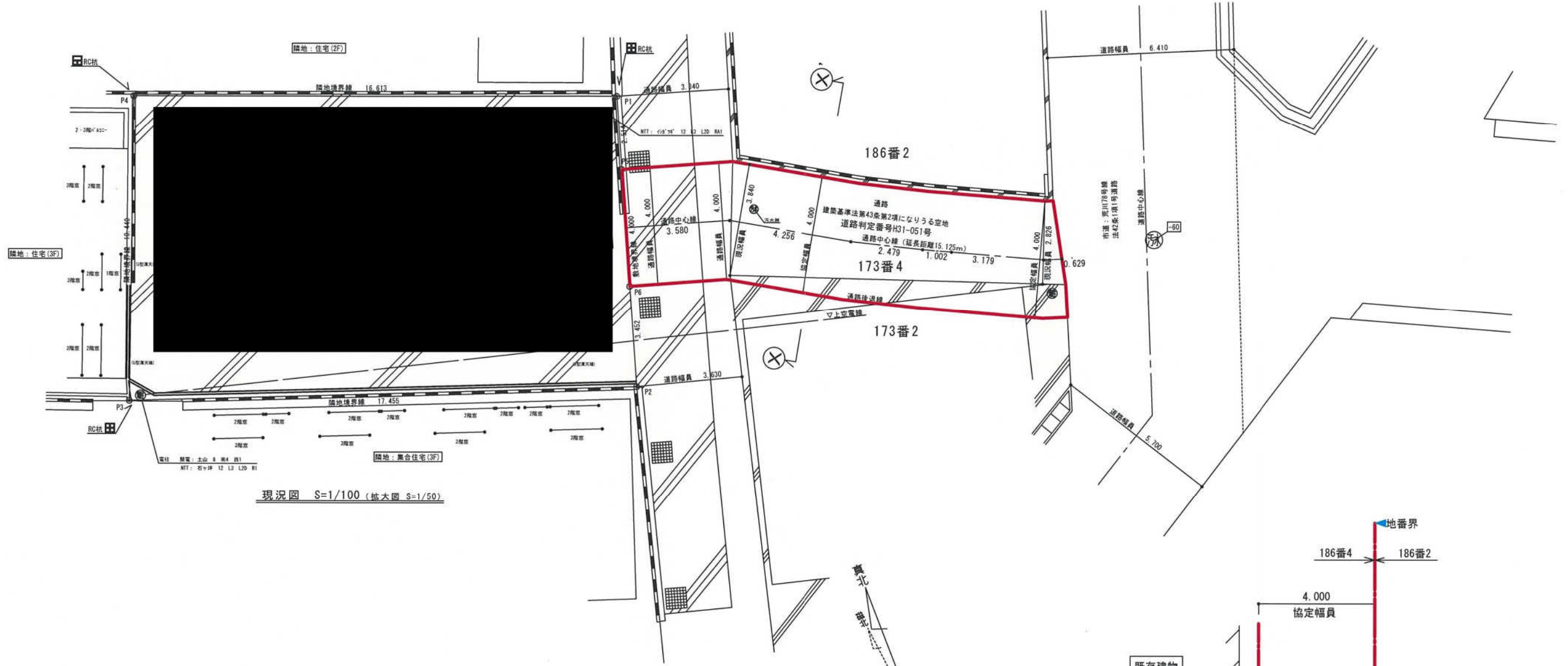

現況図 S=1/100 (縮大図 S=1/50)

通路平面図 S=1/150

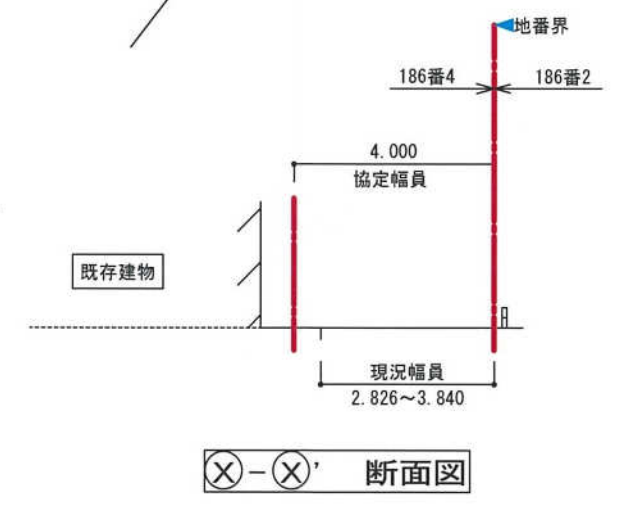

断面図

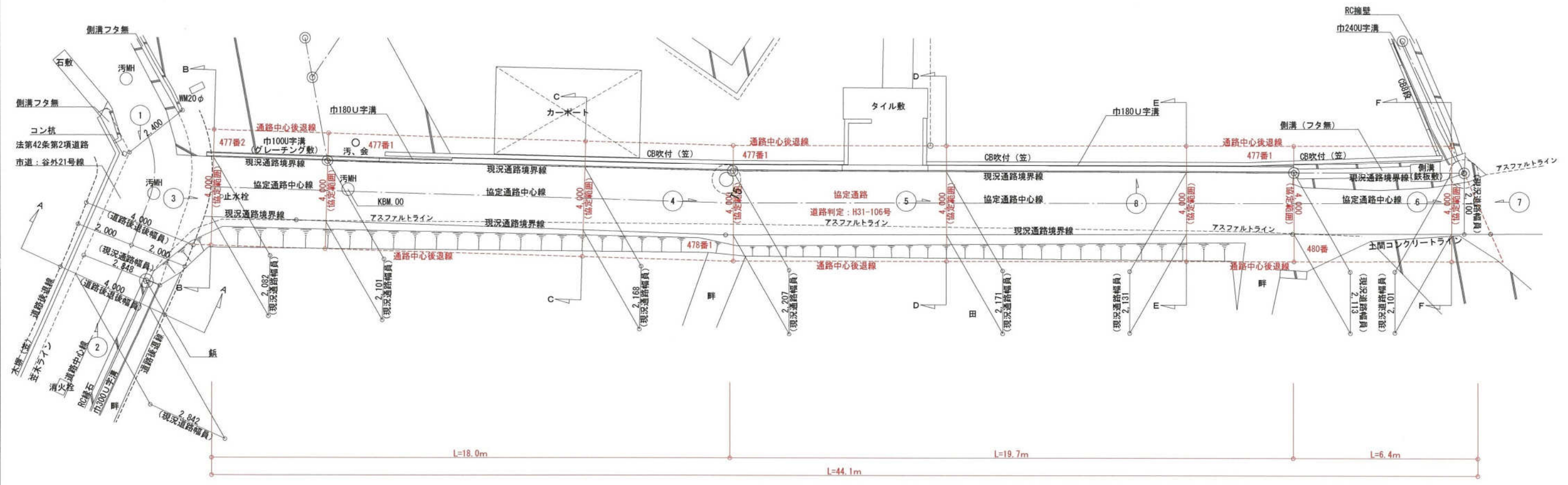

通路平面図 S=1:141

* 本協定図は、境界を確定するものではありません。

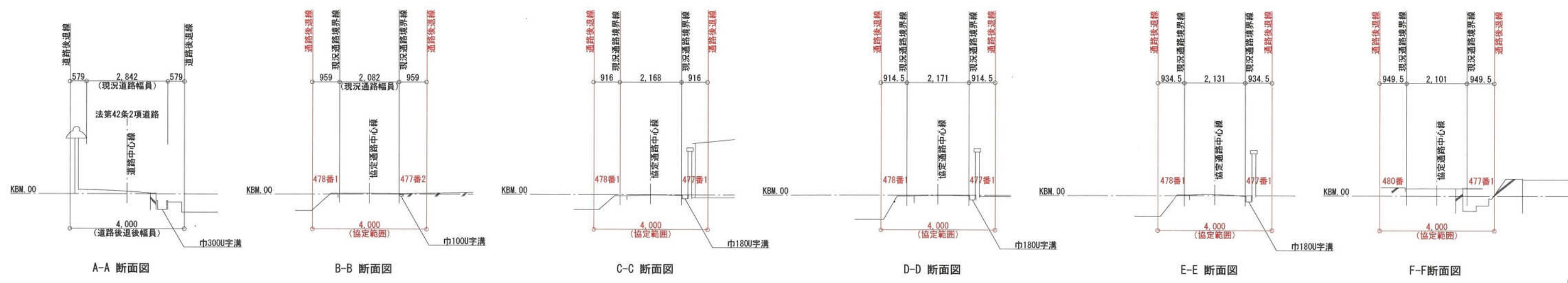

通路断面図 S=1:141

通路協定延長距離 33,462

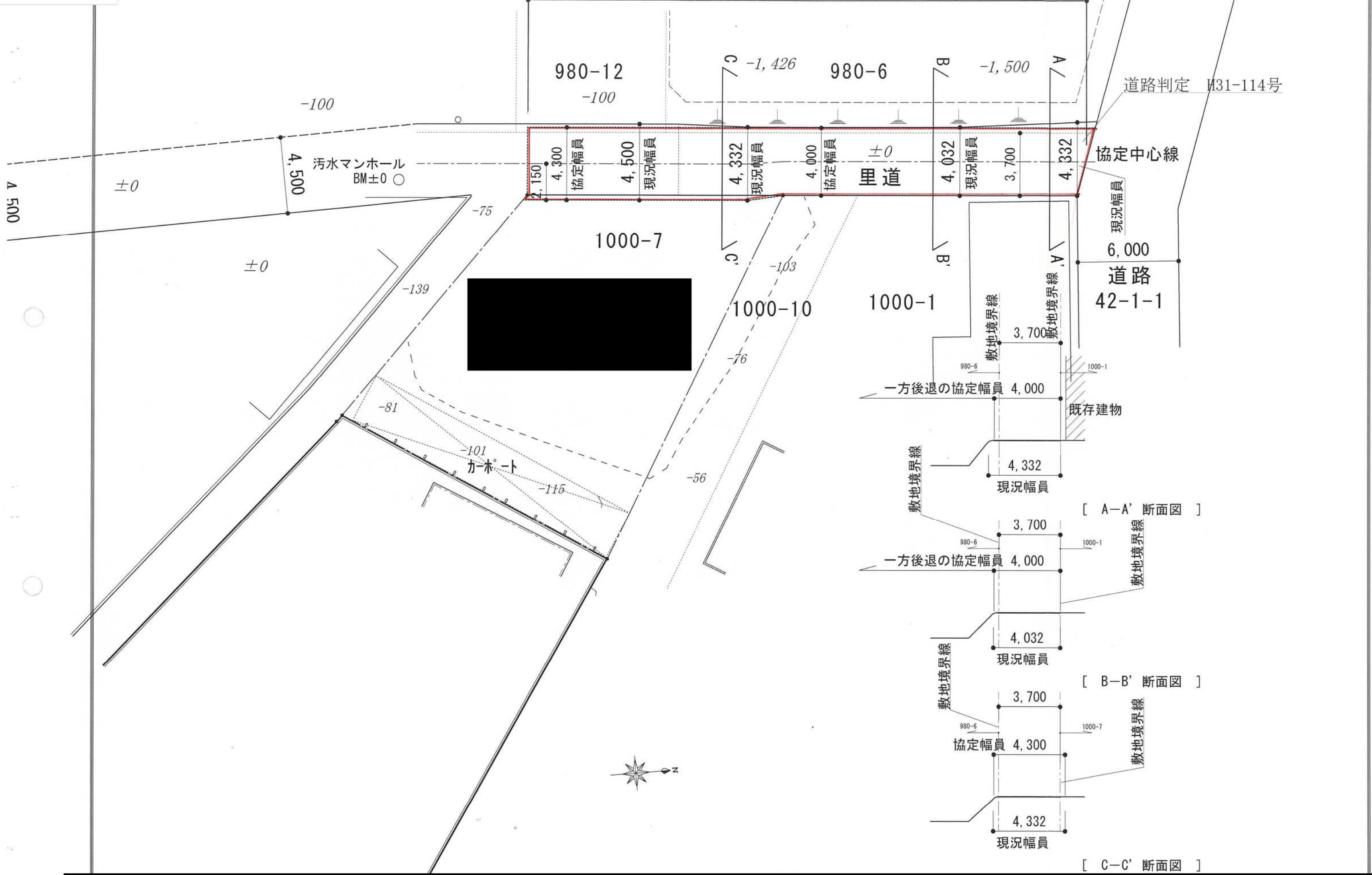

[A-A' 断面図]

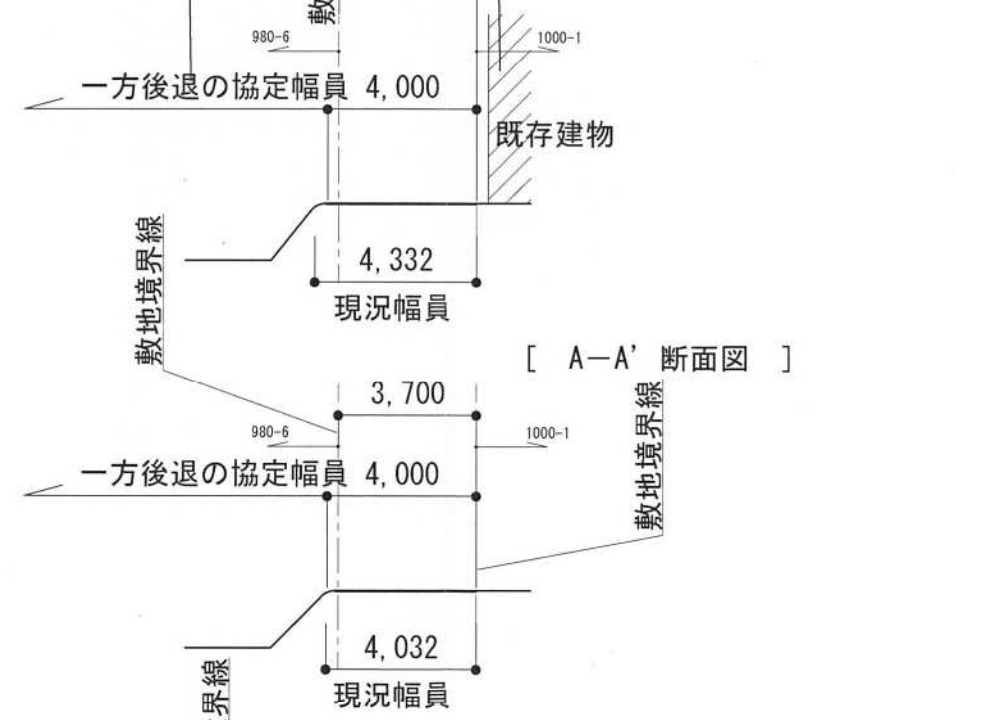

[B-B' 断面図]

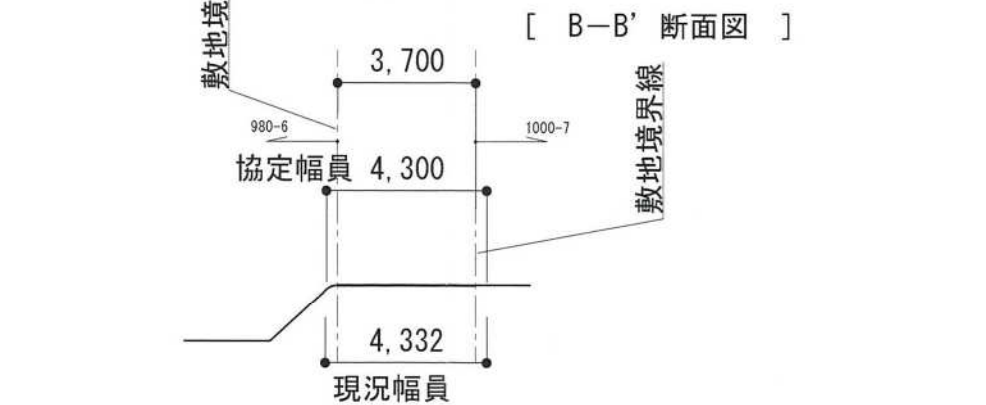

[C-C' 断面図]

H31-156号

姫路市大塩町844番1
通路平面図

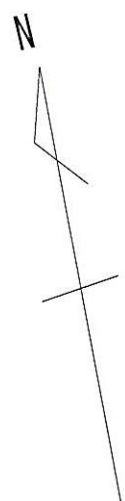

通路延長 (最短) 44.37m

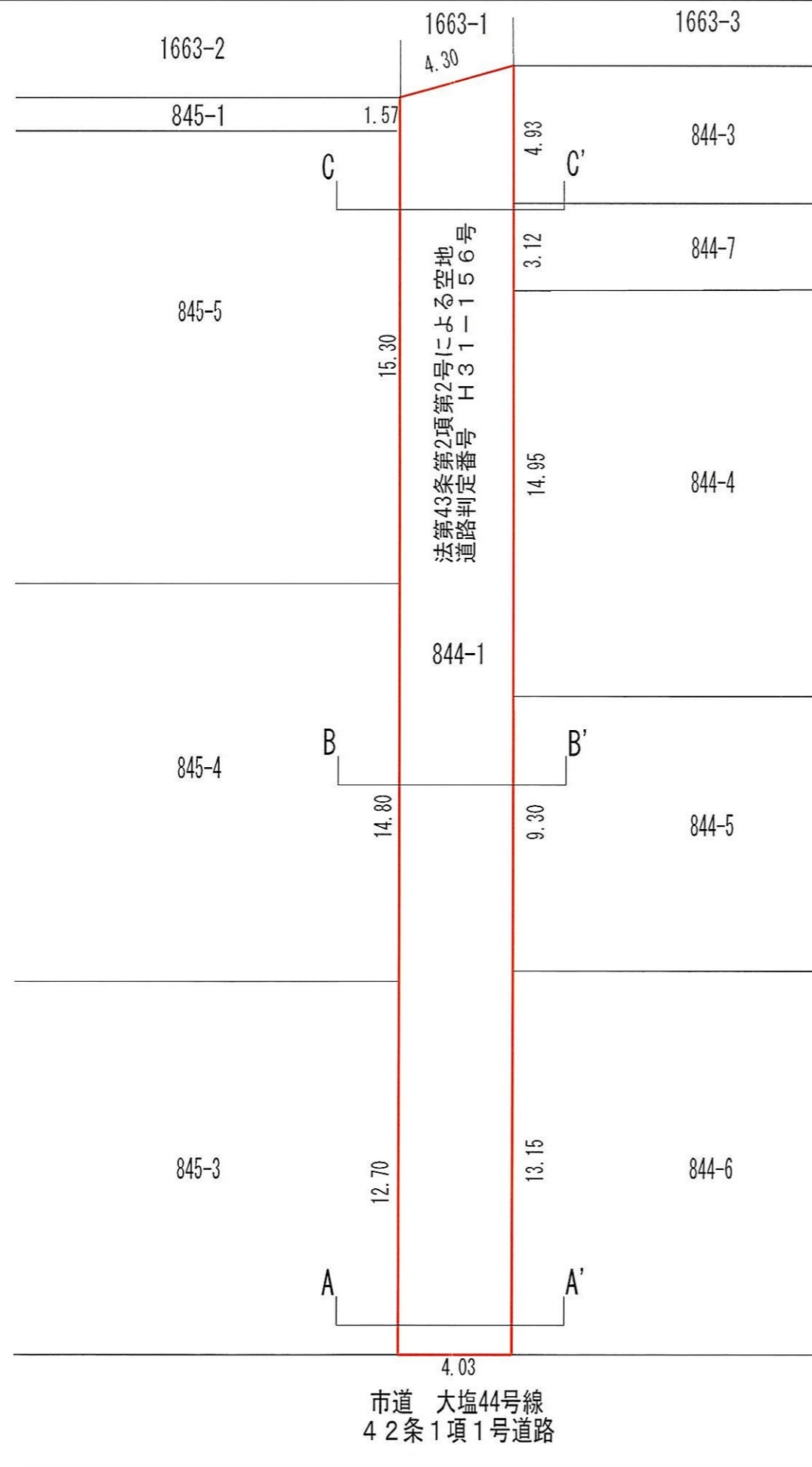

通路延長 (最長) 45.45m

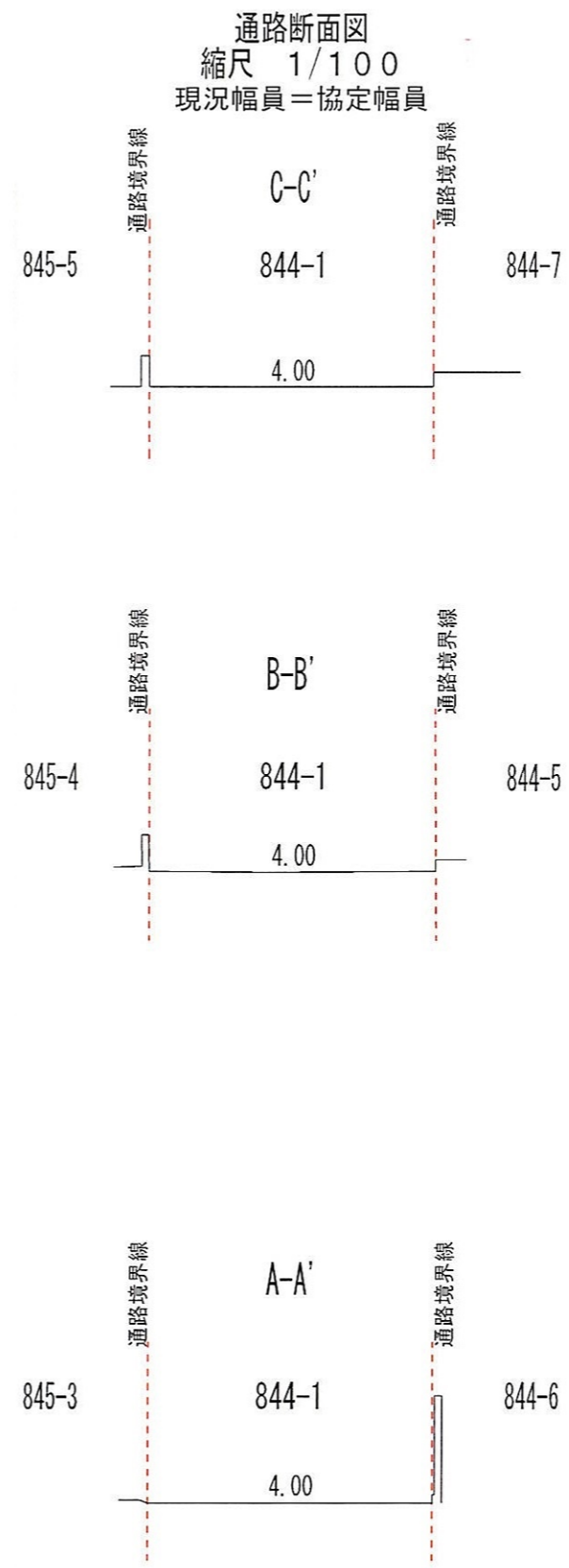



通路平面图

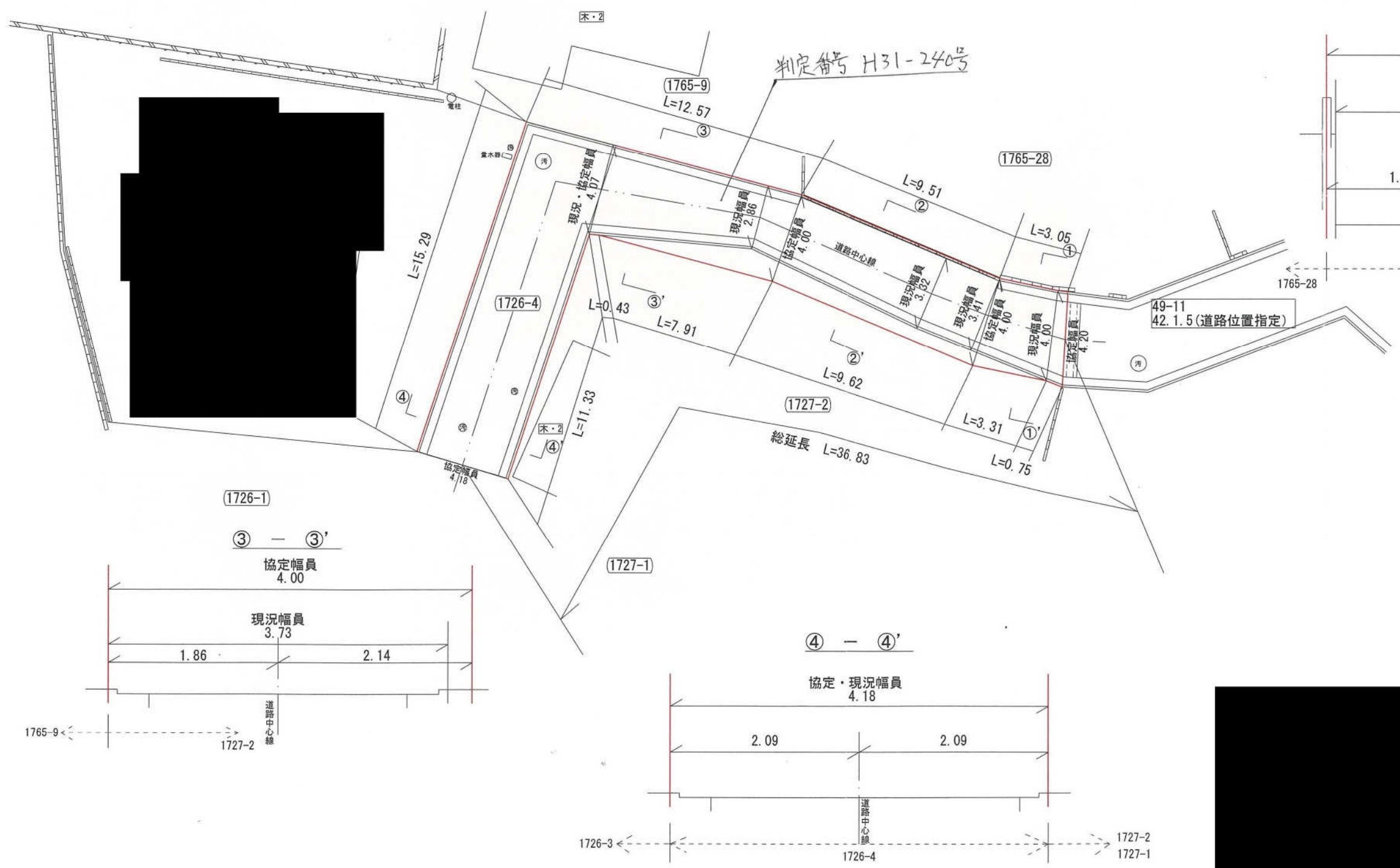

通路断面图

S=1/50

① - ①'

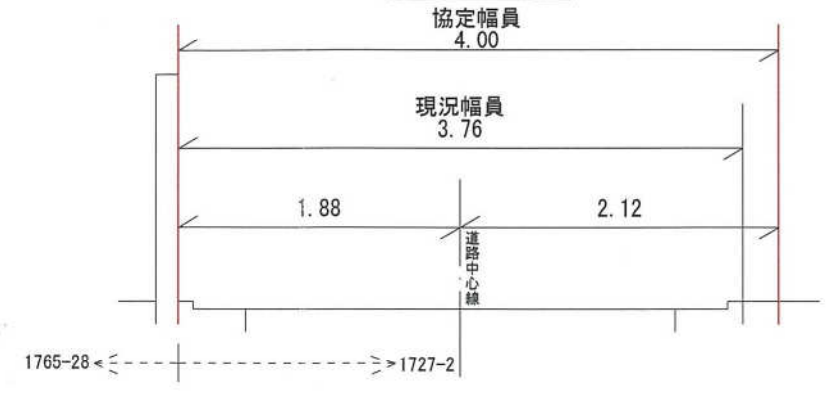

② - ②'

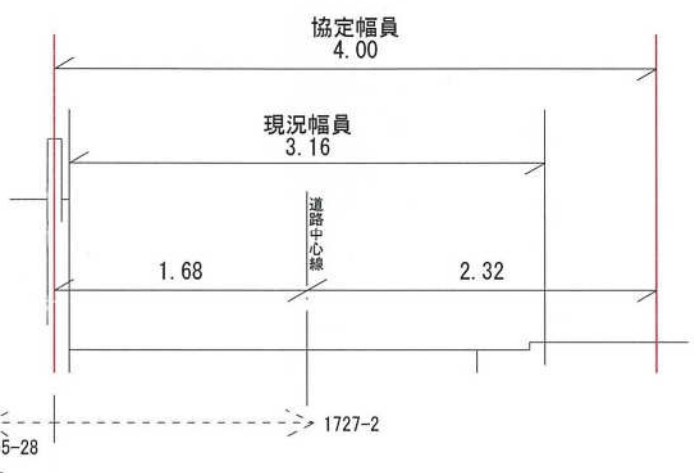

1726-1

③ - ③'

協定幅員 4.00

現況幅員 3.73

1.86 2.14

道路中心線

1765-9 1727-2

④ - ④'

協定・現況幅員 4.18

2.09 2.09

道路中心線

1726-3 1726-4 1727-2 1727-1

判定番号 H31-240号

49-11
42.1.5 (道路位置指定)